



# 2 March Cottage • Chillington



Nestled in the heart of the serene Chillington village, a hidden gem awaits – the charming 2 March Cottages. As you step inside, a warm embrace of comfort welcomes you, starting with the cozy living room adorned with a mesmerizing electric fireplace. This delightful space invites you to unwind, sink into plush cushions, and let the soothing ambiance take over.

A seamless transition leads you further, unveiling a harmonious fusion of modernity and rustic charm. The kitchen and dining area lie ahead, a true testament to thoughtful design. Recently renovated, the kitchen boasts a contemporary allure with its elegant grey wall and floor cabinets. Sunlight pours in through windows that offer enchanting views of the garden.

Convenience takes center stage as a discreet downstairs w/c adds a touch of practicality to the layout.

Ascending the staircase, the upper floor reveals its treasures – two bedrooms and a shower room, each a haven of comfort and style.



## A quirky 2 bedroom cottage located in the picturesque village of Chillington.

The first bedroom, a snug double retreat, beckons with windows that frame nature's artwork – the tranquil garden in all its splendor.

Prepare to be captivated by the master bedroom, a grand sanctuary that boasts space as its signature luxury. Bathed in sunlight from numerous windows, this room feels like a sunlit haven even on the cloudiest of days. The pièce de résistance: an inviting freestanding bath that promises indulgent relaxation. As you soak away the day's cares, the world outside gently fades into the background.

Venturing outside, a delightful surprise awaits in the form of a picturesque garden patio. In this space you will find the converted outbuilding which offers a kitchen, shower room and living area with a log burner. It's an ideal space for a guest bedroom, a tranquil retreat, or perhaps a creative hideaway.

The main cottage has great potential as the current vendor is currently using it as a holiday let. Parking is found on nearby street.



**Ground Floor**

Approx. 63.4 sq. metres (681.9 sq. feet)

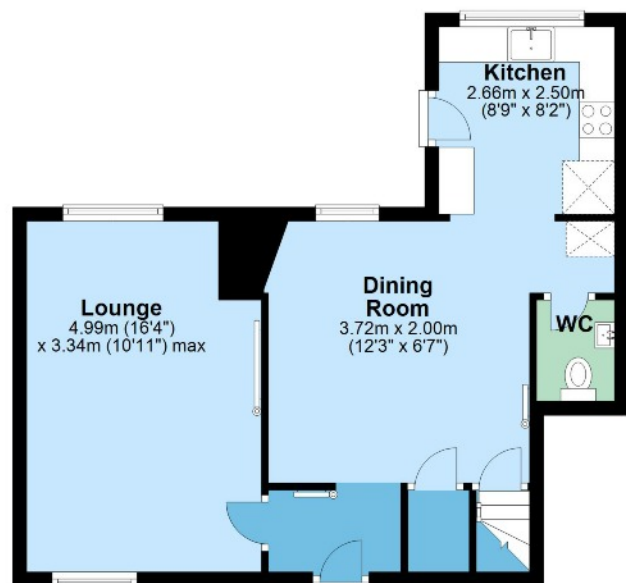
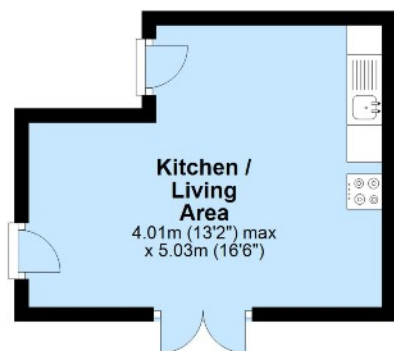

**First Floor**

Approx. 38.3 sq. metres (412.4 sq. feet)

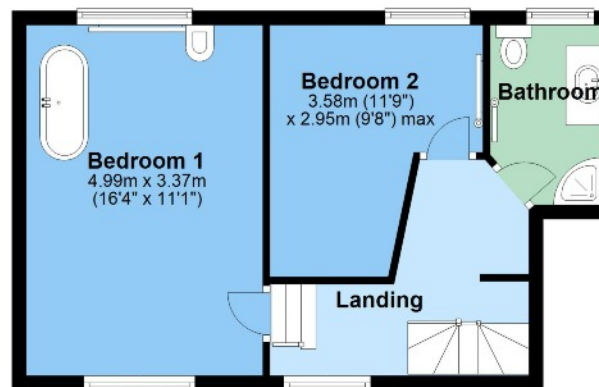

Total area: approx. 101.7 sq. metres (1094.3 sq. feet)

**IMPORTANT NOTICE:** We would like to inform prospective purchasers that these sales particulars have been prepared as a general guide only. They are prepared and issued in good faith and are intended to give a fair description of the property, but do not constitute part of an offer or contract. Any description or information given should not be relied on as a statement or representation of fact that the property or its services are in good condition. Neither Charles Head, nor any of its employees, has any authority to make or give any representation or warranty whatsoever in relation to the property. Floorplans are for guidance purposes only and may not be to scale. The photographs show only certain parts and aspects of the property at the time they were taken. Any reference to alterations to, or use of, any part of the property is not a statement that any regulations or other consent has been obtained. . If there are any important matters likely to affect your decision to buy, please contact us before viewing the property. ALL STATEMENTS CONTAINED IN THESE PARTICULARS AS TO THIS PROPERTY ARE MADE WITHOUT RESPONSIBILITY ON THE PART OF CHARLES HEAD.

**Tenure: Freehold**

**Council Tax Band: B**

**Local Authority: South Hams District Council**

**Services: Mains electricity, water and drainage. Oil fired central heating.**

**Directions: From our Kingsbridge office, take the A379 towards Dartmouth. Follow the main road through Chillington, passing the Bear and Blacksmith pub which is situated along the main road. Follow the road through the village and the property is located on the right after the post office.**

**Viewing's: Very strictly by appointment only.**

Energy Efficiency Rating		Current	Potential
Very energy efficient - lower running costs			
(92+)	<b>A</b>		
(81-91)	<b>B</b>		<b>83</b>
(69-80)	<b>C</b>		
(55-68)	<b>D</b>		
(39-54)	<b>E</b>	<b>53</b>	
(21-38)	<b>F</b>		
(1-20)	<b>G</b>		
Not energy efficient - higher running costs			
<b>England &amp; Wales</b>		EU Directive 2002/91/EC	
WWW.EPC4U.COM			