











A unique and charming split level period home. Denmark House formerly an old village store is now renovated to a high standard and contemporary finish throughout. The accommodation comprises: entrance area, living room with tall ceilings, utility space and WC. First floor: kitchen/dining room and living area with bifold doors leading to the garden. Over the second and third floors are three bedrooms and two en suites. Outside: a traditional frontage, driveway for one vehicle with EV point and delightful enclosed garden for entertaining with Hot Springs Freshwater Spa. Garden studio for home office or gym and . EPC RATING = F

**Guide Price £430,000**

**Tenure** Freehold

**Property Type** Detached House

**Receptions** 2

**Bedrooms** 3

**Bathrooms** 2

**Parking** Parking and EV point

**Heating** Oil

**EPC Rating** F

**Council Tax** Band E  
Shepway District Council





**Situation**

The property is situated on 'High Street' in the village of Elham which is set deep in the heart of the North Downs, within the Kent Downs Area of Outstanding Natural Beauty and in the centre of the Elham Valley. The property is ideally located for amenities and having nearby access for superb country walks. Elham offers amenities including a highly regarded primary school, doctor's surgery, two churches, village hall, village store, public house with accommodation and the public house in the ancient square which has been refurbished and reopened to the public. In the nearby town of Folkestone there are mainline railway stations with high Speed service to London Stratford and St Pancras stations with an approx. journey time of 53 minutes. Close to the M20 and Channel Tunnel. Regular bus services to Canterbury and Folkestone via surrounding villages.

**The accommodation comprises**

**Ground floor**

**Entrance door with frosted glazed panels opening to:**  
**Entrance area**

**Living room**  
13' 5" x 12' 9" (4.09m x 3.89m)

**Utility space/WC**  
This space has restricted head height







## First floor

### Landing

### Kitchen/dining/family room

26' 1" x 12' 3" (7.95m x 3.73m)

## Second floor

### Landing

### Master bedroom

13' 5" x 11' 0" (4.09m x 3.35m)

### En suite shower room/WC

### Bedroom three

9' 1" x 7' 5" (2.77m x 2.26m)

## Third floor

### Bedroom two

10' 11" x 8' 1" (3.33m x 2.46m)

### En suite bathroom

## Outside

### Frontage

### Driveway

Parking for one vehicle. EV point

### Rear garden

A tranquil, secluded, landscaped garden with decking area and steps to an artificial lawn. Hot Springs Freshwater Spa.

### Garden studio

11' 6" x 7' 6" (3.51m x 2.29m) Ideal home office or garden room











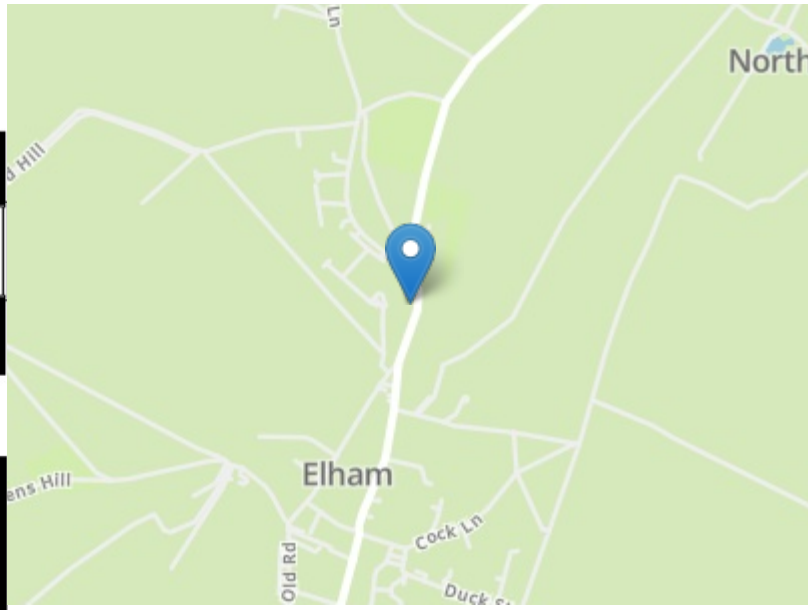
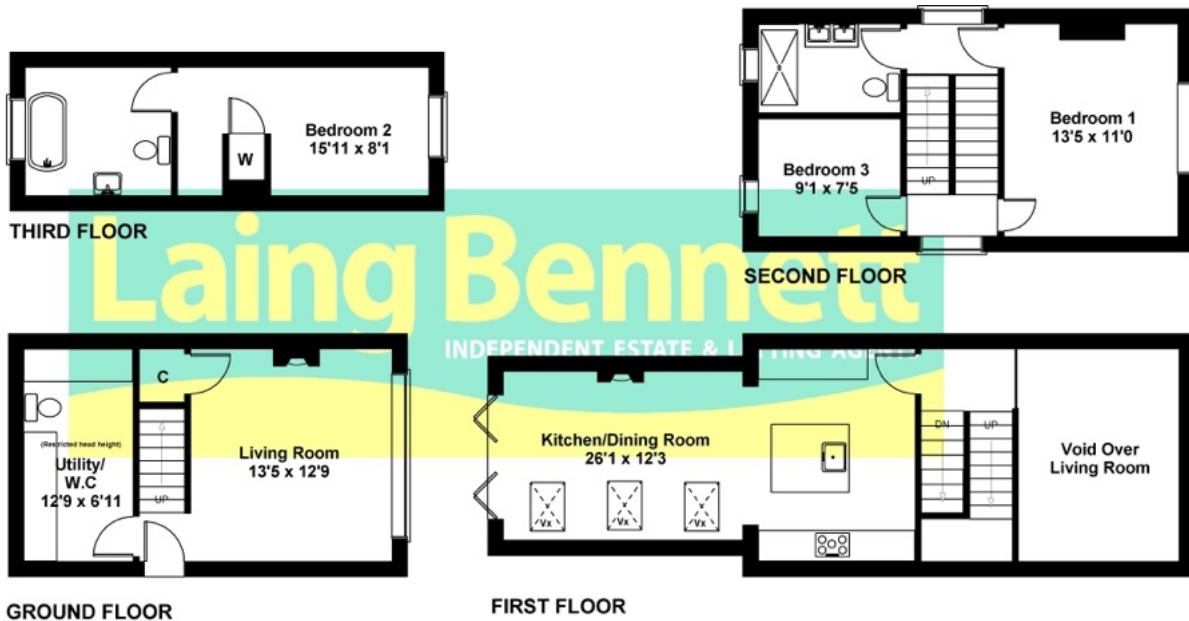

Need to book a viewing?

If you would like to book a viewing please contact our office on 01303 863393 or email [sales@laingbennett.co.uk](mailto:sales@laingbennett.co.uk)

SKETCH PLAN FOR ILLUSTRATIVE PURPOSES ONLY  
All measurements walls, doors, windows, fittings and appliances, their sizes and locations, are approximate only. They cannot be regarded as being a representation by the seller, nor their agent.  
Produced by Potterplans Ltd. 2017

See all our properties at

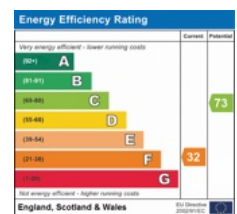

[www.laingbennett.co.uk](http://www.laingbennett.co.uk)

The Estate Office  
8 Station Road  
Lyminge  
Folkestone  
Kent  
CT18 8HP



These property details are intended to give a fair description and give guidance to prospective Purchaser/Tenant. They do not constitute an offer or contract of Sale/Tenancy and all measurements are approximate. While every care has been taken in the preparation of these details neither Laing Bennett Ltd nor the Vendor/ Landlord accept any liability for any statement contained herein. Laing Bennett Ltd has not tested any services, appliances, equipment or facilities, and nothing in these details should be deemed to be a statement that they are in good working order or that the property is in good structural condition or otherwise. We advise all applicants to commission the appropriate investigations before Exchange of Contracts/entering into a Tenancy Agreement. It should not be assumed that any contents/furnishing, furniture etc. photographed are included in the Sale/Tenancy, nor that the property remains as displayed in the photographs. No person in the employment of Laing Bennett Ltd has authority to make or give any representation or warranty whatever in relation to this property.