



7 Woodfield Road, Braintree, Essex. CM7 3HZ.

Michaels Property Consultants are pleased to present to the market this beautifully presented and character filled three-bedroom Victorian home fortunately positioned within the highly sought-after Woodfield Road. New to the market and offered for sale in excellent decorative order throughout, we feel this handsome, bay-fronted home lends itself well to a buyer seeking a property with a tasteful blend of both old and new finishing touches. The impressive internal accommodation comprises an entrance hall that provides access to the first floor, a generous 25' kitchen/diner, a fitted & well-equipped kitchen/diner, a cloakroom, a study, three generous bedrooms, and a family bathroom.

- 3/4 Bedroom Period Home
- Sought After Road Within Braintree
- Short Walk To Town & Station
- Beautifully Presented With Period Features Throughout
- Fully Converted Basement
- Garage & Off Road Parking
- Generous Kitchen/Diner
- Study
- Lounge/Diner With Feature Bay Window
- Ground Floor Cloakroom



Property Details.

Entrance Hall

Living room



25' 0" x 12' 0" MAX (7.62m x 3.66m)

Converted Basement



15' 4" x 13' 5" (4.67m x 4.09m)

Kitchen/Diner



16' 2" x 15' 6" (4.93m x 4.72m)

Bedroom One



15' 4" x 13' 5" (4.67m x 4.09m)

Inner Lobby

Ground Floor Cloakroom

Study/Office

9' 1" x 6' 5" (2.77m x 1.96m)

Property Details.

Bedroom Two



13' 4" x 10' 0" (4.06m x 3.05m)

Enclosed Rear Garden



Garage & Driveway Parking

Bedroom Three



9' 0" x 8' 4" (2.74m x 2.54m)

Family Bathroom



Property Details.

Floorplans

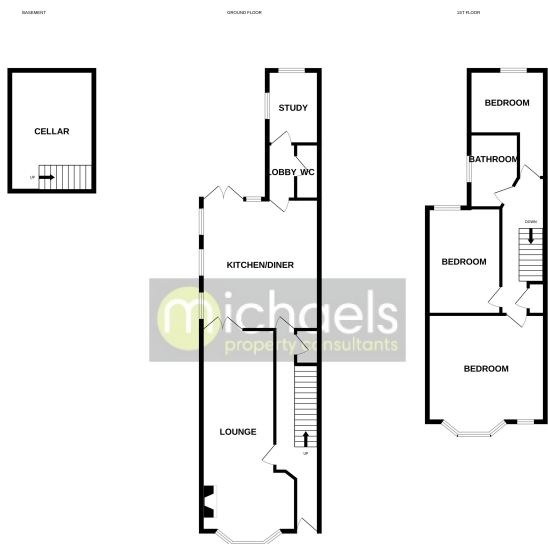

While every effort has been made to ensure the accuracy of the floorplans, measurements and details, the purchaser is advised to verify the accuracy of the floorplans, measurements and details of the property prior to purchase. The services, appliances and appliances shown here are based on the current plans and are not guaranteed. The purchaser is advised to verify the accuracy of the floorplans, measurements and details of the property prior to purchase.

Location

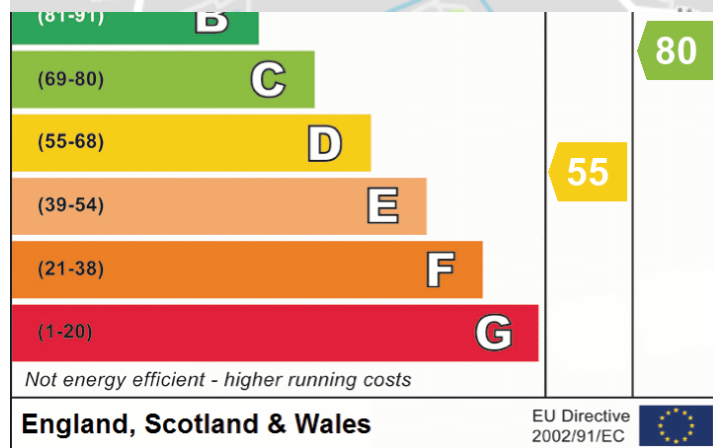
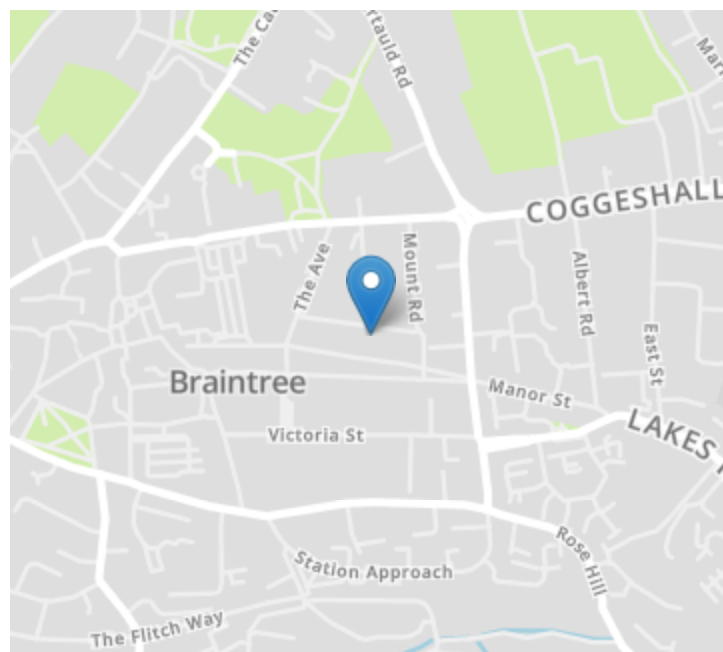

We have not carried out a structural survey and the services, appliances and specific fittings have not been tested. All photographs, measurements, floor plans and distances referred to are given as a guide only and should not be relied upon for the purchase of carpets or any other fixtures or fittings. Gardens, roof terraces, balconies and communal gardens as well as tenure and lease details cannot have their accuracy guaranteed for intending purchasers. Lease details, service ground rent (where applicable) are given as a guide only and should be checked and confirmed by your solicitor prior to exchange of contracts.