

Newton Lodge, West Parkside, London, SE10 0BA

£1,625 PCM

Located on the second floor and flooded with natural light, a spacious two bedroomed apartment which is situated within a modern development overlooking Canary Wharf. The apartment further features private balcony, 24 hour concierge and excellent transport links. Offered furnished and available 10th December

Viewing by appointment with 1st avenue.

Call: 020 8293 8600

1st avenue, 128 Metcalfe Court, West Parkside, London SE10 0EL
email: info@1stavenue.co.uk

Newton Lodge, West Parkside, £1,625 PCM London, SE10 0BA

1stavenue
Real Estate Services

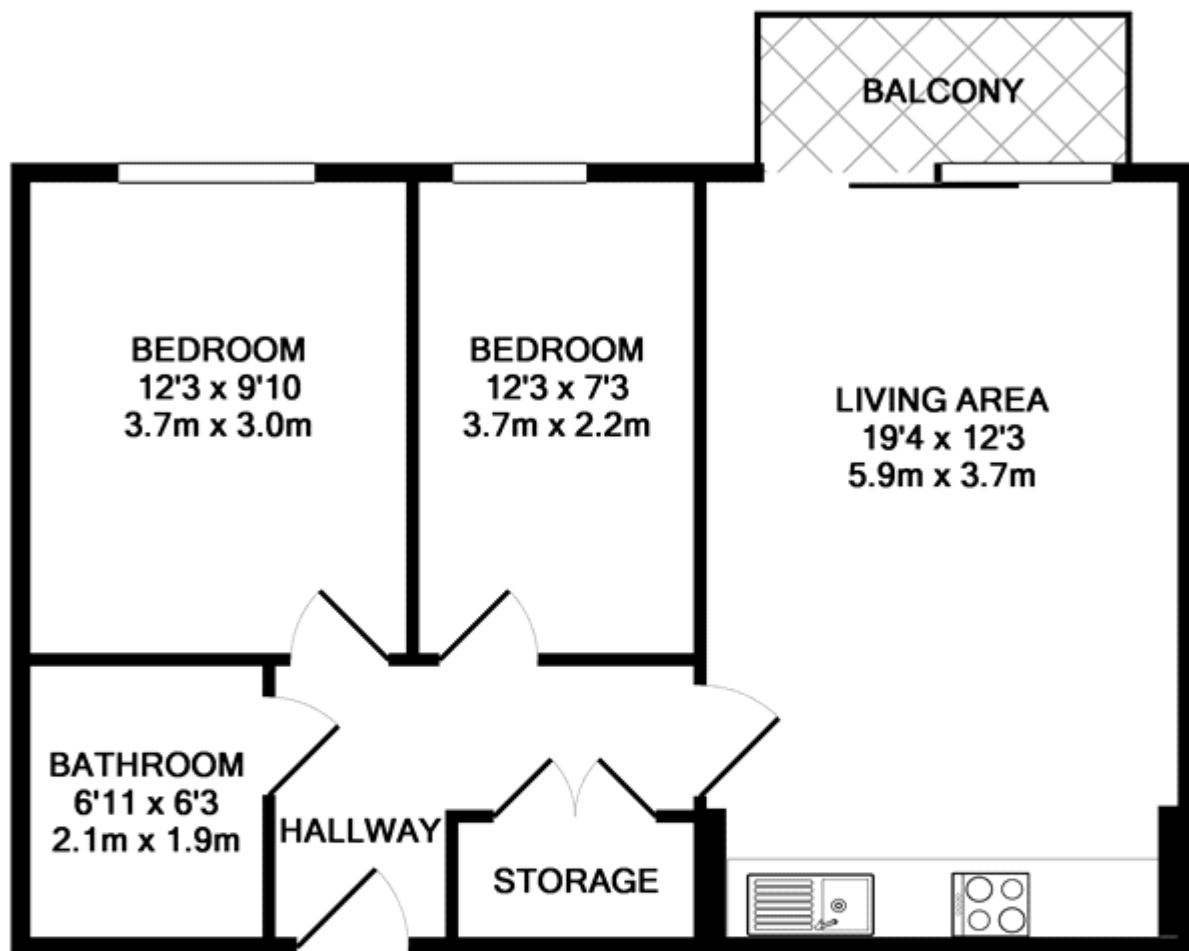

TOTAL APPROX. FLOOR AREA 565 SQ.FT. (52.5 SQ.M.)

Whilst every attempt has been made to ensure the accuracy of the floor plan contained here, measurements of doors, windows, rooms and any other items are approximate and no responsibility is taken for any error, omission, or mis-statement. This plan is for illustrative purposes only and should be used as such by any prospective purchaser. The services, systems and appliances shown have not been tested and no guarantee as to their operability or efficiency can be given

Made with Metropix ©2015

Viewing by appointment with 1st avenue.

Call: 020 8293 8600

1st avenue, 128 Metcalfe Court, West Parkside, London SE10 0EL
email: info@1stavenue.co.uk

1stavenue
Real Estate Services

