



Pepper Court, Baldock, Hertfordshire. SG7 6BH





2 Bedroom Apartment £280,000 Leasehold

Beautifully presented first floor apartment consisting of, two double bedrooms, principal bedroom with en-suite. Allocated parking. Centrally located within strolling distance to Baldock High Street and train station. This property offers itself as chain free and is perfect for an investment or first time buy.



- Central location
- Personal front door
- Two double bedrooms
- Chain free
- Allocated parking
- First floor apartment
- Principle bedroom with en-suite
- EPC rating D. Council tax band B

Ground Floor:**Entrance:**

Personal front door.

Stairs rising to first floor.

First Floor:**Kitchen:**

Abt. 11' 0" x 7' 5" (3.35m x 2.26m) Range of wall and base units with stainless steel sink and drainer. Integrated oven and hob, fridge/freezer, dishwasher, washing machine and microwave. Extractor fan. Double glazed window to front aspect.

Lounge:

Abt. 14' 9" x 15' 0" (4.50m x 4.57m) Double glazed window to rear aspect. Fitted carpet. Radiator.

Bedroom One:

Abt. 13' 0" x 9' 0" (3.96m x 2.74m) Double glazed window to rear aspect. Fitted carpet. Radiator. Door to en-suite shower room.

En-Suite Shower Room:

Suite comprising walk-in shower, wash hand basin and low level WC.

Bedroom Two:

Abt. 11' 5" x 9' 5" (3.48m x 2.87m) Double glazed window to front aspect. Fitted carpet. Radiator.

Bathroom:

Tiled bathroom with suite comprising panelled bath with overhead shower attachment, low level flush WC and hand wash basin. Heated towel rail.

Outside:**Parking:**

One allocated parking space.

Additional Information:**Agents Note:**

Draft details yet to be approved by the vendor and may be subject to change.



These particulars are a guide only and do not constitute an offer or a contract. The floor plan is for identification purposes only and not to scale. All measurements are approximate and should not be relied upon if ordering furniture, white goods and flooring etc. We have presented the property as we feel fairly describes it but before arranging a viewing or deciding to buy, should there be anything specific you would like to know about the property please enquire. Satchells have not tested any of the appliances or carried out any form of survey and advise you to carry out your own investigations on the state, condition, structure, services, title, tenure, and council tax band of the property. Some images may have been enhanced and the contents shown may not be included in the sale. Satchells routinely refer to 3rd party services for which we receive an income from their fee. If you would like us to refer you to one of these services please ask one of our staff who will pass your details on. We advise you check the availability of the property on the day of your viewing.

First Floor

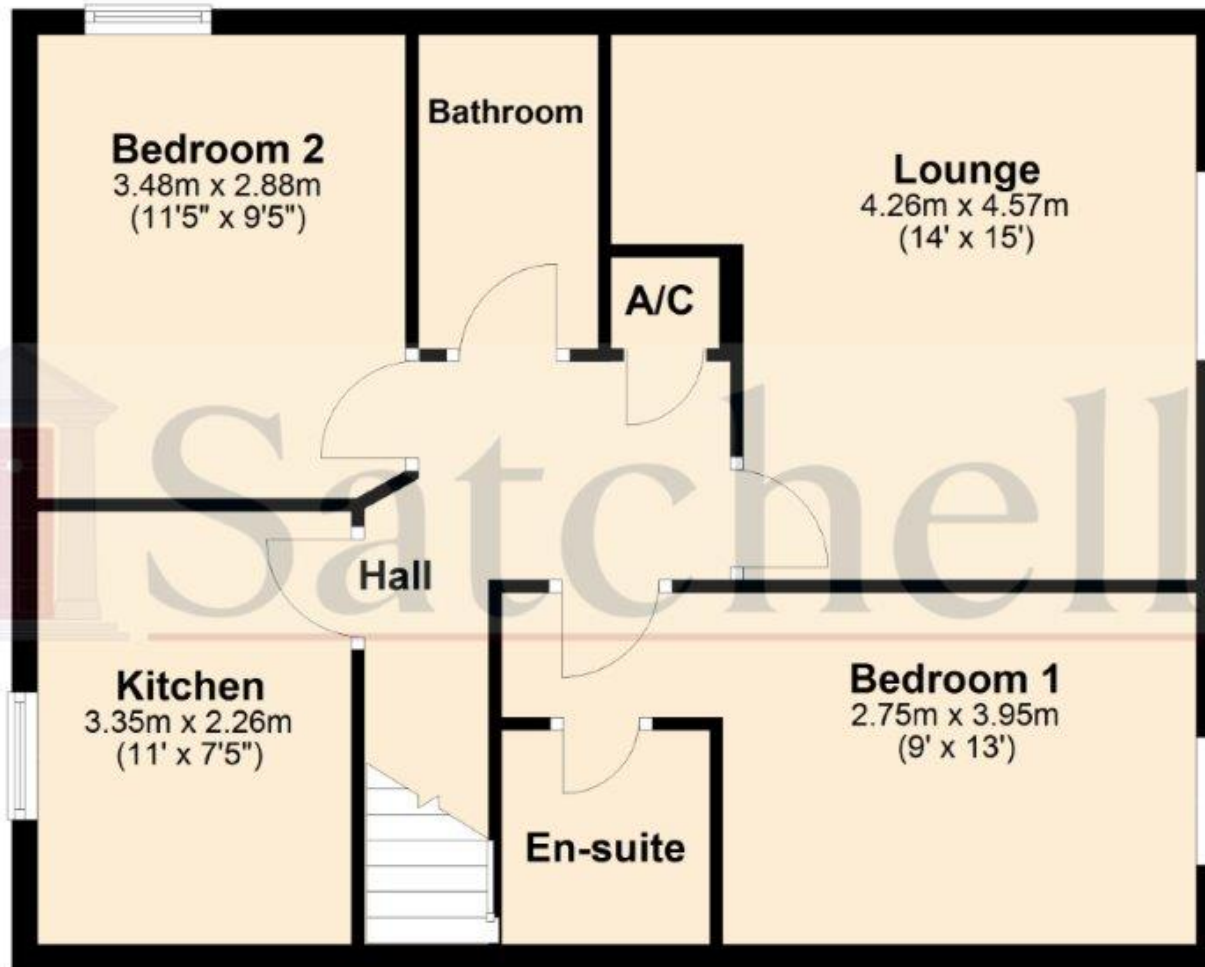

For illustrative purposes only - NOT TO SCALE - Measurements shown are approximate.
The size and position of doors, windows, appliances and other features are approximate.

Plan produced using PlanUp.