

FOR SALE

£300,000 Freehold



Augustus Gate, Stevenage, Hertfordshire. SG2 7QY

- TWO BEDROOMS
- CHAIN FREE
- GARAGE
- FITTED KITCHEN
- CHELLS MANOR LOCATION
- LOUNGE/DINER
- WALKING DISTANCE TO AMENITIES
- WALKING DISTANCE TO EXCELLENT SCHOOLS



PROPERTY DESCRIPTION

GUIDE PRICE £300,000 - £325,000

Being sold Chain free, this two bedroom terraced home located in the popular Chells Manor Area of Stevenage. The property comprises of entrance hallway, lounge, kitchen, two bedrooms and family bathroom. With a low maintenance rear garden with a garage and parking in front.

Augustus Gate is close to lots of local amenities including:

Manor House Doctors surgery 0.1 Miles

Box wood 0.2 Miles

Serpentine and Thirlmere Woods 0.4 Miles

local shop 0.5 Miles

Budgens convenience store 0.5 Miles

Martins Wood Primary School 0.5 Miles

Nobel Secondary School 0.5 Mile



ROOM DESCRIPTIONS

ENTRANCE HALL

1.10m x 1.91m (3' 7" x 6' 3")

KITCHEN

2.32m x 2.60m (7' 7" x 8' 6")

LOUNGE

3.57m x 4.56m (11' 9" x 15' 0")

FIRST FLOOR

MASTER BEDROOM

3.57m x 3.61m (11' 9" x 11' 10")

BEDROOM TWO

1.75m x 3.61m (5' 9" x 11' 10")

BATHROOM

1.74m x 2.63m (5' 9" x 8' 8")

REAR GARDEN

GARAGE



FLOORPLAN

KALM
- ESTATE AGENTS -

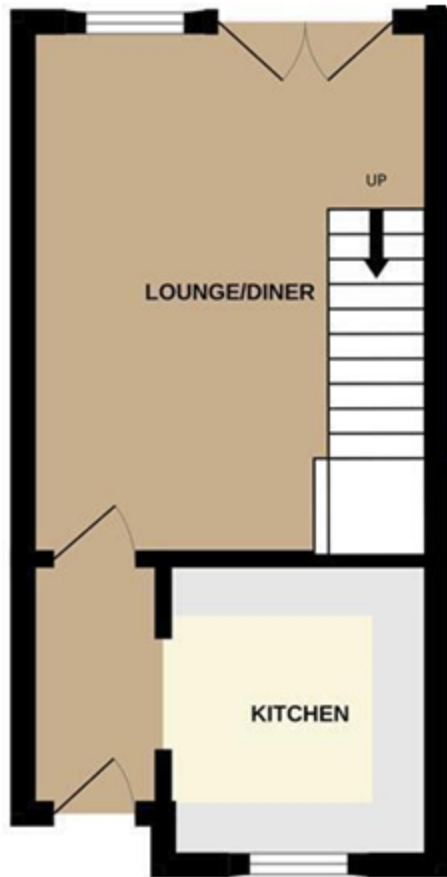

Stevenage
29, Shephall Green, Stevenage, SG2 9XS
01438 572020
linzi.davis@kalmestateagents.co.uk