

Truuli



Clover Lodge, Talbot Close, Mitcham, Surrey, CR4 1FE

£300,000 Leasehold

- Open plan integrated kitchen and living area
- Allocated parking
- Local shop on the complex
- Views over looking the common
- South facing balcony
- Close to local amenities

2, Lansdowne Road, Croydon, Croydon, CR9 2ER

Tel: 0330 043 0002

Email: save@truuli.co.uk Web: www.truuli.co.uk

Clover Lodge, Talbot Close, Mitcham, Surrey, CR4 1FE

£300,000 Leasehold

*** Vendors comments *** "When searching for a flat in 2012, we were immediately delighted with the large, airy rooms here and with the lovely views across the trees from the windows and the south-facing balcony.

There is plenty of relaxing living space, with a convenient working kitchen and everything to hand. The desk corner is a bright and cheerful spot, overlooking the common, with a feeling of being miles from any city."

Second Floor
501 sq.ft. (46.5 sq.m.) approx.

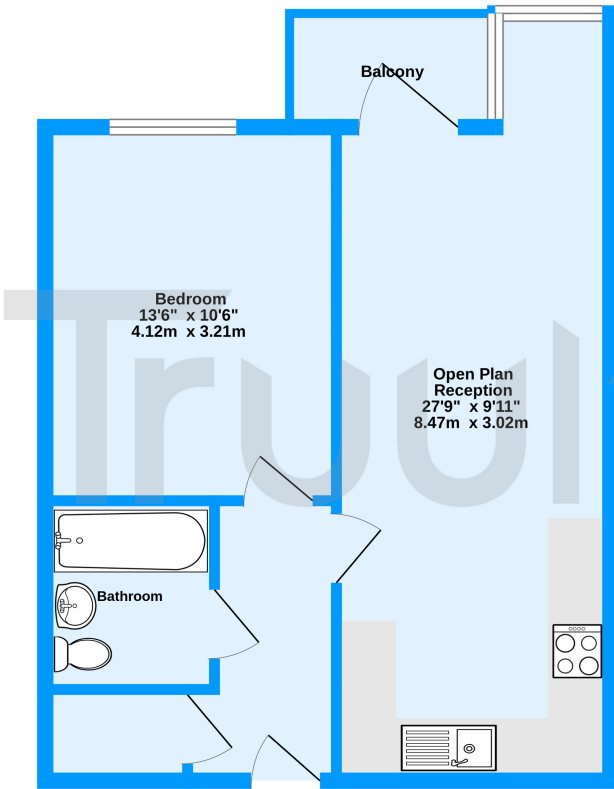

Clover Lodge, Talbot Close, Mitcham, CR4
TOTAL FLOOR AREA: 501 sq.ft. (46.5 sq.m.) approx.
Measurements are approximate. Not to scale. Illustrative purposes only
Made with Metroplan ©2024

Energy Efficiency Rating		Current	Potential
Very energy efficient - lower running costs			
(92+)	A		
(81-91)	B	83	83
(69-80)	C		
(55-68)	D		
(39-54)	E		
(21-38)	F		
(1-20)	G		
Not energy efficient - higher running costs			
England, Scotland & Wales		EU Directive 2002/91/EC	

