



21 Cairn Terrace

Galston, KA4 8QF

Offers Over £159,995

GREIG
Residential

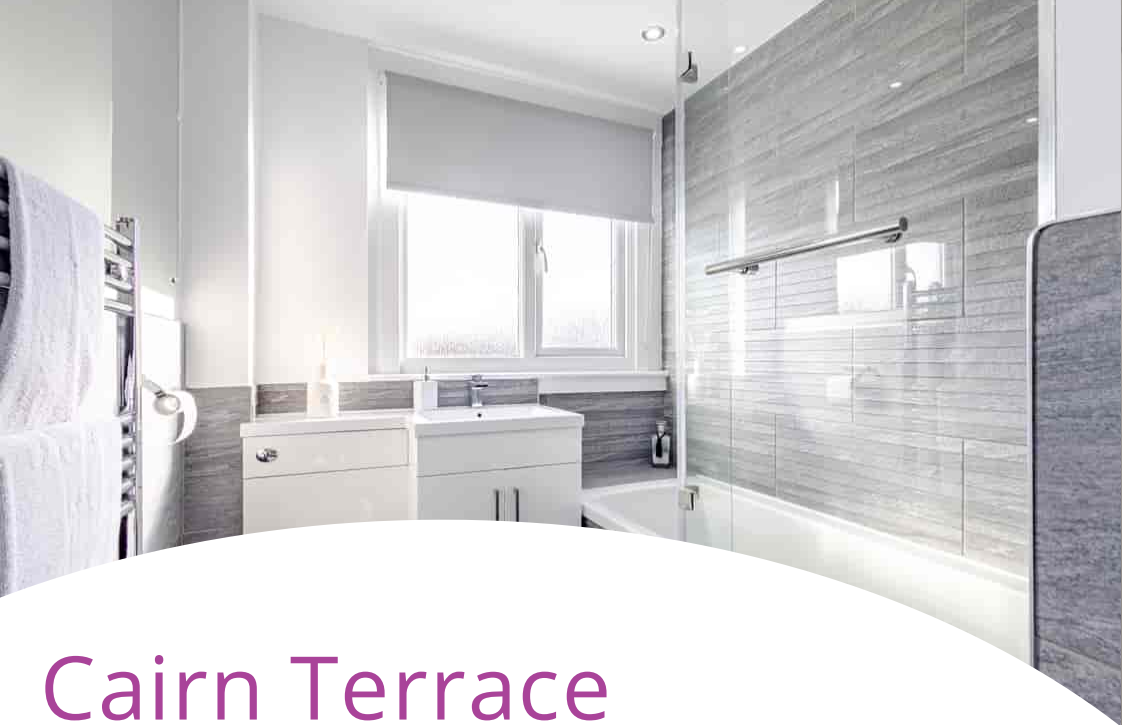

Cairn Terrace

Galston, KA4 8QF

Greig Residential are delighted to present to the market this highly impressive three bedroom semi detached villa boasting true show home condition throughout having been extensively upgraded by the current owners, sat upon a preferred corner plot at the head of an idyllic cul de sac with stunning wraparound landscaped rear gardens and garage. Located in a sought after area of Galston, early viewings are advised to appreciate this beautiful family home.





Hallway

1.90m x 1.83m (6' 3" x 6' 0") With access via the white UPVC outer door, the welcoming entrance hallway offers solid oak flooring with crisp white decor, carpeted staircase to the upper level and door access to lounge.

Lounge

4.32m x 4.00m (14' 2" x 13' 1") The formal lounge is a spacious main apartment comprising of fresh white decor, solid oak flooring, ceiling spotlights, practical understairs storage cupboard and partial open plan layout to kitchen/dining. Double glazed window to the front and plentiful space for freestanding furniture.

Kitchen/Diner

3.48m x 5.01m (11' 5" x 16' 5") Impressive dining sized fitted kitchen offering a selection of modern white gloss handle less wall and base storage units with complimentary grey Silestone work surfaces. Integrated appliances including double oven/grill and microwave, induction hob, dishwasher, washing machine, fridge/freezer and wine cooler. Crisp white decor, solid oak flooring, ceiling spotlights and ample space for dining table and chairs. Double glazed windows to the side and rear, double glazed French doors leading out into the rear gardens.

Upper Landing

1.94m x 1.90m (6' 4" x 6' 3") On the upper level the hallway provides door access to all three bedrooms and bathroom, with fresh decor, fitted carpet, ceiling spotlights and double glazed window to the side with open countryside outlooks.

Bedroom One

3.46m x 2.97m (11' 4" x 9' 9") The master bedroom is a generous double offering neutral decor, fitted carpet, ceiling spotlights and double mirrored door fitted wardrobe providing storage space. Double glazed window to the rear.

Bedroom Two

4.34m x 2.97m (14' 3" x 9' 9") The second bedroom is a generous double again with soft decor, fitted carpet, ceiling spotlights and fitted mirrored door wardrobes. Front facing double glazed window.

Bedroom Three

3.34m x 2.37m (10' 11" x 7' 9") Bedroom three is front facing with a double glazed window, fresh white decor and fitted carpet, ceiling spotlights.

Bathroom

2.43m x 1.94m (8' 0" x 6' 4") Completing the accommodation is the three piece family bathroom suite comprising of wash hand basin and wc combination unit, bath with overhead mains shower. Stylish fully tiled walls and floor, ceiling spotlights, heated towel rail and double glazed opaque window to the rear.

External

With a cul de sac position, this family home boasts an excellent corner plot with private garden grounds to the front and rear. The front is laid with monobloc providing ample off street parking, leading to the detached brick build garage (5.50m x 2.68m) with up and over door access. The exceptional South East facing wraparound rear gardens have been intricately landscaped providing ease of maintenance, comprising of generous contemporary grey composite decking patio area leading up to the sizeable artificial lawn with decorative balustrade. The rear gardens are fully enclosed allowing for a safe and peaceful outdoor family space.

Council Tax

Band C

Disclaimer

THESE PARTICULARS ARE ISSUED IN GOOD FAITH BUT DO NOT CONSTITUTE REPRESENTATIONS OF FACT OR FORM PART OF ANY OFFER OR CONTRACT. THE MATTERS REFERRED TO IN THESE PARTICULARS SHOULD BE INDEPENDENTLY VERIFIED BY PROSPECTIVE BUYERS. NEITHER GREIG RESIDENTIAL NOR ANY OF ITS EMPLOYEES OR AGENTS HAS ANY AUTHORITY TO MAKE OR GIVE ANY REPRESENTATION OR WARRANTY WHATEVER IN RELATION TO THIS PROPERTY. ALL ROOM DIMENSIONS ARE AT WIDEST POINTS APPROX.

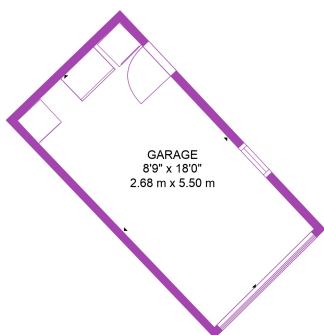

FLOOR 1

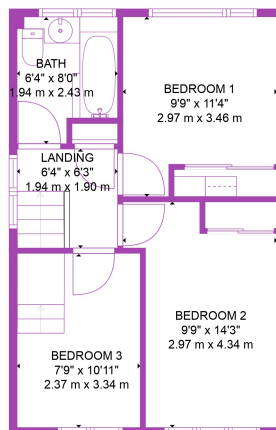
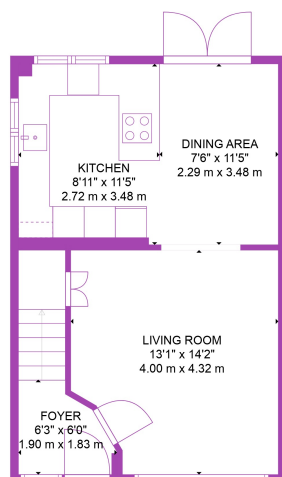

FLOOR 2



Greig Residential
18 Henrietta Street, East Ayrshire
KA4 8HQ
01563 501350
info@greigresidential.co.uk