



L'al Cottage | Sockbridge





2



1



1



 lunevalley
ESTATES.



EPC - D



B



Freehold





L'Al Cottage in Sockbridge is a charming countryside cottage built around 1760, offering a perfect blend of rustic elegance and modern comfort. This idyllic cottage boasts two cosy bedrooms, a well-appointed kitchen, and a spacious living area with a wood-burning fireplace, creating a warm and inviting atmosphere for all who enter.

Surrounded by scenic views of the Lake District and the Pennines, L'Al Cottage provides a tranquil escape from the hustle and bustle of life. Step outside onto the private patio, where you can savour your morning coffee while listening to the soothing sounds of nature.



The cottage is ideally located for outdoor enthusiasts, with numerous hiking and biking trails nearby. After a day of exploration, or just a busy day at work, return to the cottage to relax in front of the fire or dine al fresco in the garden. This picturesque getaway is a true haven for those seeking serenity in some of the most captivating scenery that Cumbria has to offer. The cottage is currently used as a highly successful holiday let and generates an impressive income for the current owners. L'al Cottage could be continued by those looking to carry on the investment or for those looking for their first home, or to downsize their living accommodation in a beautiful village setting with an amazing community.



Stepping through the front door of L'al Cottage, you are greeted by the cosiest of rooms, where the main feature is the remarkable sandstone fireplace with a modern log burner atop a sandstone hearth. After a long day exploring the Fells, kick off your muddy boots and toast your toes in front of the magnificent fireplace. The room's decor is a delightful fusion of modern and traditional, with light and bright muted tones. Laura Ashley wallpaper graces the space beneath the quaint staircase, harmonizing beautifully with the exposed sandstone walls and original beams. Stunning Cumbrian light streams in through the large window, offering a serene village view.

The kitchen is a bright space with lovely views of the patio garden, equipped with modern grey undercounter and eye-level units and a grey square tiled laminate floor. It features an integral dishwasher, an eye-level oven, and a two-ring induction hob.

The bathroom is spacious, allowing for relaxing soaks in the tub or refreshing showers in the full-sized enclosure. Bedroom One is charming with wooden lintels above the window and views of the village. Bedroom Two offers a lovely view of the patio garden and a characterful wooden beam over the bedhead nook.

The patio garden is easily accessible from the kitchen and features stone steps leading to a seating area, a shed for garden tools or a bike, and discreetly housed oil tank, all within a beautifully maintained, paved space. Access to the garden is possible via a small pathway, ensuring residents of L'al Cottage can enjoy this delightful outdoor haven.





GROUND FLOOR
337 sq.ft. (31.3 sq.m.) approx.

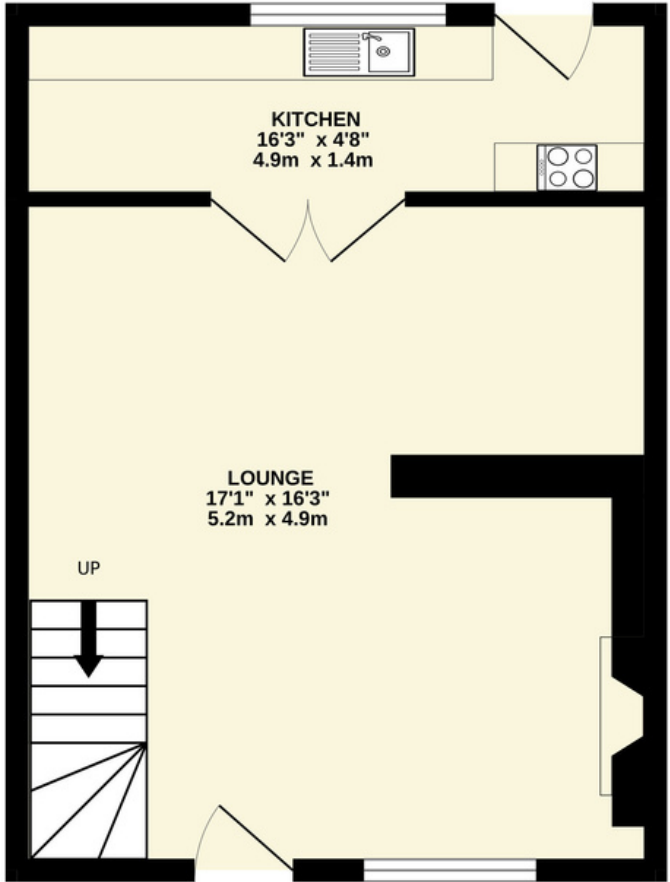

1ST FLOOR
276 sq.ft. (25.7 sq.m.) approx.

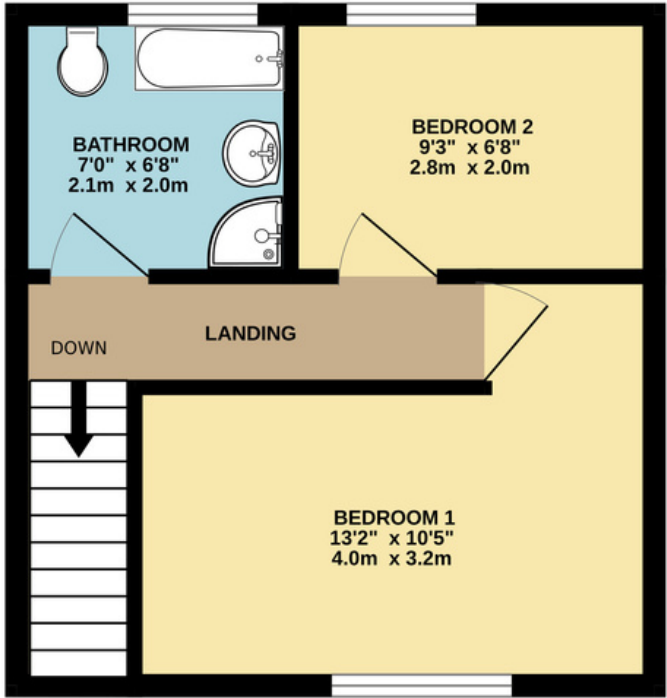

TOTAL FLOOR AREA : 613 sq.ft. (57.0 sq.m.) approx.

Whilst every attempt has been made to ensure the accuracy of the floorplan contained here, measurements of doors, windows, rooms and any other items are approximate and no responsibility is taken for any error, omission or mis-statement. This plan is for illustrative purposes only and should be used as such by any prospective purchaser. The services, systems and appliances shown have not been tested and no guarantee as to their operability or efficiency can be given.

Made with Metropix ©2023

The Essentials



Queens Head Inn
0.3 miles



Sainsburys
3.1 miles



The BeeHive Inn
2.0 miles



Well Pharmacy
2.6 miles





lunevalley

ESTATES.



Scan to visit our website!

Suite 8, Willow Mill, Caton, LA2 9RA
01524 256625
team@lunevalleyestates.com
lunevalleyestates.com