



Linden Lea, Brookfield Avenue, Ramsey, Isle of Man. IM8 2AD

Renovated detached double fronted 3 bedroom bungalow on an attractive sized plot in the centre of Ramsey, on the flat within walking distance to the town centre



£499,950

PROPERTY DESCRIPTION

Located in the picturesque area of Ramsey on the Isle of Man, Linden Lea is a charming detached 1940's bungalow that offers a peaceful and comfortable living environment with spacious flat lawned gardens to rear and either side and mature trees and bushes to front. The bungalow features 3 bedrooms with room flexibility making it ideal for a couple or or small families. While the newly added ensuite ensures convenience and privacy. Additionally, the property boasts a dressing room, allowing for ample storage space.

One of the standout features of Linden Lea is the new family kitchen, the new kitchen is perfect for preparing meals and is equipped with all the necessary appliances. There is a brand new family bath and shower room with attractive tiles and features providing modern facilities and a fresh and stylish design. The single garage offers a secure parking space, making it convenient for the new owners plus a parking space to the front of the property. Additionally, the utility room makes tasks such as laundry and storage more efficient and organized.

DISCLAIMER Whilst Manxmove Ltd believe that these details are correct, neither Manxmove Ltd or their clients guarantee their accuracy in any way. Consequently, these details are not to be used to form part of any legally binding contract. Prospective purchasers or tenants are advised to visit this property to satisfy themselves as to the correctness of these details. Please note, we use wide angle camera lenses in order to show as much of each room as possible. This is not intended to mislead any prospective purchasers or tenants in any way and an honest verbal description is always available prior to viewing if required.

Overall, Linden Lea is a wonderful period bungalow that combines traditional charm with modern updates, creating a comfortable and convenient living space in a beautiful location. The property provides all the necessary amenities for a comfortable lifestyle, from the spacious bedrooms to the newly renovated kitchen and bathrooms. With its detached structure and peaceful surroundings, this bungalow offers the perfect opportunity to enjoy a tranquil residential experience on the Isle of Man.

FEATURES

- Recently Renovated Throughout
- Detached Bungalow
- Walking Distance to Shops and Beach
- Single Garage & 2 Car Parking
- Gardens to Front & Rear
- 3 Bedrooms (1 En Suite) plus Bathroom
- No Onward Chain
- Cash/Chain Free buyers Only



Property Images



FLOORPLAN

GROUND FLOOR 1177 sq.ft. (109.4 sq.m.) approx.

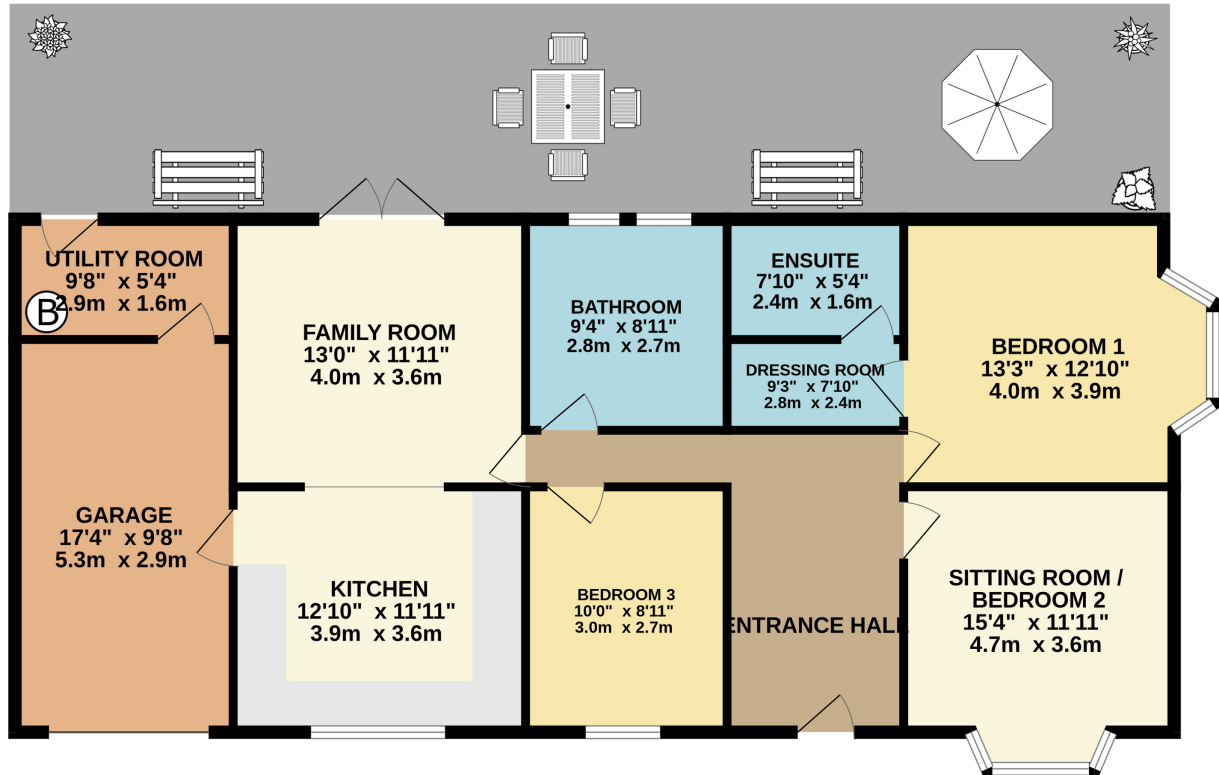

DETACHED BUNGALOW

TOTAL FLOOR AREA : 1177 sq.ft. (109.4 sq.m.) approx.

Whilst every attempt has been made to ensure the accuracy of the floorplan contained here, measurements of doors, windows, rooms and any other items are approximate and no responsibility is taken for any error, omission or mis-statement. This plan is for illustrative purposes only and should be used as such by any prospective purchaser. The services, systems and appliances shown have not been tested and no guarantee as to their operability or efficiency can be given.
Made with Metropix ©2024



DISCLAIMER: Whilst Manxmove Ltd believe that these details are correct, neither Manxmove Ltd or their clients guarantee their accuracy in any way. Consequently, these details are not to be used to form part of any legally binding contract. Prospective purchasers or tenants are advised to visit this property to satisfy themselves as to the correctness of these details. Please note, we use wide angle camera lenses in order to show as much of each room as possible. This is not intended to mislead any prospective purchasers or tenants in any way and an honest verbal description is always available prior to viewing if required.