

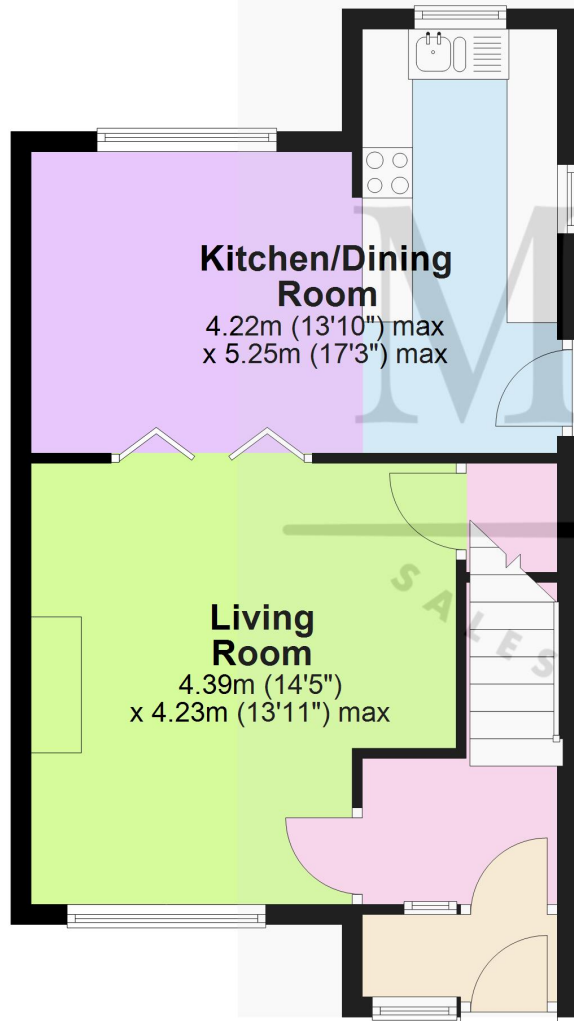

## Ground Floor

Approx. 43.8 sq. metres (471.7 sq. feet)



## First Floor

Approx. 35.2 sq. metres (378.5 sq. feet)

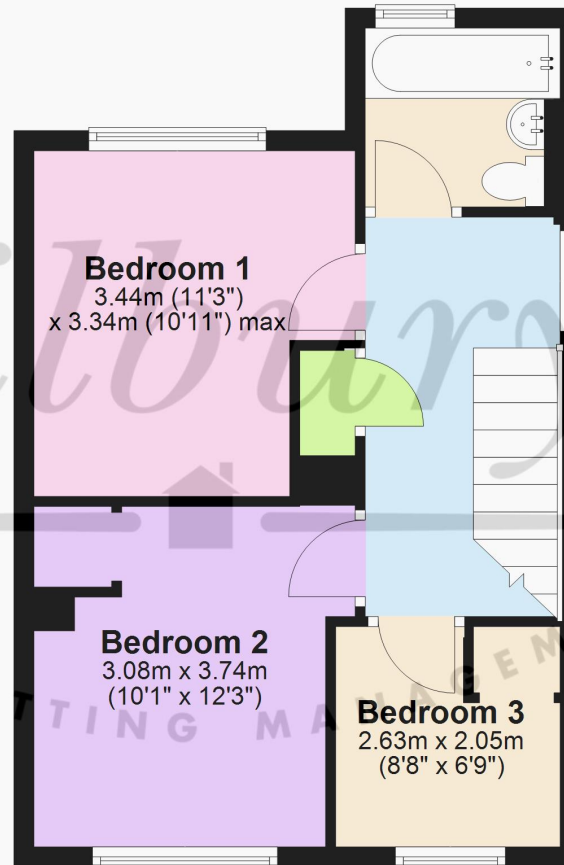

## Garage

Approx. 14.8 sq. metres (159.0 sq. feet)

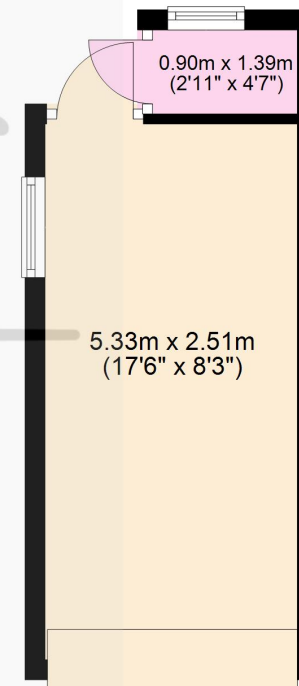

Total area: approx. 93.8 sq. metres (1009.2 sq. feet)

For Illustrative Purposes Only. Not to Scale. Plan Produced by PlanUp.  
Plan produced using PlanUp.

# 21 Wortley Terrace, Wotton-under-Edge, Gloucestershire GL12 7JY

NO ONWARD CHAIN! Built in the 1980s this wonderful semi-detached home enjoys a distinguished elevated position, set back from the road within the market town of Wotton-under-Edge. This property offers a blank canvas to deliver your own personality to. Entering through the porch, a comfortable entrance hallway provides a great flow between the ground and first floor, with great access to dart out the door on the school run! A spacious living room is situated to the left of the property. This cosy space enjoys the pleasure of a feature working woodburner to take the chill of winter evenings whilst the expansive, sunlit window allows plenty of natural lighting to gather in this space. Completing this room is an under stairs storage cupboard. Following through, the modern kitchen diner. Enjoying a pleasant view of Wotton Hill, creating the perfect and sociable space to enjoy breakfast lunch and dinner. The kitchen offers a great amount of cabinet storage, integrated appliances and solid wood work surface space- ideal for all! Engineered wooden flooring is laid throughout. Upstairs houses two double bedrooms and one single, a bathroom of a white suite and an additional landing cupboard. The second bedroom shares the amazing view of Wotton Hill, whilst the principle and third bedroom have the benefit of built in storage. Outside a patio area provides a great space to enjoy a brew and leads down to the rear garden, mainly laid with lawn, enclosed by wooden fencing. The garage is an added benefit of this property with a separate storage space, which could make for an ideal home office! This home is further enhanced with driveway parking, whilst being within walking distance to countryside, shops and the charming historic High Street, and the Cotswold Way. A perfect home whether your own or an investment offered with no onward chain.

## Situation

This charming market town enjoys a vibrant High Street with an eclectic mix of independent shops and cafes, complemented by two well-known supermarkets – it even has its own cinema! Wotton-under-Edge (M5 J14 approx 5.1 miles) is situated amidst beautiful countryside on the edge of the Cotswold escarpment – the Cotswold way runs straight through, perfect for walkers. Tetbury (approx. 10.1 miles), Cirencester, Bristol, Cheltenham make it an ideal location for families, commuters and outdoor enthusiasts. Katharine Lady Berkeley's Secondary School is an important element in the town and there are two primary schools. Please visit [wotton-under-edge.com](http://wotton-under-edge.com) for a wealth of further information.

## Property Highlights, Accommodation & Services

- Three Bedroom Semi Detached Property - Set Back From The Road
- Catchment Area for Katharine Lady Berkeley's Secondary School and Two Excellent Primary Schools
- Walking Distance to Wotton-under-Edge High Street and Shops
- Smart Kitchen With Integrated Appliances, Adjoining Dining Room
- No Onward Chain
- Living Room With Woodburner plus Doors to Dining Room/Kitchen
- Level Rear Garden , Elevated Patio Seating Area and Side Access
- Driveway Parking and Single Garage
- New Doors and Double Glazing Installed 2024
- Stroud District Council - Band C

## Directions

Travelling into Wotton-under-Edge from the direction of Hillesley, 21 Wortley Terrace can be found on your left-hand side as you drive into the outskirts of town, just before the turn to Wotton Crescent on the opposite side of the road.

## Local Authority & Council Tax - Stroud District Council - Tax Band C

IMPORTANT NOTICE Milburys Estate Agents Ltd, their clients and any joint agents give notice that they have not tested any apparatus, equipment, fixtures, fittings, heating systems, drains or services and so cannot verify they are in working order or fit for their purpose. Interested parties are advised to obtain verification from their surveyor or relevant contractor. Statements pertaining to tenure are also given in good faith and should be verified by your legal representative. Digital images may, on occasion, include the use of a wide angle lens. Please ask if you have any queries about any of the images shown, prior to viewing. Where provided, floor plans are shown purely as an indication of layout. They are not scale drawings and should not be treated as such. Complete listings and full details of all our properties (both for sale and to let) are available at [www.milburys.co.uk](http://www.milburys.co.uk)

