



Boulton Street,  
Birches Head



**OneAgency**

01782 970222

[hello@oneagencygroup.co.uk](mailto:hello@oneagencygroup.co.uk)





# £70,000

A two bedroom mid terraced house in Birches Head within walking distance to Hanley town center. The property is in need of some updating however would make a brilliant first time buy to investment opportunity. No Chain!





## Ground Floor

### Lounge / Diner

8.05m x 3.48m (26' 5" x 11' 5") A double glazed window to the front and rear, two gas fire places, radiator and carpet flooring.

### Kitchen

3.57m x 1.96m (11' 9" x 6' 5") A range of fitted wall and base units with worktops, stainless steel sink basin, oven and gas hobs with extractor over, space for a fridge/freezer, plumbing for a washing machine, radiator, double glazed window and vinyl flooring.

### Bathroom

2.06m x 1.68m (6' 9" x 5' 6") A bath with overhead shower, pedestal hand wash basin, low level w/c, radiator, double glazed window and vinyl flooring.

## First Floor

### Bedroom One

3.48m x 3.39m (11' 5" x 11' 1") A double glazed window to the front, radiator and carpet flooring.



### Bedroom Two

3.54m x 3.48m (11' 7" x 11' 5") A double glazed window to the rear, storage cupboard, radiator and carpet flooring.

### External

A paved rear yard with steps down to gated access to an alleyway.

### Agents Notes

We understand that an application for probate has been submitted but not yet granted.

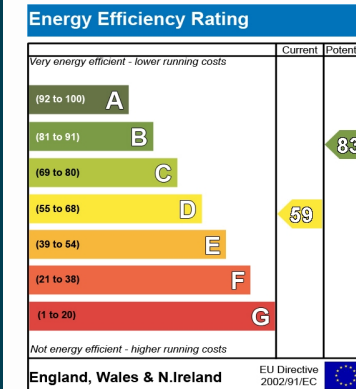
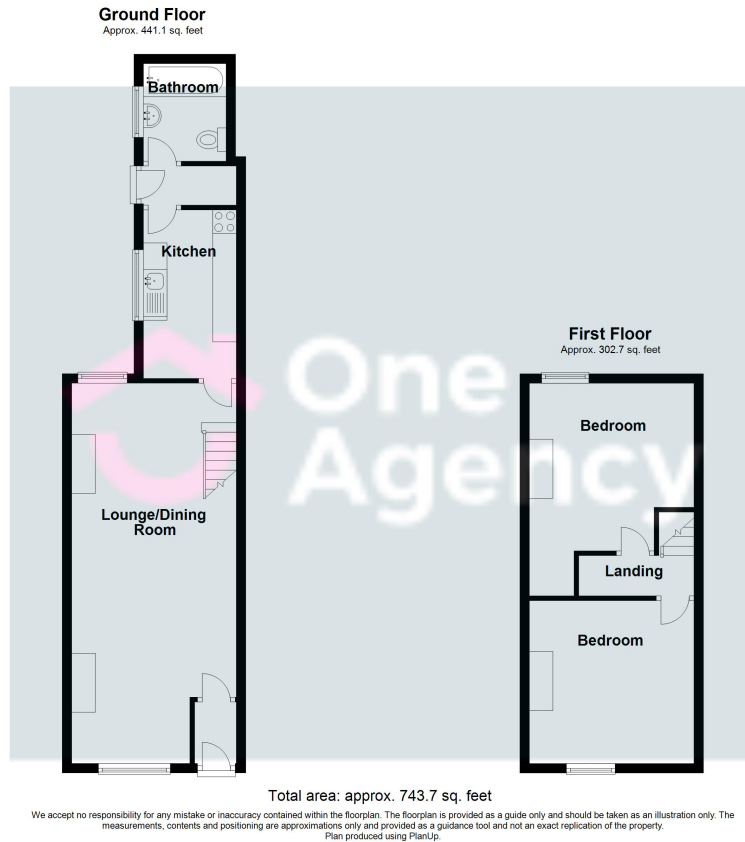

OneAgency, 9 & 10 Ridge House Drive, Festival Park, Stoke-on-Trent, ST1 5SJ

01782 970222

hello@oneagencygroup.co.uk

Every attempt has been made to ensure accuracy, however, all measurements are approximate and for illustrative purposes only. **Not to scale.**

In accordance with The Consumer Protection from Unfair Trading Regulations 2008 the following particulars have been prepared in good faith and they are not intended to constitute part of an offer or contract. We have not carried out a structural survey and the services, appliances and specific fittings have not been tested. All photographs, measurements, floor plans and distances referred to are given as a guide only and should not be relied upon for the purchase of carpets or any other fixtures and fittings. Lease details, service charges and ground rent (where applicable) are given as a guide only and should be checked and confirmed by your Solicitor prior to exchange of contracts.