



GREGORY BROWN
RESIDENTIAL SALES & LETTINGS

£265,000 Leasehold
FOR SALE



Dudley Place, Stanwell, Staines-upon-Thames, Surrey, TW19 7BG

VERY WELL PRESENTED & SPACIOUS TWO BEDROOM, TWO BATH/SHOWER ROOM APARTMENT SITUATED IN THIS SOUGHT AFTER DEVELOPMENT IDEALLY LOCATED FOR EASY ACCESS TO LOCAL MOTORWAY NETWORKS & HEATHROW AIRPORT. The property benefits from a spacious lounge/diner, modern fitted kitchen, two double bedrooms (en-suite to Bed 1), further modern white bathroom suite, residents parking and a long lease. No Onward Chain. Viewings Highly Recommended!

Gregory Brown

127a, High Street, Staines-upon-Thames, TW18 4PD

01784 451458

staines@gregory-brown.co.uk

ROOM DESCRIPTIONS

FLOORPLAN

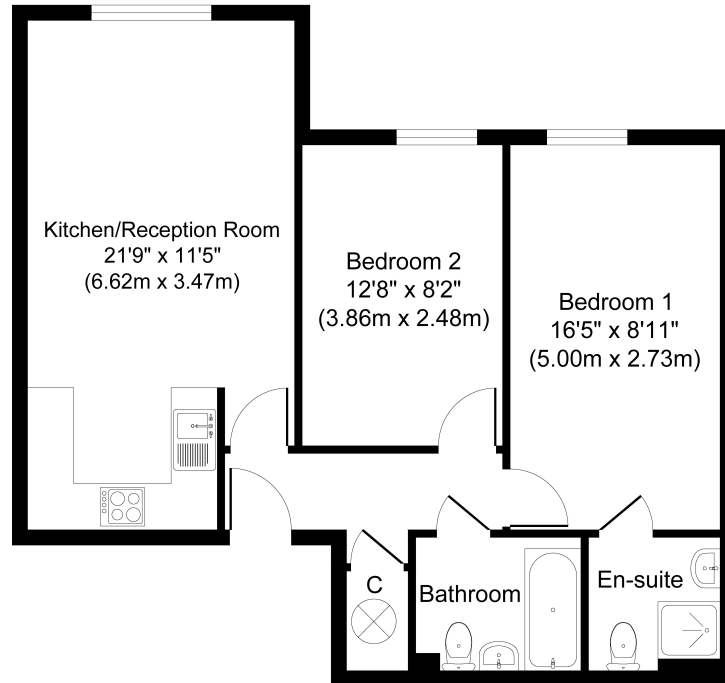

Approximate Floor Area
640 sq. ft
(59.50 sq. m)

Whilst every attempt has been made to ensure the accuracy of the floor plan contained here, measurements of doors, windows, rooms and any other items are approximate and no responsibility is taken for any error, omission, or mis-statement. The measurements should not be relied upon for valuation, transaction and/or funding purposes. This plan is for illustrative purposes only and should be used as such by any prospective purchaser or tenant. The services, systems and appliances shown have not been tested and no guarantee as to their operability or efficiency can be given.
Copyright V360 Ltd 2025 | www.houseviz.com