



**22 JUBILEE DRIVE, MARKET DEEPING
 PE6 8FR**

£298,000

FREEHOLD



**briggs
 residential**

17 Market Place
 Market Deeping
 PE6 8EA

**01778
 349300**

Follow us on



briggsresidential.co.uk

Extended to the rear offering superb ground floor accommodation, this well-kept and much improved three bedroom detached family home overlooks a large green and has a sunny enclosed landscaped rear garden. With a lounge featuring panelled walls and inglenook-style fireplace, this home benefits from a 19' kitchen/dining room which leads through to the garden room, whilst the attractive master bedroom with its panelled walls has an en-suite. With off-road parking for two cars leading to a single garage, viewing of this home is highly advised.

Front entrance door opening to

HALLWAY

With radiator, cloaks area and door to

LOUNGE 16'1 x 10'2 (4.90m x 3.10m)

An impressive room with feature inglenook-style fireplace, panelled walls with wall lighting, radiator, TV point, window to front elevation and door to

INNER HALLWAY

With radiator and stairs leading to first floor.

CLOAKROOM

A modern suite comprising low flush WC, wash-hand basin and radiator.

KITCHEN/DINING ROOM 19' x 18'8 max (5.79m x 5.69m max)

A most impressive large L-shaped room with a range of ample wall and base units with contemporary quartz work surfaces, built-in appliances, sink unit, window to rear elevation, dining area, radiator and open access through to

GARDEN ROOM 9'10 x 9'7 (3.00m x 2.92m)

This lovely room has French doors opening onto the westerly facing landscaped garden, two windows to side elevation, TV point and spotlighting.

LANDING

With built-in storage cupboard and access to part-boarded loft by built-in ladder.

BEDROOM ONE 13'9 x 9'7 (4.19m x 2.92m)

With feature panelled wall, this large master bedroom has two windows to front elevation overlooking the park and door leading to

EN-SUITE

Comprising shower cubicle, wash-hand basin, low flush WC, radiator and window to front elevation.

BEDROOM TWO 11'3 x 8'8 (3.43m x 2.64m)

With fitted wardrobes, radiator and window to rear elevation.

BEDROOM THREE 9'9 x 7'10 (2.97m x 2.39m)

Presently used as a dressing room with radiator and window to rear elevation.

BATHROOM

Comprising panelled bath, wash-hand basin, low flush WC, radiator and window to side elevation.

OUTSIDE

The property has a double-width driveway which leads to an integral garage with electric roller door.

The private south-westerly facing rear garden has been professionally landscaped and laid to lawn with patio area, paving, shrubs and well stocked borders.

EPC RATING: B

COUNCIL TAX BAND: C (SKDC)

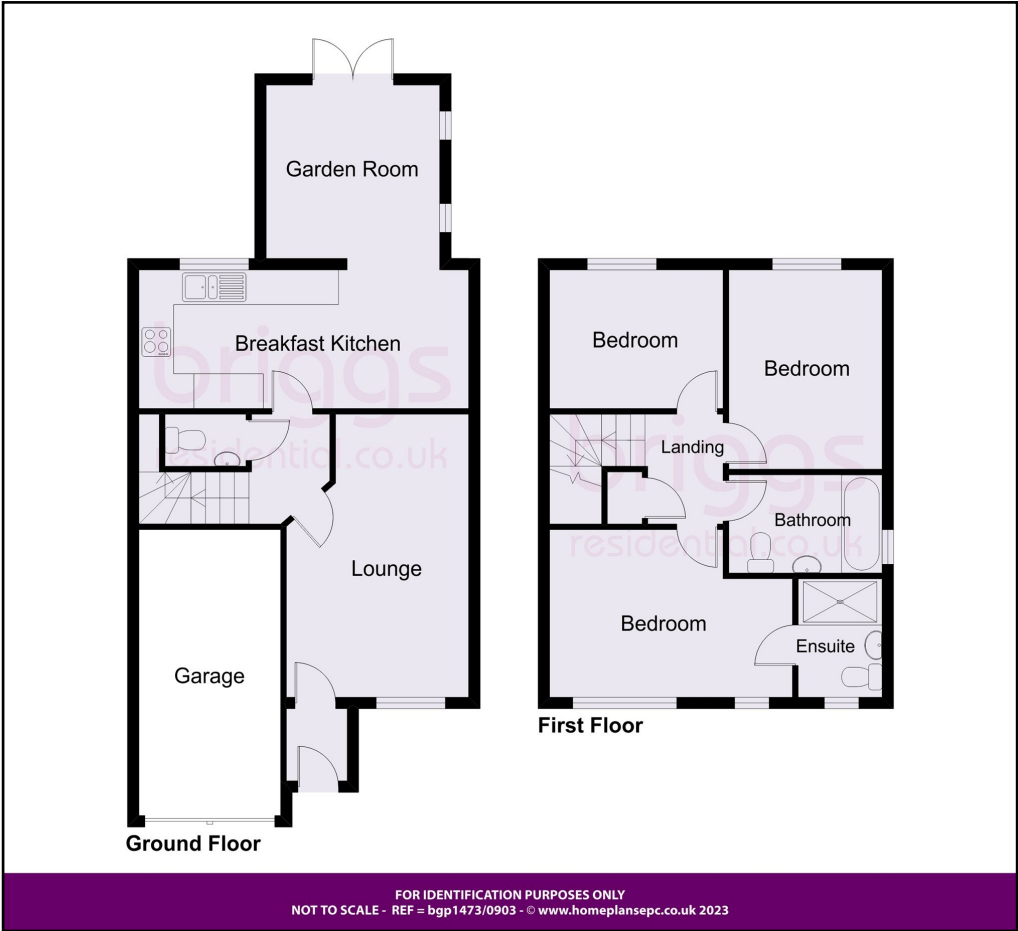

These particulars do not constitute part or all of an offer or contract. The measurements and details are supplied for guidance only and as such must be considered incorrect. Potential buyers are advised to recheck the measurements before committing to any expense. Briggs Residential have not tested any apparatus, equipment, services, fixtures or fittings and it is in the buyers interest to check the working condition of appliances. Briggs Residential have not sought to verify the legal title or structure of the property and suggest buyers obtain such verification from their solicitors.