

## High Street, Harwich

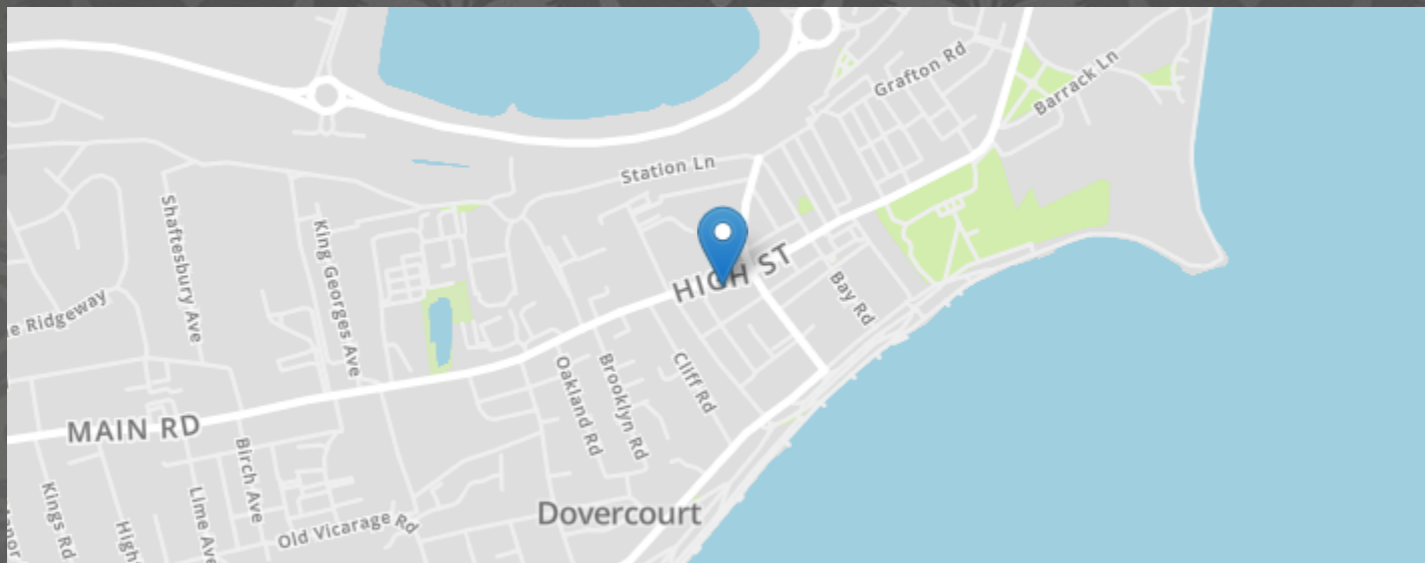

- TWO DOUBLE BEDROOMS
- CLOSE TO SCHOOLS
- FIRST FLOOR
- CHAIN FREE
- IDEAL LOCATION
- CLOSE TO BEACH
- NEW CARPETS

# MARKS & MANN

7 The Square, Martlesham Heath, Ipswich, Suffolk, IP5 3SL.

01473 396 007

contactipswich@marksandmann.co.uk

Website [www.marksandmann.co.uk](http://www.marksandmann.co.uk)

# MARKS & MANN



## High Street, Harwich

on the market for sale we have this spacious and exceptionally well presented two bedroom apartment. Positioned on Dovercourt High street the property is close to shops, restaurants and coffee shops, schools, train station, bus routes and a short few minute walk to the beach front.

This naturally bright and spacious property benefits from two double bedrooms, large living area which has recently been fitted with new carpet, kitchen, tiled bathroom and some handy storage space.

The property is being sold with the forward chain already complete and would be ideal for first time buyers, investors or a small family.

Call today to register your interest and arrange a first hand viewing.

**£127,000**



# High Street, Harwich

# High Street, Harwich

## Entrance Hall

2.067m x 6.167m (6' 9" x 20' 3") Entrance Hall

## Living room

5.667m x 4.187m (18' 7" x 13' 9") Living Room

## Kitchen

2.097m x 4.266m (6' 11" x 14' 0") Kitchen

## Bedroom

3.272m x 3.459m (10' 9" x 11' 4") Bedroom

## Bedroom

2.572m x 4.440m (8' 5" x 14' 7") Bedroom

## Bathroom

2.313m x 1.988m (7' 7" x 6' 6") Bathroom

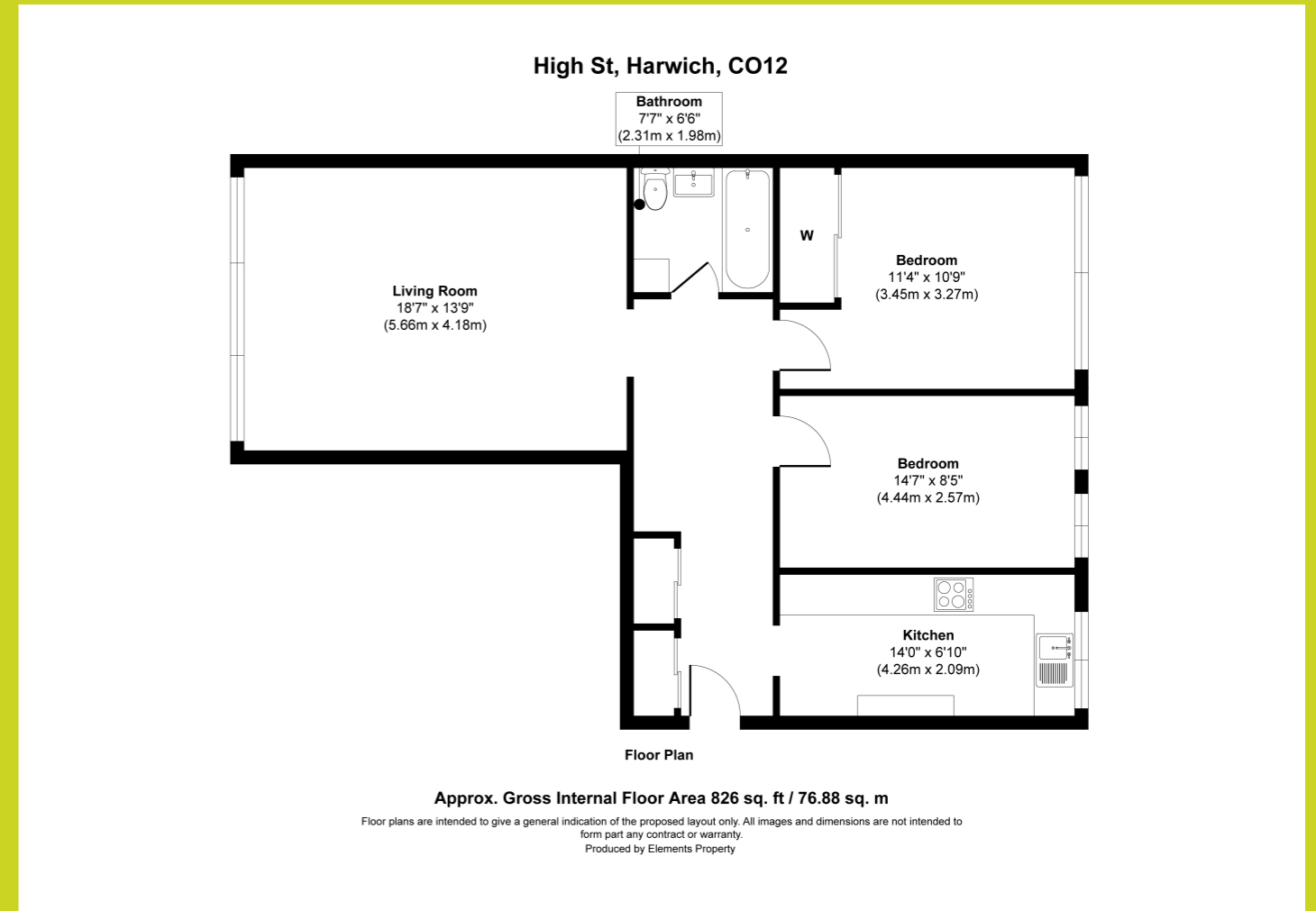

The above floor plans are not to scale and are shown for indication purposes only.

