



20 Penhurst Drive, Bexhill-on-Sea, East Sussex
, TN40 2SR

£399,950



- Immaculate Two Bed Detached Bungalow
- Lovely Quiet Cul-De-Sac Location
- Lounge With South Facing Conservatory
- Two Good Size Double Bedrooms.
- Modern Fully Fitted Kitchen
- Immaculate Fully Tiled Bathroom
- Well Presented & Neutrally Decorated Throughout
- Attached Garage With Electric Door
- Landscaped South Facing Rear Garden
- Timber Shed With Power & Light
- Good Size Access Area With Gate
- Single Garage With Work Shop Area
- Substantial Block Paved Drive (4/5 Cars)
- An Immaculate Property Throughout
- Viewing Highly Recommended



GROUND FLOOR
1182 sq.ft. (109.8 sq.m.) approx.

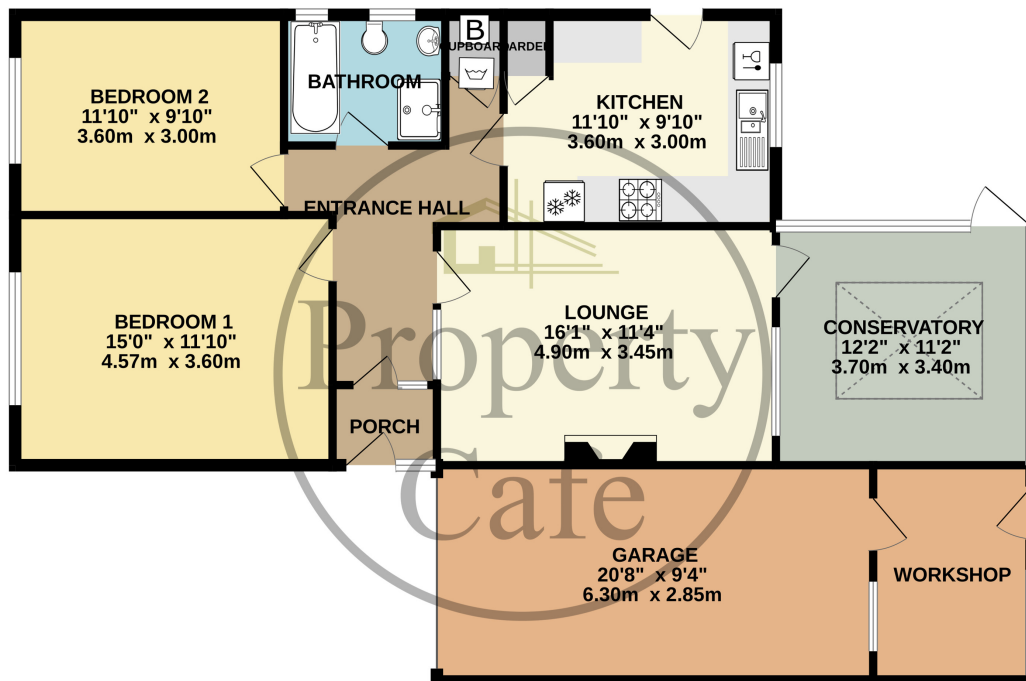

TOTAL FLOOR AREA : 1182 sq.ft. (109.8 sq.m.) approx.
 Whilst every attempt has been made to ensure the accuracy of the floorplan contained here, measurements of doors, windows, rooms and any other items are approximate and no responsibility is taken for any error, omission or mis-statement. This plan is for illustrative purposes only and should be used as such by any prospective purchaser. The services, systems and appliances shown have not been tested and no guarantee as to their operability or efficiency can be given.
 Made with Metropix ©2024

