



21 Flexmore Way, Langford, Bedfordshire, SG18 9PT

£395,000

Three bedroom link-detached family home situated in a quiet cul-de-sac. The accommodation includes two reception rooms, conservatory, kitchen and a cloakroom. Upstairs there are three good size bedrooms and a shower room. Outside the property benefits from a generous south facing rear garden, front garden and off road parking via both the garage and driveway. This property is available chain free.



## 21 Flexmore Way

Approximate Gross Internal Area  
1302 sq ft - 121 sq m

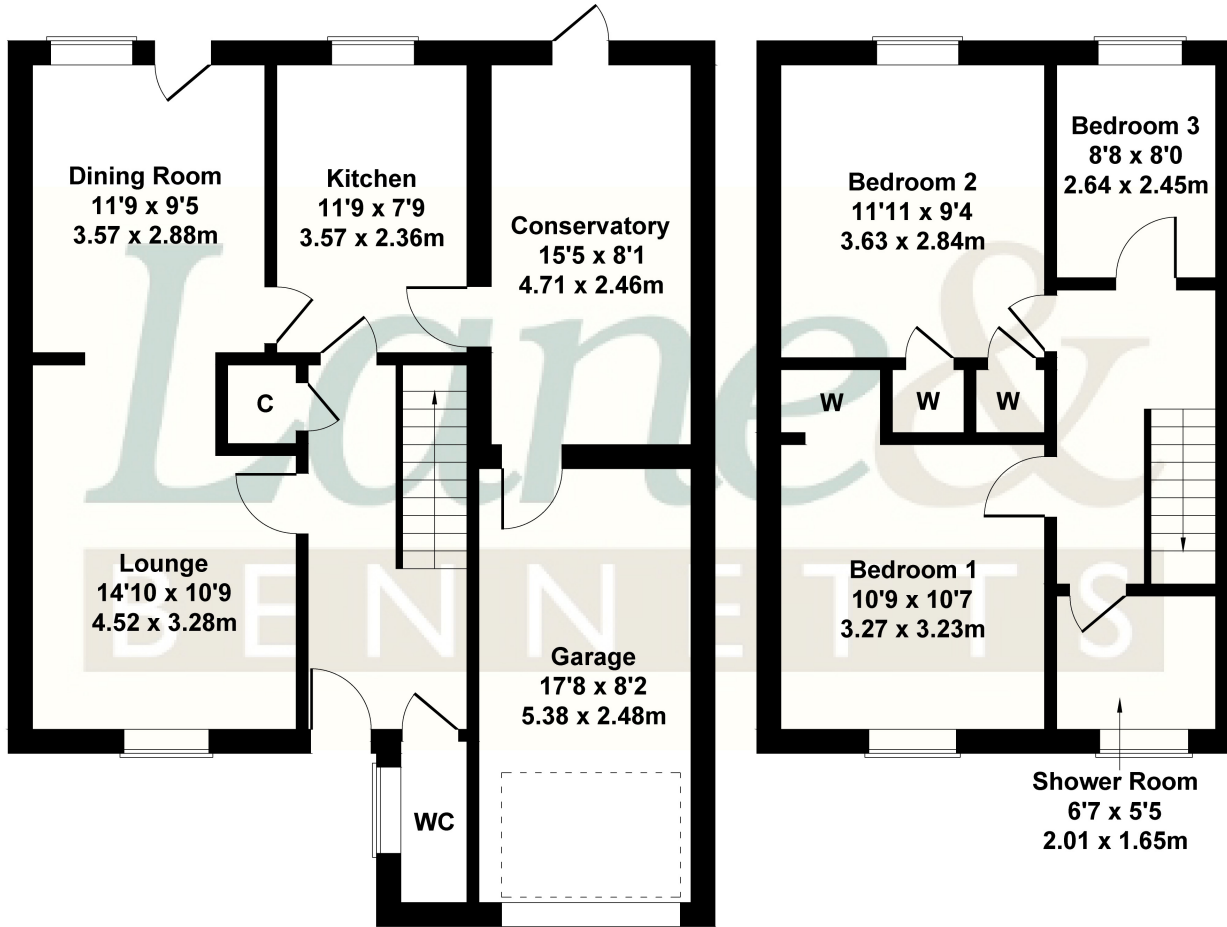

GROUND FLOOR

FIRST FLOOR

Not to Scale. Produced by The Plan Portal 2023  
For Illustrative Purposes Only.

- THREE BEDROOM LINK-DETACHED FAMILY HOME
- TWO RECEPTION ROOMS
- KITCHEN & CONSERVATORY
- SHOWER ROOM & CLOAKROOM
- GARAGE & DRIVEWAY
- FRONT & REAR GARDENS
- QUIET CUL-DE-SAC LOCATION
- AVAILABLE CHAIN FREE

