

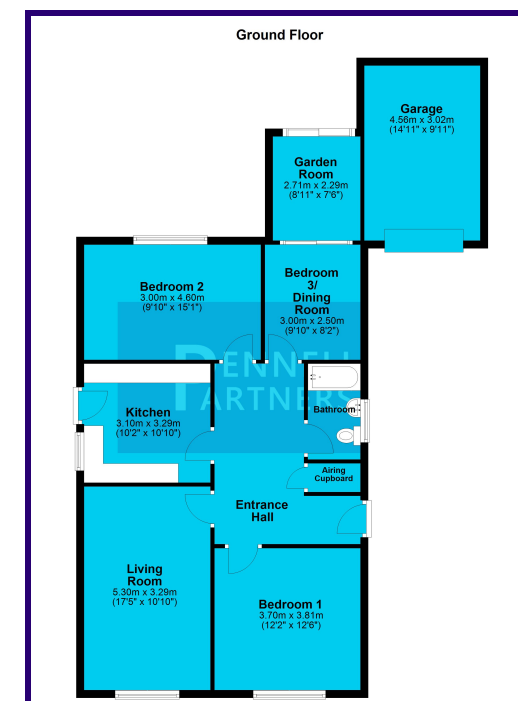

1 BARTRAM GATE, PETERBOROUGH, CAMBRIDGESHIRE. PE4 7YQ

£265,000



PENNELL & PARTNERS

Pennell & Partners, 5 Cross Street, Peterborough, PE1 1XA - 01733 209222 - hello@pennellandpartners.co.uk

ABOUT THE PROPERTY

This stunning two/three bedroom detached bungalow nestled in the sought-after Bartram Gate area of Peterborough offers a perfect blend of comfort, convenience, and style.

Key Features:

Spacious Lounge: Relax and unwind in the bright and airy lounge, perfect for entertaining guests or enjoying quiet evenings with your loved ones.

Modern Kitchen: The well-appointed kitchen comes fully equipped with sleek cabinetry, ample countertop space, and modern appliances, making meal preparation a joy.

Two Double Bedrooms: Rest peacefully in the two generously sized double bedrooms, each offering plenty of space and natural light.

Additional Bedroom/Dining Room: Versatility abounds with an additional room that can serve as a third bedroom or a spacious dining area, providing flexible living options to suit your needs.

Charming Conservatory: Step into the inviting conservatory, flooded with sunlight, where you can enjoy your morning coffee or bask in the warmth of the sun all year round.

Low Maintenance Garden: Say goodbye to the hassle of extensive yard work with the beautifully landscaped, low maintenance garden, offering the perfect outdoor retreat for relaxation and al fresco dining.

Garage and Driveway Parking: With a garage and driveway parking, you'll never have to worry about finding a spot for your vehicle, providing convenience and peace of mind.

Location:

Situated in the desirable Bartram Gate neighbourhood, this home offers easy access to a host of amenities including shops, schools, parks, and transport links, ensuring that everything you need is right at your fingertips.

EPC Rating: D (67)



ENTRANCE HALL

LOUNGE

3.50m x 5.30m (11' 6" x 17' 5")

BEDROOM ONE

3.60m x 3.70m (11' 10" x 12' 2")

BATHROOM

KITCHEN

3.50m x 3.10m (11' 6" x 10' 2")

BEDROOM TWO

3.60m x 3.00m (11' 10" x 9' 10")

BEDROOM THREE/DINING ROOM

2.60m x 3.00m (8' 6" x 9' 10")

CONSERVATORY/ GARDEN ROOM

GARAGE

