

FOR
SALE



1 Tump Cottages, Fownhope, Hereford HR1 4NJ

£340,000 - Freehold

22, Broad Street, Hereford, HR4 9AP 01432 355455 hereford@flintandcook.co.uk

PROPERTY SUMMARY

Situated in the highly favoured village of Fownhope, a beautifully presented 3 bedroom end-terraced cottage, offering ideal first time buyer/retirement accommodation and being sold with the added benefit of no onward chain. Located approximately 7 miles from the Cathedral City of Hereford and 8 miles from the market town of Ross-on-Wye, the thriving village of Fownhope has an active community and amenities including church, village hall, sports playing field, post office, butchers shop, doctors surgery, 2 public houses, an exclusive health & leisure complex (Wye Leisure), primary school and the property is also in the catchment area for Bishop's secondary school. There are also some lovely walks nearby both woodland and along the banks of the River Wye.

POINTS OF INTEREST

- *Popular village location*
- *3 Bedroom end-terraced house*
- *Well presented throughout*
- *Enclosed garden & allocated parking*
- *Ideal first time buyer/retirement accommodation*
- *No onward chain*



ROOM DESCRIPTIONS

Composite front entrance door leading into the

Kitchen/Dining Room

Kitchen fitted with wall and base units, ample worksurfaces with tiled splashbacks, electric oven and induction hob with extractor over, 1½ bowl sink and drainer unit, integrated fridge with small freezer compartment, double glazed window to the rear and door into the Utility. Dining Area with feature flagstone tiles, exposed stonework, characterful beams, radiator, gas central heating thermostat, double storage cupboard and feature double-side woodburning stove.

Utility

Fitted worksurface with under-counter space for dishwasher, washing machine and tumble dryer, 2 double glazed windows and door to the rear and pocket door into the

Downstairs WC

Porcelain tiled flooring, low flush WC, wash hand-basin, heated towel rail, recessed spotlighting and extractor.

Living Room

Feature flagstone tiles, exposed stonework, feature beams, double-sided woodburner with exposed stonework and oak beam over, radiator, carpeted stairs leading to the first floor with understairs storage cupboard, double glazed window to the front aspect and smoke alarm.

First floor landing

Double glazed window to the rear aspect, fitted carpet, loft hatch, smoke alarm and doors to the

Shower Room

Suite comprising double width cubicle with mains fitment rainfall showerhead over and tiled surround, extractor, low flush WC, wash hand-basin with storage under, double glazed opaque window to the rear, heated towel rail and porcelain tiled flooring.

Bedroom 1

Exposed floorboards, radiator and double glazed window to the front aspect.

Bedroom 2

Exposed floorboard, radiator, double glazed window to the front aspect and built-in wardrobe.

Bedroom 3

Fitted carpet, radiator, double glazed window to the rear aspect with fitted shelving.

Outside

Leading from the rear Utility door there is a large stoned area for seating, outside wood store, meter boxes and steps leading to the remainder of the garden which is mainly laid to lawn with pathway leading to the rear access gate, enclosed by fencing with a range of plants and shrubs. Outside shed. To the rear there are also 2 allocated parking spaces. To the front of the property, a gravelled pathway provides access to the property with the remainder of the front garden laid to lawn, bordered by plants.

Services

Mains water, electricity, drainage and gas are connected. Telephone (subject to transfer regulations). Gas-fired central heating.

Outgoings

Council tax band C - payable 2024/25 £2077.01
Water and drainage - rates are payable.

Money laundering regulations

Prospective purchasers will be asked to produce identification, address verification and proof of funds at the time of making an offer.

Viewing

Strictly by appointment through the Agent, Flint & Cook, Hereford (01432) 355455.

Directions

From Hereford, proceed initially towards Ledbury on the A438 and then, just past Hereford fire station, turn right onto the B4224 towards Fownhope. Continue through the villages of Hampton Bishop and Mordiford into Fownhope and the property is located on the left-hand side just before the turning for the Woolhope Road. What3words - wiggling.tamed.class

Ground Floor

Approx. 46.5 sq. metres (500.2 sq. feet)

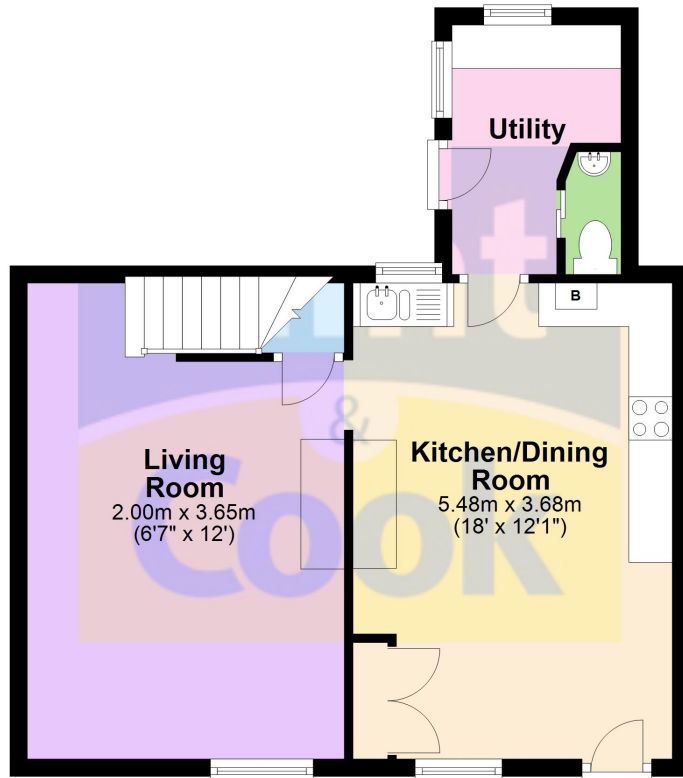

First Floor

Approx. 39.5 sq. metres (424.6 sq. feet)

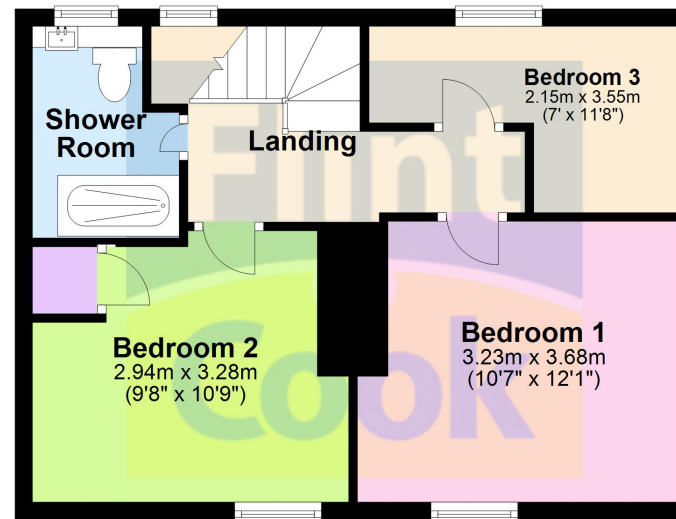

Total area: approx. 85.9 sq. metres (924.8 sq. feet)

This plan is for illustrative purposes only
Plan produced using PlanUp.

These particulars are prepared for the guidance only of prospective purchasers. They are intended to give a fair and overall description of the property and do not constitute the whole or any part of an offer or contract. Any information contained herein (whether in text, plans or photographs) is given in good faith but should not be relied upon as being a statement or representation of fact. Any plans provided by the agents and/or with the sales particulars are intended for guidance purposes only; we cannot guarantee the accuracy and scale of any plans, and they do not form any part of the sales contract. Nothing in these particulars shall be deemed to be a statement that the property is in good condition or otherwise nor that any services or facilities are in good working order. Any movable contents, fixtures and fittings, (whether wired or not) referred to in these property particulars (including any shown in the photographs) are, unless the particulars say otherwise, excluded from the sale. In the event that the buyer proposes to purchase any movable contents or include them in any offer for the property, the buyer cannot in any respect imply any such inclusion from the property particulars. Any areas, measurements or distances referred to herein are approximate only and may be subject to amendment. It should not be assumed that the property has all necessary planning, building regulation or other consents and these matters must be verified by an intending purchaser. The information in these particulars is given without responsibility on the part of the agents or their clients and neither the agents nor their employees have any authority to make or give any representations or warranties whatever in relation to this property.

Flint & Cook Privacy Statement: We take your privacy very seriously. Your data will not be shared with any other parties without your express permission. Our Data protection Policy can be read in full on the Flint & Cook website, www.flintandcook.co.uk

Energy Efficiency Rating		Current	Potential
Very energy efficient - lower running costs			
(92+)	A		
(81-91)	B		86
(69-80)	C		
(55-68)	D		57
(39-54)	E		
(21-38)	F		
(1-20)	G		
Not energy efficient - higher running costs			
England, Scotland & Wales			