



Sanderling Close, Letchworth Garden City, Hertfordshire, SG6

£950 pcm

- Unfurnished WELL PRESENTED property
- DOUBLE bedroom with built in wardrobe
- Three piece bathroom suite with electric shower over the bath
- Good size living room with laminate flooring and uPVC French doors to the rear garden
- Fitted kitchen with cooker, fridge / freezer and washing machine
- Private enclosed rear garden with patio and lawn area and gated access to side
- Allocated OFF ROAD parking space
- Less than a 20 minute walk to Letchworth MAINLINE STATION
- Very good road links close to A1(M)





Great size one bedroom cluster home | Approx 445 Sq Ft | DOUBLE Bedroom | GOOD SIZE Living Room | Modern kitchen with cooker, fridge / freezer and washing machine | Three piece bathroom suite with electric shower over bath | Enclosed rear garden | Allocated parking space | A mile walk to Letchworth mainline STATION and town centre | Very good road links - close to A1(M) |

| ADDITIONAL INFORMATION

Availability: Mid - Early July

Unfurnished

Sorry, pets NOT allowed

Deposit: £1,096.00

Council Tax Band - B

EPC Rating - E

uPVC double glazed windows

| GROUND FLOOR

Hallway

Living Room: Approx 12' 2" x 12' 0" (3.71m x 3.66m)

Kitchen: Approx 11' 9" x 5' 6" (3.58m x 1.68m)

| FIRST FLOOR

Bedroom: Approx 11' 9" x 5' 6" (3.58m x 1.68m)

Bathroom: Approx 6' 2" x 5' 7" (1.88m x 1.70m)

| OUTSIDE

Allocated parking

Good size private rear garden

Great size one bedroom cluster home | Approx 445 Sq Ft | DOUBLE Bedroom | GOOD SIZE Living Room | Modern kitchen with cooker, fridge / freezer and washing machine | Three piece bathroom suite with electric shower over bath | Enclosed rear garden | Cont'd.....



Ground Floor

Approx. 21.2 sq. metres (227.8 sq. feet)

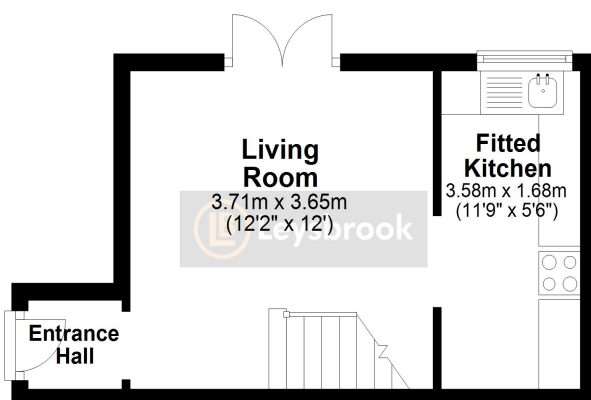

First Floor

Approx. 20.2 sq. metres (217.7 sq. feet)

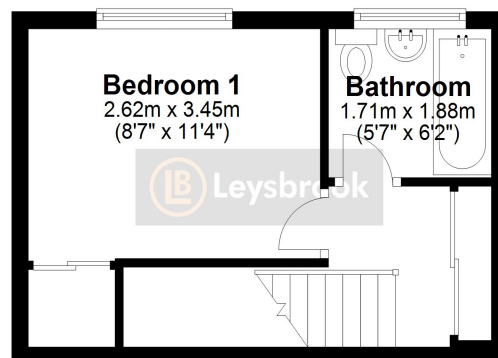

Total area: approx. 41.4 sq. metres (445.6 sq. feet)

Created by Leysbrook for guide purposes only. This plan is NOT TO SCALE and is intended to illustrate the general layout of the property and should be used as such by any prospective purchaser. Whilst every attempt has been made to ensure the accuracy of the floor plan, measurements of doors, windows, rooms and any other items are approximate and no responsibility is taken for any error, omission or mis-statement. The services, systems and appliances shown have not been tested and no guarantee of their operability can be given.

Plan produced using PlanUp.