



£650,000

Falconwood Avenue, Welling, Kent,
DA16 2SW

Christopher
Russell
PROPERTY SERVICES



AGENTS NOTES: No statement in these particulars is to be relied upon as representations of fact and purchasers should satisfy themselves by inspection, or otherwise, as to the accuracy of the statements contained herein. These details do not constitute any part of any offer or contract. Christopher Russell have not tested any equipment or heating system mentioned and purchasers are advised to satisfy themselves as to their working order. Great care is taken when measuring but measurements should not be relied upon for ordering carpets, equipment etc.

Christopher Russell LLP. Registered in Cardiff. Partnership No. OC329088

Christopher Russell Property Services

33 The Oval, Sidcup, Kent DA15 9ER • Tel: 020 8300 1234 Fax: 020 8300 6530 • sales@christopher-russell.co.uk

A well presented four bedroom extended semi detached chalet style home conveniently located for Eastcote Primary School, Oxleas Woods, local shops Falconwood and Welling Train Stations.

Presented in very good decorative condition the property comprises; entrance hall, 20'x19' lounge, separate dining room, a good sized L shaped kitchen/breakfast room and bathroom on the ground floor with four double bedrooms and a family shower room on the first floor.

Modernised throughout the property features a modern contemporary fitted and partly integrated kitchen, modern bathroom and shower room, double glazed windows, gas central heating and air conditioning on the ground floor.

Outside there is a good sized driveway that provides parking for three cars. There is side access leading to a well established and maintained rear garden extending approximately 80ft with a summerhouse at the end of the garden that has power.

There is a garage to the side/rear garden that is ideal for bike store, garden equipment or it could be converted into an office from home.

Council Tax Band E.



GROUND FLOOR
1001 sq.ft. (93.0 sq.m.) approx.

1ST FLOOR
682 sq.ft. (63.3 sq.m.) approx.

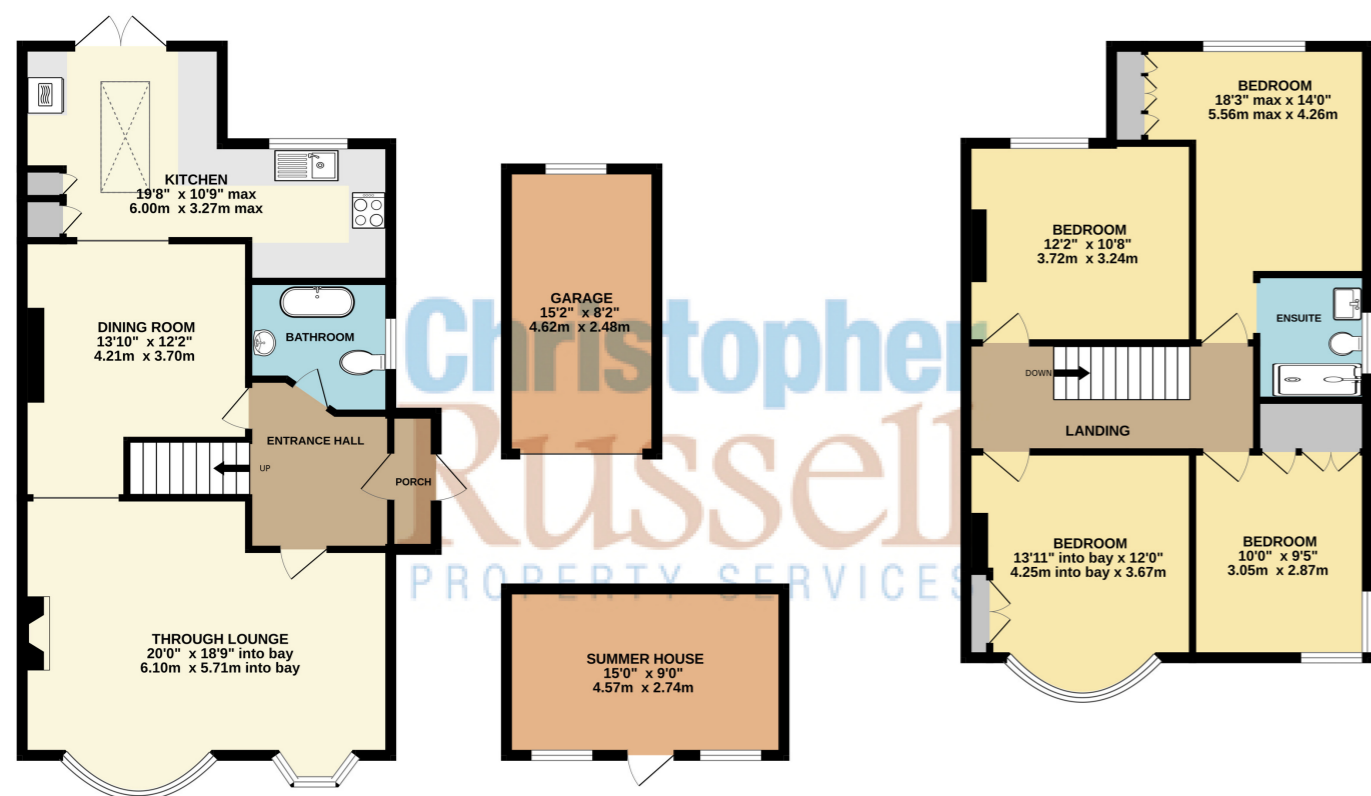

TOTAL FLOOR AREA: 1682 sq.ft. (156.3 sq.m.) approx.

Whilst every attempt has been made to ensure the accuracy of the floorplan contained here, measurements of doors, windows, rooms and any other items are approximate and no responsibility is taken for any error, omission or mis-statement. This plan is for illustrative purposes only and should be used as such by any prospective purchaser. The services, systems and appliances shown have not been tested and no guarantee as to their operability or efficiency can be given.
Made with Metropix ©2024

