

Rent
Me



Sedgewick Court, Central Way, Warrington.

£595 pcm

Central Location | Lift & Stair Access | Modern Throughout | Double Bedroom | Part Furnished | Available Now |



GROUND FLOOR
518 sq.ft. (48.1 sq.m.) approx.

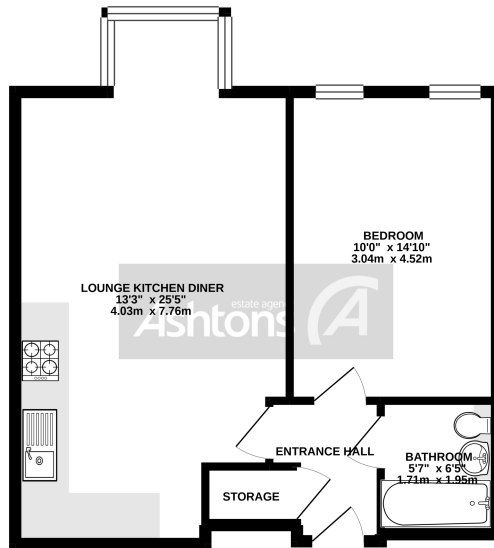

TOTAL FLOOR AREA: 518 sq ft. (48.1 sq.m.) approx.
Whilst every attempt has been made to ensure the accuracy of the floorplan contained herein, measurements of doors, windows, stairs and any other items are approximate and no responsibility is taken for any error, omission or mis-statement. This plan is for illustrative purposes only and should be used as such by any prospective purchaser. The services, systems and appliances shown here are based on the current plans and no guarantee as to their condition or existence can be given.
Made with Metropac 0.5000

Situated in a fantastic location in the hub of Warrington this 3rd floor apartment offers superb views over the town with the Train Station and Town Centre just a short walk away. With the added benefit of a lift, in brief this one bedroom property comprises; entrance hall with cupboard; a three piece bathroom; generous double bedroom; and a fantastic open plan lounge, and kitchen/diner with wall/base units, oven/hob, and fridge freezer. The property is offered on a part furnished basis and viewings are essential to appreciate the standard of the property. Plenty of parking available.



*Contact your local office
to arrange a viewing:*

Padgate: 01925 479334
Great Sankey: 01925 454300
Winwick: 01925 232146
Stockton Heath: 01925 453400
St.Helens: 01744 754120
Wigan: 01942 498862
Culcheth: 01925 764744
Ashton-In-Makerfield: 01942 364446
Newton-Le-Willows: 01925 907770
Commercial Office: 01925 907709
Lettings Head Office: 01925 873533
Financial Services: 01925 221234

Viewing Arrangements

Viewing is strictly by appointment only through Ashtons Estate Agency.

Disclaimer Property Details

These particulars, whilst being believed to be accurate are set out as a general outline only for guidance and do not constitute any part of an offer or contract. Intending purchasers should not rely on them as statements of representation of fact, but must satisfy themselves by inspection or otherwise as to their accuracy. We have not carried out a detailed survey nor tested the services, appliances and specific furnishings. The measurements given are approximate. No person in this firm's employment has the authority to make or give any representation or warranty in respect of the property.

All details, photographs and floorplans are the copyright of Ashtons Estate Agency.



How much you can borrow?
Speak to a mortgage expert in your local office.

Ashtons Financial Services

Ashtons.net rightmove

PrimeLocation.com Zoopla.co.uk

Ashtons