

## Mildmay Road, Chelmsford

### £575,000 Freehold

- Extended Terraced House
- Driveway Parking
- Viewing advised
- Old Moulsham
- 4 Bedrooms

Spacious Extended Four-Bedroom Home in Old Moulsham, Chelmsford

Located in Chelmsford's popular Old Moulsham area, McCartney Estate Agents are pleased to present this spacious, extended four-bedroom family home. This property benefits from gas central heating and double glazing throughout, ensuring comfort and efficiency.





Approx. Gross Internal Area 118.5 sq M ( 1276 sq Ft)

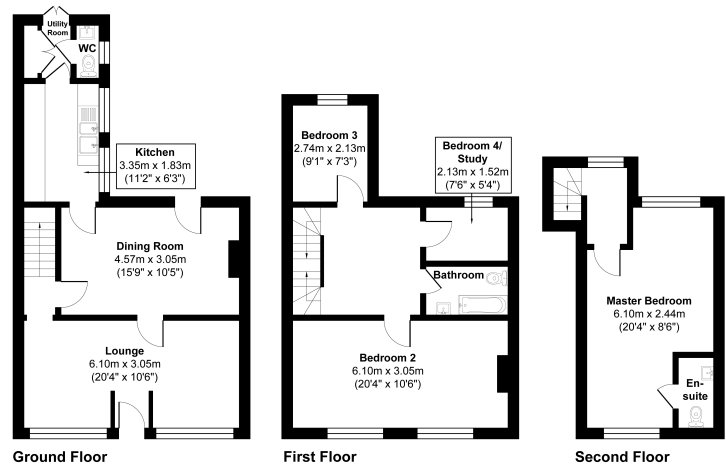

Measurements are approximate and for illustration purposes only, while we do not doubt the accuracy and completeness, we advise you conduct independent assessment of the property to determine monetary value.  
© @ modaphoto.co.uk www.modaphoto.co.uk