



Thorntons 
The right way to move

3 Towerhill Close, Cradlehall,
Inverness, Highland IV2 5GY





Summary

Stunning detached residence nestled within a quiet cul-de-sac in the highly sought after Cradlehall area of Inverness. Backing onto Maxwell Park, the property enjoys a private, enclosed garden and features a fully equipped garden office—ideal for remote working or creative pursuits. Tastefully, redecorated throughout, this immaculate home offers spacious and flexible accommodation across two floors. There is a formal lounge with a square bay window, a bright and contemporary open-plan kitchen/dining room, a versatile family room or formal dining space. A utility room with garden and garage access, along with a convenient WC. Upstairs there are five generously sized double bedrooms, two of which benefit from stylish en-suite shower rooms. The principal bedroom also features a walk-in wardrobe. A modern family bathroom serves the remaining bedrooms.

Features

- Exceptional 5-bed detached family home
- private cul-de-sac of just four properties
- Highly sought-after Cradlehall area
- Stylish open-plan kitchen/dining room, utility
- Spacious family room and formal lounge
- 2 en-suite bedrooms, family bathroom, WC
- Enclosed garden backing onto Maxwell Park
- Driveway and integrated double garage
- CT Band: G, EPC band: B, Tenure: Freehold
- Approx. Floor Area: 211 m²

Room Measurements

Kitchen/Diner 11'2" x 39'0" (3.40m x 11.89m)
 Lounge 17'7" x 16'1" (5.35m x 4.89m)
 Family Room 10'5" x 11'9" (3.18m x 3.57m)
 Principle Bedroom 16'8" x 16'2" (5.08m x 4.92m)
 Principle Ensuite 8'0" x 7'3" (2.44m x 2.21m)
 Bedroom 2 15'4" x 13'3" (4.67m x 4.04m)
 Bedroom 2 Ensuite 7'4" x 6'5" (2.23m x 1.96m)
 Bedroom 3 12'2" x 10'8" (3.70m x 3.25m)
 Bedroom 4 10'8" x 10'9" (3.26m x 3.27m)
 Bedroom 5 9'7" x 8'7" (2.92m x 2.62m)
 Bathroom 7'1" x 6'6" (2.15m x 1.97m)
 Utility 5'11" x 7'11" (1.80m x 2.42m)
 WC 4'11" x 7'10" (1.49m x 2.40m)
 Garden office 11'6" x 16'5" (3.50m x 5.00m)



Exceptional family home with quality
finishes throughout







**Generously proportioned with
flexible layout**



Floorplan

GROUND FLOOR

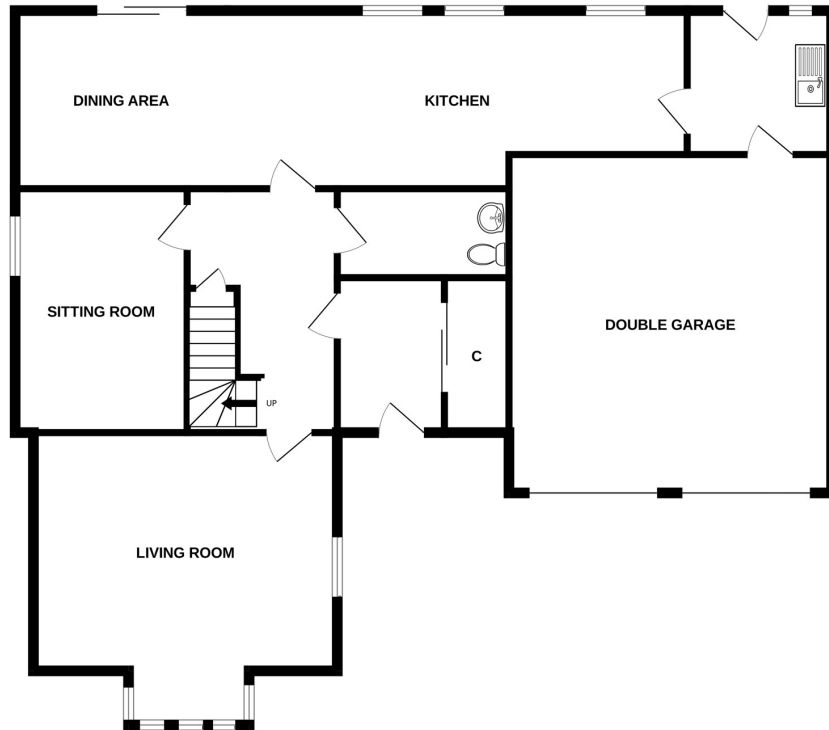

1ST FLOOR



Whilst every attempt has been made to ensure the accuracy of the floorplan contained here, measurements of doors, windows, rooms and any other items are approximate and no responsibility is taken for any error, omission or mis-statement. This plan is for illustrative purposes only and should be used as such by any prospective purchaser. The services, systems and appliances shown have not been tested and no guarantee as to their operability or efficiency can be given.
Made with Metropix ©2025

While these Sales Particulars are believed to be correct, their accuracy is not warranted and they do not form any part of any contract. All sizes are approximate.

Thorntons

The right way to move



Our Branches

ANSTRUTHER

5A Shore Street, Anstruther, KY10 3EA
01333 310481
anstrutherea@thorntons-law.co.uk

ARBROATH

165 High Street, Arbroath, DD1 1DR
01241 876633
arbroathea@thorntons-law.co.uk

BONNYRIGG

3-7 High Street, Bonnyrigg, EH19 2DA
0131 663 7135
bonnyriggea@thorntons-law.co.uk

EDINBURGH

Citypoint, 3rd Floor, 65 Haymarket Terrace, Edinburgh, EH12 5HD
0131 297 5980
edinburghea@thorntons-law.co.uk

CUPAR

49 Bonnygate, Cupar, KY15 4BY
01334 656564
cuparea@thorntons-law.co.uk

DUNDEE

Whitehall House, 33 Yeaman Shore, Dundee DD1 4BJ
01382 200099
dundeaea@thorntons-law.co.uk

FORFAR

53 East High Street, Forfar, DD8 2EL
01307 466886
forfarae@thorntons-law.co.uk

PERTH

7 Whitefriars Crescent, Perth, PH2 0PA
01738 443456
perthea@thorntons-law.co.uk

INVERNESS

Kintail House, 2 Sir Walter Scott Drive, Inverness, IV2 3BW
01463 383977
genea@thorntons-law.co.uk

ST ANDREWS

17-21 Bell Street, St Andrews, KY16 9UR
01334 474200
standrewsea@thorntons-law.co.uk

Thorntons is a trading name of Thorntons Law LLP Regulated by The Law Society of Scotland



@ThorntonsPropertyServices



@ThorntonsProperty



@ThorntonsPS