

Habershon Drive, FRIMLEY, Surrey GU16 9TN

Jigsaw Estates present to the market this well presented, perfect first time property situated on the popular Cheylesmore park development on the Camberley/Frimley borders.

Accommodation comprises two double bedrooms, a fitted kitchen and a spacious lounge/diner with double doors leading onto the rear garden. Further benefits include a family bathroom, Upvc double glazing and replaced electric heaters. The garden is secluded and has a patio seating area and a side gate. There is ample communal parking directly adjacent to the property with enough spaces for visitors as well.

Cheylesmore Park is a very popular location with a number of nearby local amenities within walking distance on the neighbouring Heatherside development as well as a number of excellent local schools all within close proximity. For keen Golfers the property is directly opposite Pine Ridge golf club which also has a sports bar, and there are local woodland walks on your doorstep!

In our opinion this property would ideally suit either a first time buyer or make a fantastic investment purchase.

Offers in Excess of £325,000 Freehold



Ground Floor

Approx. 28.2 sq. metres (303.1 sq. feet)

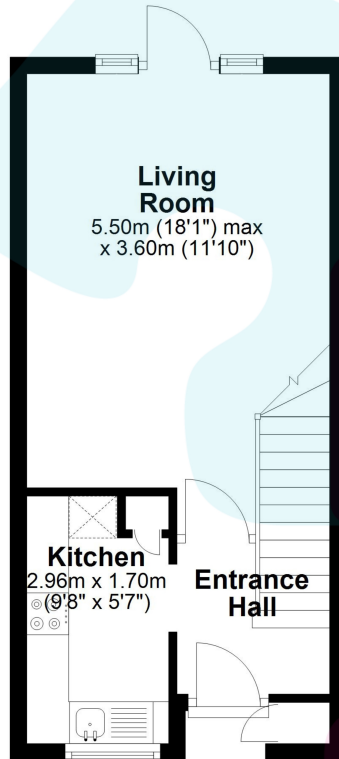

First Floor

Approx. 28.8 sq. metres (309.9 sq. feet)

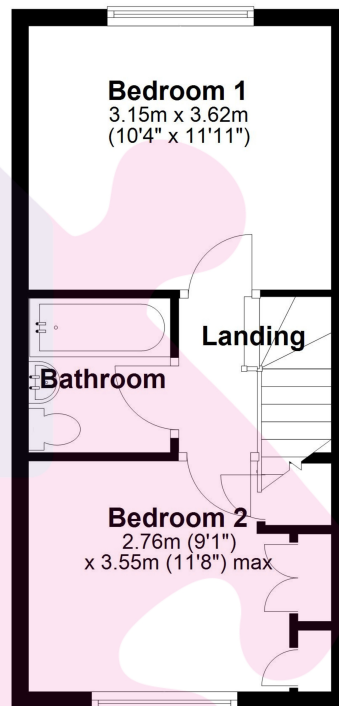

Total area: approx. 56.9 sq. metres (612.9 sq. feet)

Floorplan is for illustration purposes only. All measurements are approximate and should be verified. Total Floor Area includes any garages, outhouses or ancillary buildings shown on the floorplan.
EPC and Floorplan produced by WWW.G-Whis.net
Plan produced using PlanUp.

- TWO DOUBLE BEDROOMS
- LARGE LIVING ROOM
- RAER GARDEN
- COMMUNAL PARKING
- CLOSE TO LOCAL AMMENEITIES
- LOTS OF GREEN SPACES NEARBY
- END OF TERRACE
- FITTED KITCHEN
- FREEHOLD
- QUIET LOCATION
- CLOSE TO LOCAL SCHOOLS

Energy Efficiency Rating		
	Current	Potential
Very energy efficient - lower running costs		
(92+) A	56	89
(81-91) B		
(69-80) C		
(55-68) D		
(39-54) E		
(21-38) F		
(1-20) G		
Not energy efficient - higher running costs		
England, Scotland & Wales		EU Directive 2002/91/EC

