



**Kingsway Grove
Thurnscoe
Rotherham
South Yorkshire
S63 0TF**

Offers in Excess of £141,000

bettermove

Kingsway Grove

Rotherham

Bettermove are proud to present this 1 bedroom semi-detached bungalow in the sought after area of Thurnscoe.

The property benefits from double glazing, gas central heating throughout and has off street parking available via the driveway and garage. The council tax band is A.

The interior of this well presented property comprises a spacious living room, dining room, fitted kitchen, family bathroom, bedroom and utility room behind the garage. The exterior boasts large gardens to the side and front of the property, perfect for enjoying the summer months.

Located in the popular village of Thurnscoe, the property is close to a range of amenities, including shops, supermarkets, restaurants and pubs. Excellent transport connections can be found from Thurnscoe Train Station, the A635 and many local buses.

This exciting opportunity should not be missed! All enquiries can be made through Bettermove on 0330 004 0050.

You can secure the purchase today by paying an exclusivity fee of £1,000 which gives you the rights to purchase within a given timeframe.

Paying this fee ensures that the seller takes their property off the market and reserves it exclusively for you, therefore eliminating the risk of gazumping and aborted costs.

The exclusivity fee is returned to you upon successful completion of the property.



Ground Floor

Approx. 93.1 sq. metres (1002.2 sq. feet)

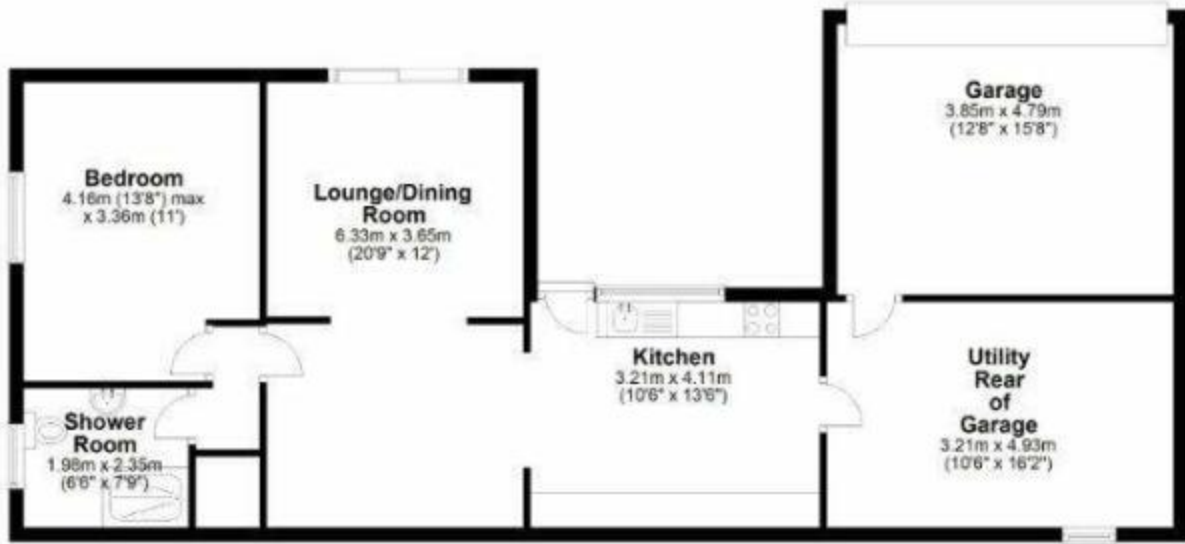

Total area: approx. 93.1 sq. metres (1002.2 sq. feet)

Energy Efficiency Rating		
	Current	Potential
<i>Very energy efficient - lower running costs</i>		
(92-100) A		
(81-91) B		82
(69-80) C		
(55-68) D	59	
(39-54) E		
(21-38) F		
(1-20) G		
<i>Not energy efficient - higher running costs</i>		
England, Scotland & Wales	EU Directive 2002/91/EC	



20-22 Bridge End, Leeds, LS1 4DJ
t: 0330 004 0050 e: hello@bettermove.co.uk
www.bettermove.co.uk