



**3/5, Northcote Street, Dalry, Edinburgh, EH11 2HL**

Beautifully Presented, Three-Bedroom, Second Floor Apartment

Up to date price and viewing info at [mov8realestate.com/property](https://mov8realestate.com/property)





# Property Description

Beautifully presented, three-bedroom, second floor apartment, set in a modern, factored and lift-served residential development, located in the popular and well-placed Dalry district, to the west of Edinburgh city centre.

Comprises an; entrance hall, living room, kitchen, three double bedrooms, a bathroom and en-suite shower room.

Features include good room sizes, neutral décor and modern flooring, gas central heating, double glazing, TV and telephone points, a secure entry system and excellent integrated storage provision.

Externally the property benefits from a shared rear garden, cycle storage and ample parking within the monitored resident's car park.

The wide and welcoming entrance hall has two storage cupboards, the entryphone handset and serves each room within the property. With French doors opening onto a Juliet balcony the bright living room features carpeted flooring, and a pendant light fitting.

Set internally off the hall, the kitchen is fitted with contemporary units, stone effect worktops, tiled splashbacks and a stainless steel sink. Appliances include an integrated electric hob, oven, extractor hood and washing machine.

Set to the rear, the master bedroom features a built-in wardrobe and en-suite shower room with a mains mixer shower and tiled splashbacks. Bedroom two is well finished, with carpeting and a built-in wardrobe, whilst set off the living room, bedroom three also includes carpeted flooring.

Completing the accommodation, the bathroom is fitted with a white three-piece suite with a mains tap shower attachment.

**mov8** REAL ESTATE  
Estate Agents and Solicitors

**3/5, Northcote Street Dalry, Edinburgh EH11 2HL**

Approximate Gross Internal Area: (926 sq ft - 86 sq m.)

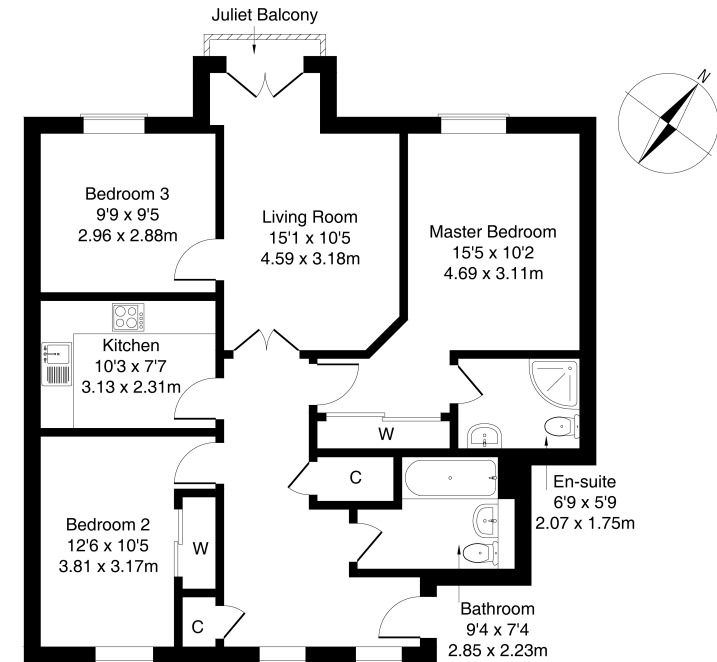

Legal Disclaimer : Floor-plan and measurements are for illustrative guidance only, and not intended to form part of any contract.

# Area Description

Dalry is a high-amenity area within walking distance of Haymarket Station, Edinburgh's West End and the city centre. There is excellent local shopping, with specialist shops and supermarkets close by, including Co-operative and Lidl supermarkets, whilst a Sainsbury's and Aldi are located in nearby in Gorgie. There is an extensive range of cafes, bars and restaurants both in Dalry and the nearby West End. whilst

leisure facilities include the Fountain Park complex with a multi-screen cinema and fitness centre, and the Dalry Swim Centre. Dalry is also convenient for Napier and Heriot-Watt universities, and Edinburgh College. There are highly frequent bus services, whilst the tram network is available from Haymarket for direct connections to Edinburgh Airport or the city centre.









### Our Services

- Free pre-sale property valuations
- Great value fixed estate agency fees
- Extensive buyer matching database
- Purchase and sale conveyancing

### Contact Us

0345 646 0208

[sales@mov8realestate.com](mailto:sales@mov8realestate.com)

[www.mov8.com](http://www.mov8.com)

### Head Office

6 Redheughs Rigg, Edinburgh, EH12 9DQ

### Glasgow Office

77 Renfrew Street, Glasgow, G2 3BZ



Estate Agents and Solicitors

