

SOLD STC

£430,000 Freehold



WOODHOUSE
PROPERTY CONSULTANTS

**43 Tudor Avenue, West
Cheshunt, Hertfordshire. EN7
5AU**

ABOUT THE PROPERTY

Woodhouse are pleased to offer this lovely 3-Bedroom Semi-Detached home situated in the desirable EN7 of West Cheshunt. This home is ideal for any First-Time Buyer / young family looking to move into this neighbourhood for its schools and amenities

The ground floor comprises of the Lounge-Diner & Kitchen. To the 1st floor there are the 3 x Bedrooms & Family Bathroom. Externally to the rear there is a Larger-than-average beautiful Garden including a brick-built Outhouse. There is side-access that leads to the front Garden.

Tudor Avenue is desirable for being close to recommended schools such as Bonneygrove (Primary) and the coveted Goffs Academy & Goffs Churchgate (Secondary). There are plenty of amenities nearby. Cheshunt High Street is within walking distance, and Cheshunt Station 1.6 miles walk away (approx 30 minute walk). You also have the shops & eateries of Cuffley, Goffs Oak, & Brookfield Centre. Both Cuffley & Cheshunt stations take you directly into London (the latter into Liverpool St has quick as 20 minutes). Road links are great too, with the A10 & M25 only minutes drive away.

There is plenty of greenery with Broxbourne Woods and Lee Valley Nature Reserve nearby. Contact Woodhouse today for further details and to arrange a viewing to see for yourself what this home has to offer you!

FEATURES

- CHAIN-FREE
- Semi-Detached
- 3 Bedrooms
- Lounge-Diner
- Beautiful Garden, larger-than-average, + Outhouse
- Ideal for First-Time Buyer / young family
- West Cheshunt neighbourhood
- Circa 30 minute walk to High St & Cheshunt Station
- Catchment area for coveted schools



ROOM DESCRIPTIONS



FLOORPLAN

GROUND FLOOR

1ST FLOOR

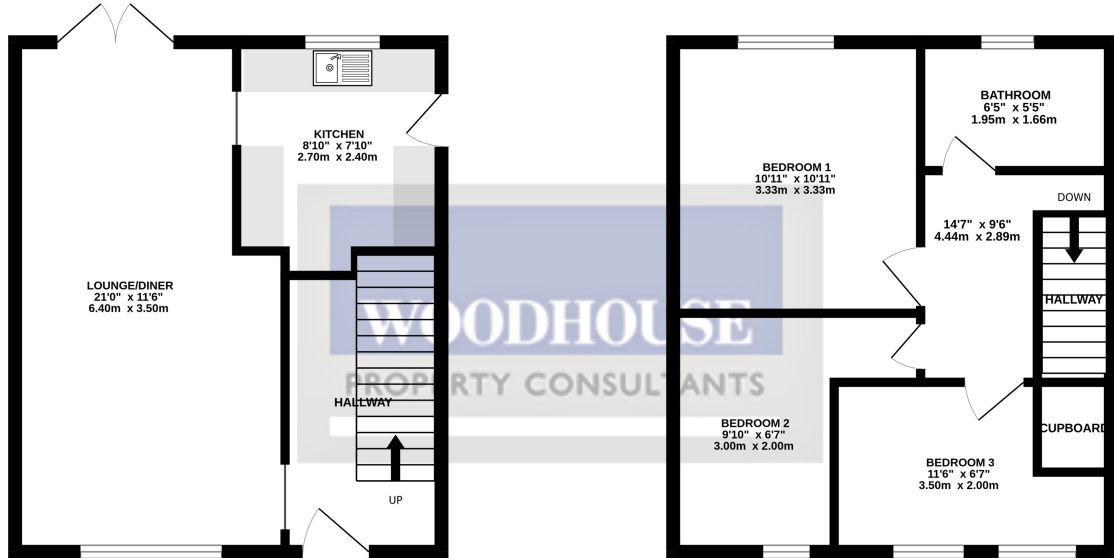

Whilst every attempt has been made to ensure the accuracy of the floorplan contained here, measurements of doors, windows, rooms and any other items are approximate and no responsibility is taken for any error, omission or mis-statement. This plan is for illustrative purposes only and should be used as such by any prospective purchaser. The services, systems and appliances shown have not been tested and no guarantee as to their operability or efficiency can be given.
Made with Metropix 6/2025

EPC

