



**6 Wendover Court, Wendover Road, Staines-upon-Thames, Surrey. TW18 3DP.**  
**1 Bedroom Apartment - £250,000 Leasehold**

# 6 Wendover Court, Wendover Road, Staines-upon-Thames, Surrey. TW18 3DP.

01784 451458

## 1 Bedroom Apartment - £250,000 Leasehold

HUGELY SPACIOUS ONE BEDROOM APARTMENT SITUATED IN THIS MUCH SOUGHT AFTER DEVELOPMENT IDEALLY LOCATED FOR EASY ACCESS TO BOTH STAINES & EGHAM TOWN CENTRES, LOCAL MOTORWAY NETWORKS & HEATHROW AIRPORT. The property has just been extensively refurbished throughout and benefits from a spacious lounge/diner, separate luxury fitted kitchen, large double bedroom, modern white bathroom suite, residents parking and garage. No Onward Chain. Viewings Highly Recommended!

### Key Features

RESIDENTS PARKING & GARAGE  
EASY ACCESS TO LOCAL MOTORWAY NETWORKS & HEATHROW AIRPORT  
EXTENSIVELY REFURBISHED  
LUXURY KITCHEN & BATHROOM  
CLOSE TO TOWN CENTRE & MAINLINE TRAIN STATION

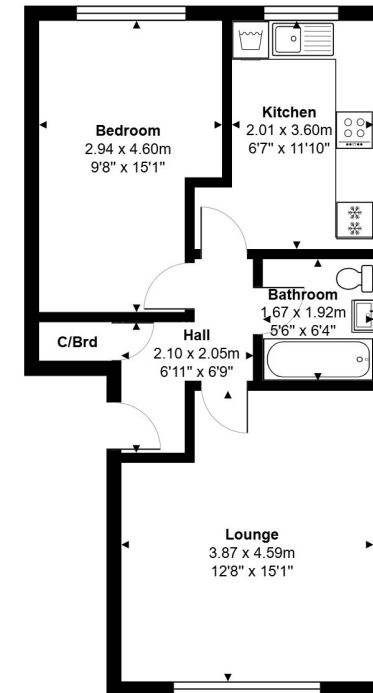
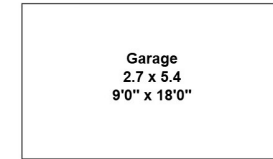

First Floor

Total Area: 49.4 m<sup>2</sup> ... 531 ft<sup>2</sup>

All measurements are approximate and for display purposes only.



**GREGORY BROWN**  
RESIDENTIAL SALES & LETTINGS



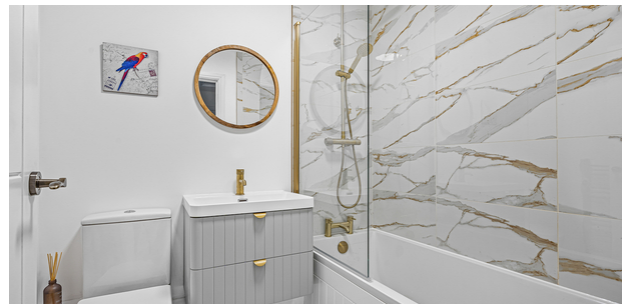







6 Wendover Court, Wendover Road, Staines-upon-Thames, Surrey. TW18 3DP.

gregory-brown.co.uk

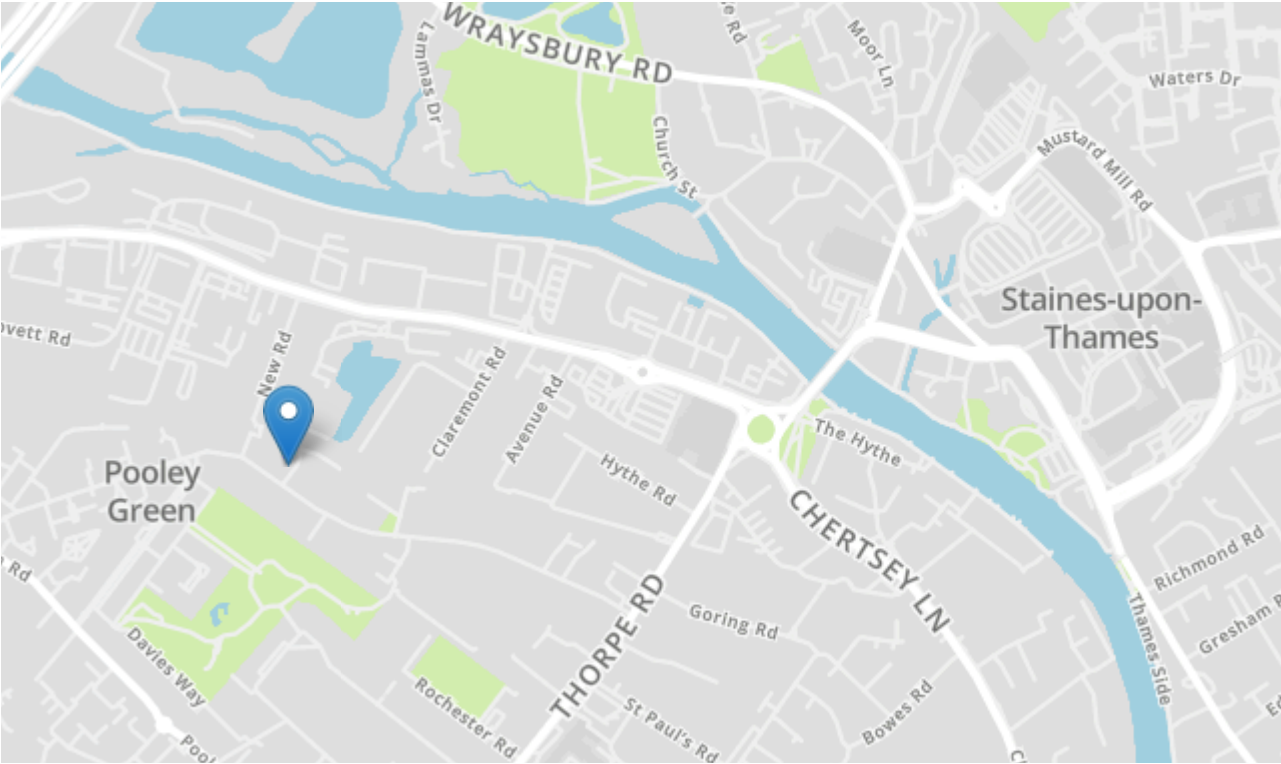

Tenure	Leasehold
Lease Term	To Be Confirmed
Ground Rent	To Be Confirmed
Service Charge	To Be Confirmed
Local Authority	
Council Tax	

We have prepared these property particulars as a general guide to a broad description of the property. They are not intended to constitute part of an offer or contract. We have not carried out a structural survey and the services, appliances and specific fittings have not been tested. All photographs, measurements, floorplans and distances referred to are given as a guide only and should not be relied upon for the purchase of carpets or any other fixtures or fittings. Lease details, service charges and ground rents (where applicable) and council tax are given as a guide only and should be checked and confirmed by your solicitor prior to exchange of contracts. The copyright of all details, photographs and floorplans remain exclusive to Gregory Brown.

