



*6 Singleton Avenue, St Helens, Merseyside. WA11
9DA.
£115,000*



No Onward Chain | Leasehold | Perfect 1st Purchase Or Investment | Well Proportioned
Accommodation | Council Tax - A | Viewings Advised | Two Reception Rooms | Three Bed Mid
Terrace | Lots Of Potential |



GROUND FLOOR
378 sq.ft. (35.1 sq.m.) approx.

1ST FLOOR
385 sq.ft. (35.7 sq.m.) approx.

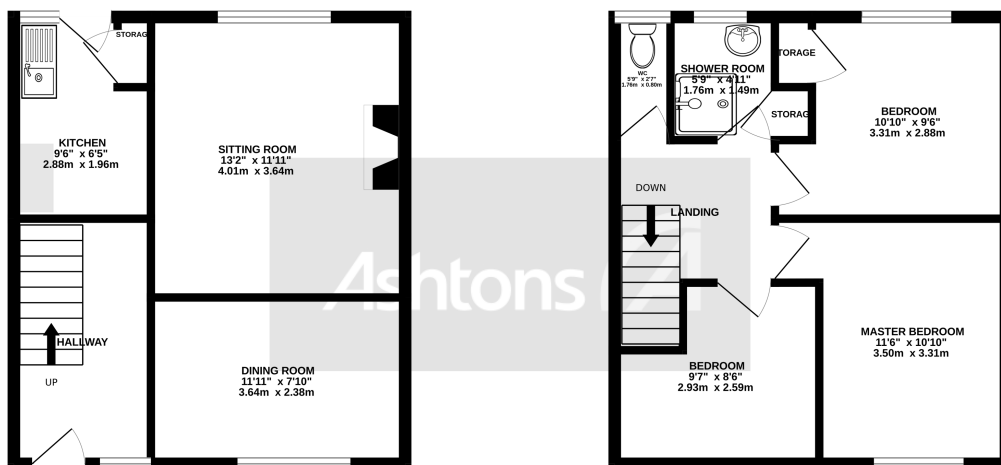

TOTAL FLOOR AREA : 763 sq.ft. (70.9 sq.m.) approx.

Whilst every attempt has been made to ensure the accuracy of the floorplan contained here, measurements of doors, windows, rooms and any other items are approximate and no responsibility is taken for any error, omission or mis-statement. This plan is for illustrative purposes only and should be used as such by any prospective purchaser. The services, systems and appliances shown have not been tested and no guarantee as to their operability or efficiency can be given.

Made with Metropix ©2023

Check out this well-proportioned three bed town house, situated in a popular area in St Helens, the property not only benefits from no onward chain it is close to all local amenities, well-regarded schools and transport links. This is the perfect opportunity for a first time purchase or investment purchase.

In brief, the property comprises spacious entrance hallway with stairs access, leading to the dining room, well-sized sitting room and kitchen. To the first floor, there's two double bedrooms, a smaller third bedroom, shower room and separate WC. Externally, you will find a lovely garden to the front and a well maintainable garden to the rear.

The property is in need of some modernisation, making it perfect for any prospective buyer to come in and make their mark.

Viewings are highly advised. Call to view.

Get a Mortgage: We have an Independent Mortgage Advisor based in EVERY Ashtons Office. We can search over 90 lenders to ensure that we find the most suitable mortgage for your circumstances. Interested? Call your local office. **AS A MORTGAGE IS SECURED AGAINST YOUR HOME, IT COULD BE REPOSSESSED IF YOU DO NOT KEEP UP THE MORTGAGE REPAYMENT**



Contact your local office
to arrange a viewing:

Padgate: 01925 479334
Great Sankey: 01925 454300
Winwick: 01925 232146
Stockton Heath: 01925 453400
St.Helens: 01744 754120
Wigan: 01942 498862
Culcheth: 01925 764744
Ashton-In-Makerfield: 01942 364446
Newton-Le-Willows: 01925 907770
Commercial Office: 01925 907709
Lettings Head Office: 01925 873533
Financial Services: 01925 221234

Viewing Arrangements

Viewing is strictly by appointment only through Ashtons Estate Agency.

Disclaimer Property Details

These particulars, whilst being believed to be accurate are set out as a general outline only for guidance and do not constitute any part of an offer or contract. Intending purchasers should not rely on them as statements of representation of fact, but must satisfy themselves by inspection or otherwise as to their accuracy. We have not carried out a detailed survey nor tested the services, appliances and specific furnishings. The measurements given are approximate. No person in this firm's employment has the authority to make or give any representation or warranty in respect of the property.

All details, photographs and floorplans are the copyright of Ashtons Estate Agency.

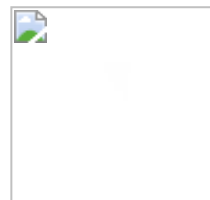

How much you can borrow?
Speak to a mortgage expert in your local office.

Ashtons Financial Services

Ashtons.net rightmove

PrimeLocation.com Zoopla.co.uk

Ashtons