

Truuli



Priory Road, Croydon, Surrey, CR0 3QZ

£350,000 Freehold

- No onward chain
- In need of cosmetic updating
- Large extended kitchen
- Ground floor WC
- Two double bedrooms
- Within easy access to Purley Way retail park

Southbridge Place, Surrey, CR0 4HA

Tel: 0330 043 0002

Email: save@truuli.co.uk Web: www.truuli.co.uk

Priory Road, Croydon, Surrey, CR0 3QZ

£350,000 Freehold

Situated on the ever-popular Priory Road and available with no onward chain, this generously sized two-bedroom property offers an exciting opportunity for buyers keen to personalise and modernise a charming period home.

The property impresses with well-proportioned living space throughout, including a bright and versatile double reception room – ideal for both entertaining and everyday living. To the rear, a thoughtfully extended kitchen provides ample space for culinary enthusiasts or those envisioning a stylish open-plan layout.

A ground floor W/C further enhances the home’s practicality and convenience.

Perfectly suited to first-time buyers, downsizers or investors alike, this characterful home invites you to add your own touch in a prime location.

Priory Road

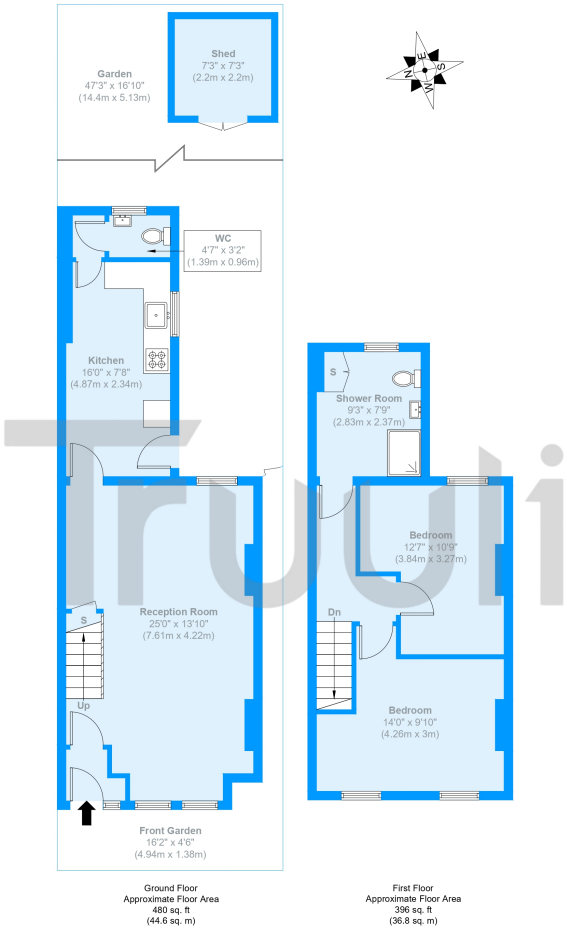

Approximate Gross Internal Area = 81.4 sq m / 876 sq ft
Shed = 4.8 sq m / 52 sq ft
Total = 86.2 sq m / 928 sq ft

The Floor plan is not to scale and measurements and areas shown are approximate and therefore should be used for illustrative purposes only. The plan has been prepared in accordance with the RICS code of Measuring Practice and whilst we have confidence in the information produced it must not be relied on. Maximum lengths and widths are represented on the floor plan. If there is any aspect of particular importance, you should carry out or commission your own inspection of the property.
Copyright © BleuPlan

