



13 Croit Ny Kenzie, Andreas Village, Isle of Man. IM7 4FA

Well presented three bedroom semi-detached home with enclosed good sized garden and off road parking



£285,000 Freehold

PROPERTY DESCRIPTION

Nestled in the heart of Andreas, 13 Croit ny Kenzie presents a charming semi-detached home offering three bedrooms, ideal for a growing family or those seeking a wonderful home in Andreas.

Upon entry, the home exudes a welcoming ambiance, with a spacious and bright living room providing the perfect setting for relaxation and social gatherings. The kitchen/dining room boasts a well-appointed kitchen and ample space for a 4-6 seater dining table. Stepping through double doors, residents are greeted by a generously sized back garden, adorned with well-established apple and plum fruit trees.

Upstairs, the home offers three bedrooms, comprising two good-sized double bedrooms and a single bedroom, catering to various lifestyle needs. Additional storage is provided by an airing cupboard on the landing, ensuring practicality and organization. Completing the upper level is a three-piece bathroom, offering functionality and comfort for daily routines. With its inviting living spaces, ample natural light, and enclosed garden, 13 Croit ny Kenzie presents a wonderful opportunity to embrace the tranquility of living in Andreas.

INCLUSIONS Floor coverings and light fittings.

FEATURES

- Spacious Semi-Detached Home
- Cul-de-Sac Location in Andreas
- Spacious and Bright Lounge
- Kitchen/Dining Room
- 3 Bedrooms plus Family Bathroom
- Enclosed Private Rear Garden
- Off Road Parking for Four Cars
- Gas Fired Central Heating
- Double Glazed Throughout
- Fibre Internet



Property Images



FLOORPLAN



GROUND FLOOR
382 sq.ft. (35.5 sq.m.) approx.

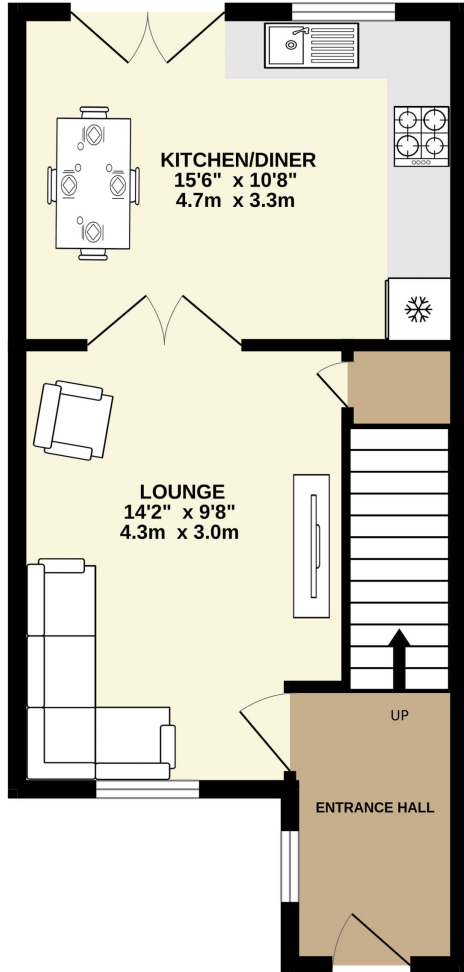

1ST FLOOR
352 sq.ft. (32.7 sq.m.) approx.

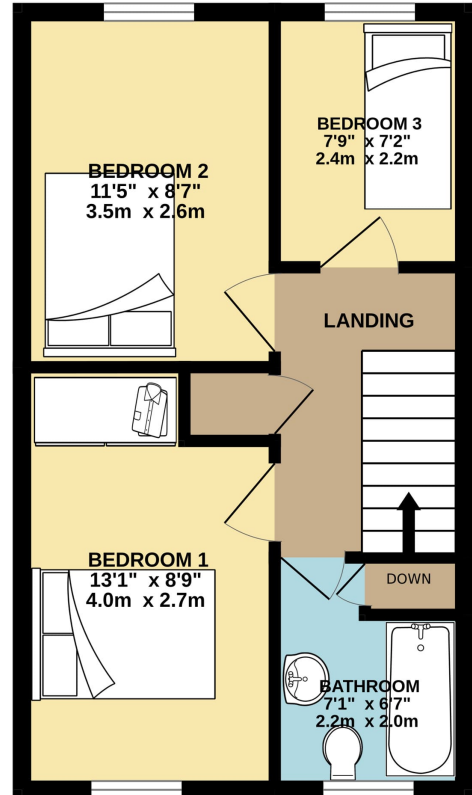

TOTAL FLOOR AREA: 734 sq.ft. (68.2 sq.m.) approx.

Whilst every attempt has been made to ensure the accuracy of the floorplan contained here, measurements of doors, windows, rooms and any other terms are approximate and no responsibility is taken for any error, omission or mis-statement. This plan is for illustrative purposes only and should be used as such by any prospective purchaser. The services, systems and appliances shown have not been tested and no guarantee as to their operability or efficiency can be given.
Made with Metropix ©2024

DISCLAIMER: Whilst Manxmove Ltd believe that these details are correct, neither Manxmove Ltd or their clients guarantee their accuracy in any way. Consequently, these details are not to be used to form part of any legally binding contract. Prospective purchasers or tenants are advised to visit this property to satisfy themselves as to the correctness of these details. Please note, we use wide angle camera lenses in order to show as much of each room as possible. This is not intended to mislead any prospective purchasers or tenants in any way and an honest verbal description is always available prior to viewing if required.