



12 Oberon Apartments Gillsmans Hill, St Leonards-on-Sea, East Sussex, TN38 0SP  
£1,150 pcm





Property Café are delighted to offer to let this well presented apartment which is set in a private gated community, nestled into woodlands just a short distance from local amenities and excellent transport links. Internally the property comprises a spacious lounge with additional private balcony, a large modern kitchen with integrated oven and hob with space for a small dining table, two excellent size double bedrooms and a modern fitted bathroom with white suite, shower over the bath and low level W/C. Further benefits to this well proportioned flat include; Double glazing throughout, underfloor heating, solid oak floors in the hallway and lounge, an allocated parking space for one car and a security entry phone system. The property is available now on a long let and a minimum annual income of £34,500 per household is required to be eligible and internal viewings are highly recommended. For additional details or to arrange your internal viewing, please contact our office on 01424 224488 Option 2.



# GROUND FLOOR

649 sq.ft. (60.3 sq.m.) approx.

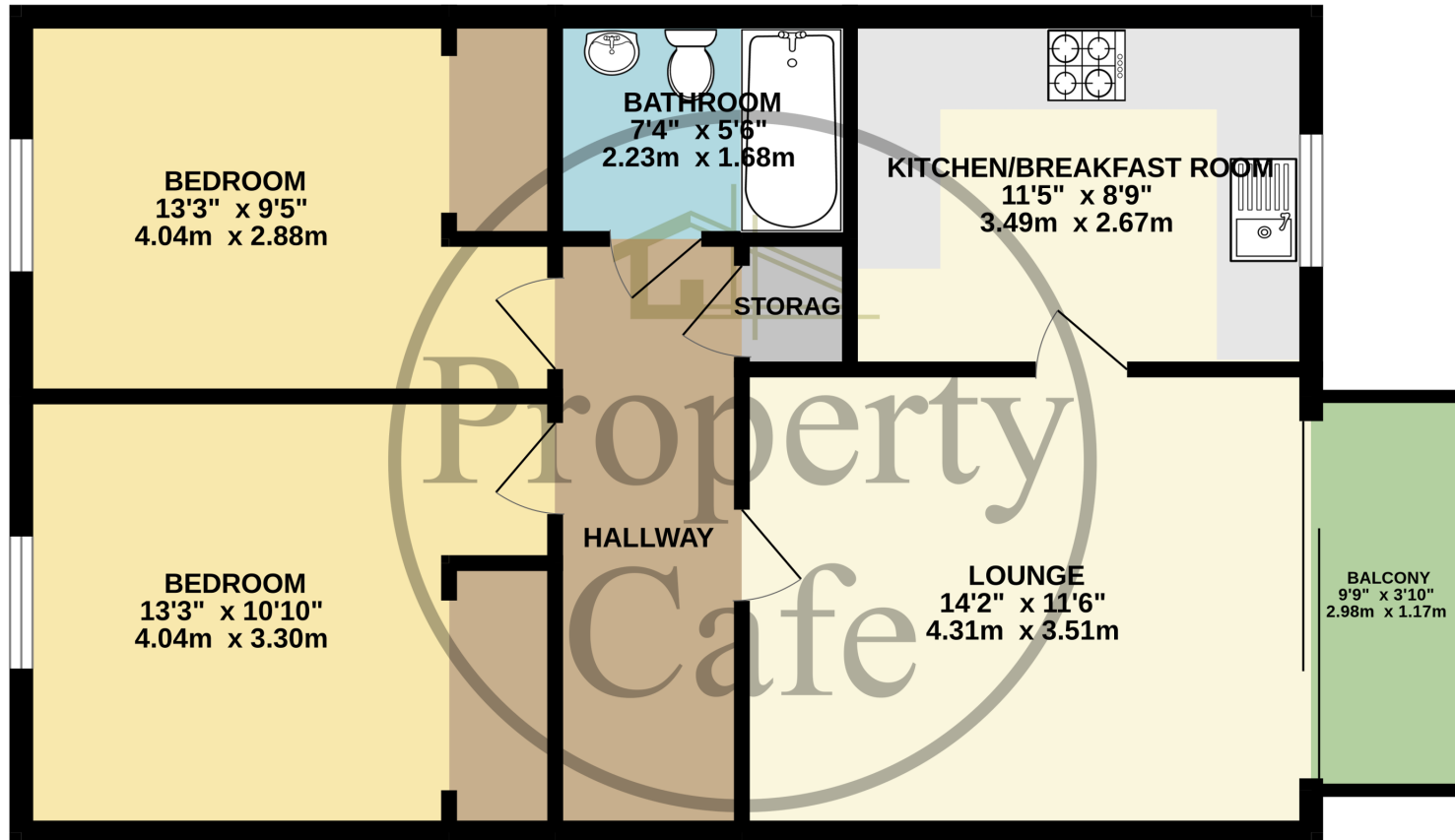

TOTAL FLOOR AREA : 649 sq.ft. (60.3 sq.m.) approx.

Whilst every attempt has been made to ensure the accuracy of the floorplan contained here, measurements of doors, windows, rooms and any other items are approximate and no responsibility is taken for any error, omission or mis-statement. This plan is for illustrative purposes only and should be used as such by any prospective purchaser. The services, systems and appliances shown have not been tested and no guarantee as to their operability or efficiency can be given.  
Made with Metropix ©2024



- Purpose built apartment to let.
- Modern fitted kitchen.
  - Two double bedrooms.
- Allocated parking space.
- Modern fitted bathroom.
- Double glazing and underfloor heating.
- Private balcony and spacious lounge.
  - Private gated development.
- Available now on a long let.
- Entrance hall floor.