



Day & Co
ESTATE AGENTS

28 Cavendish Street
Keighley
BD21 3RG



26 Exley Head, Keighley, West
Yorkshire, BD22 7EH

£143,995

T: 01535 664609

W: www.dayandcoestateagents.co.uk

E: keighley@dayandcoestateagents.co.uk

- Well Presented Terrace Cottage
 - Long Rear Garden & Decking Area
 - Triple Glazing/NO CHAIN
- Two Double Bedrooms
 - Excellent Access To Local Schools & Keighley Town Centre
 - EPC Rating D

SUMMARY

A DECEPTIVELY SPACIOUS 2 DOUBLE BEDROOM TERRACE COTTAGE, POPULAR RESIDENTIAL LOCATION WITH EXCELLENT ACCESS TO LOCAL SCHOOLS & KEIGHLEY TOWN CENTRE!! Having modern fitted kitchen, spacious bathroom, long rear garden with decking area - OFFERED FOR SALE WITH NO ONWARD CHAIN!! EPC rating is D.

FULL DESCRIPTION

Of interest to a variety of buyers is this deceptively spacious two double bedroom terrace cottage situated in the popular residential location of Exley Head with excellent access to local schools and Keighley town centre. The well presented accommodation comprises of an entrance hall giving access to a spacious lounge with triple glazed window to the front, open fire and radiator. The dining kitchen has a range of modern base and wall mounted units, integrated oven, hob and extractor fan, tiled flooring, double glazed window and door leading to the rear garden. To the first floor there are two double bedrooms, and a spacious bathroom having a bath with shower over, WC, wash hand basin, radiator. Externally a long rear garden with decking area. Offered for sale with no onward chain, EPC rating is D.

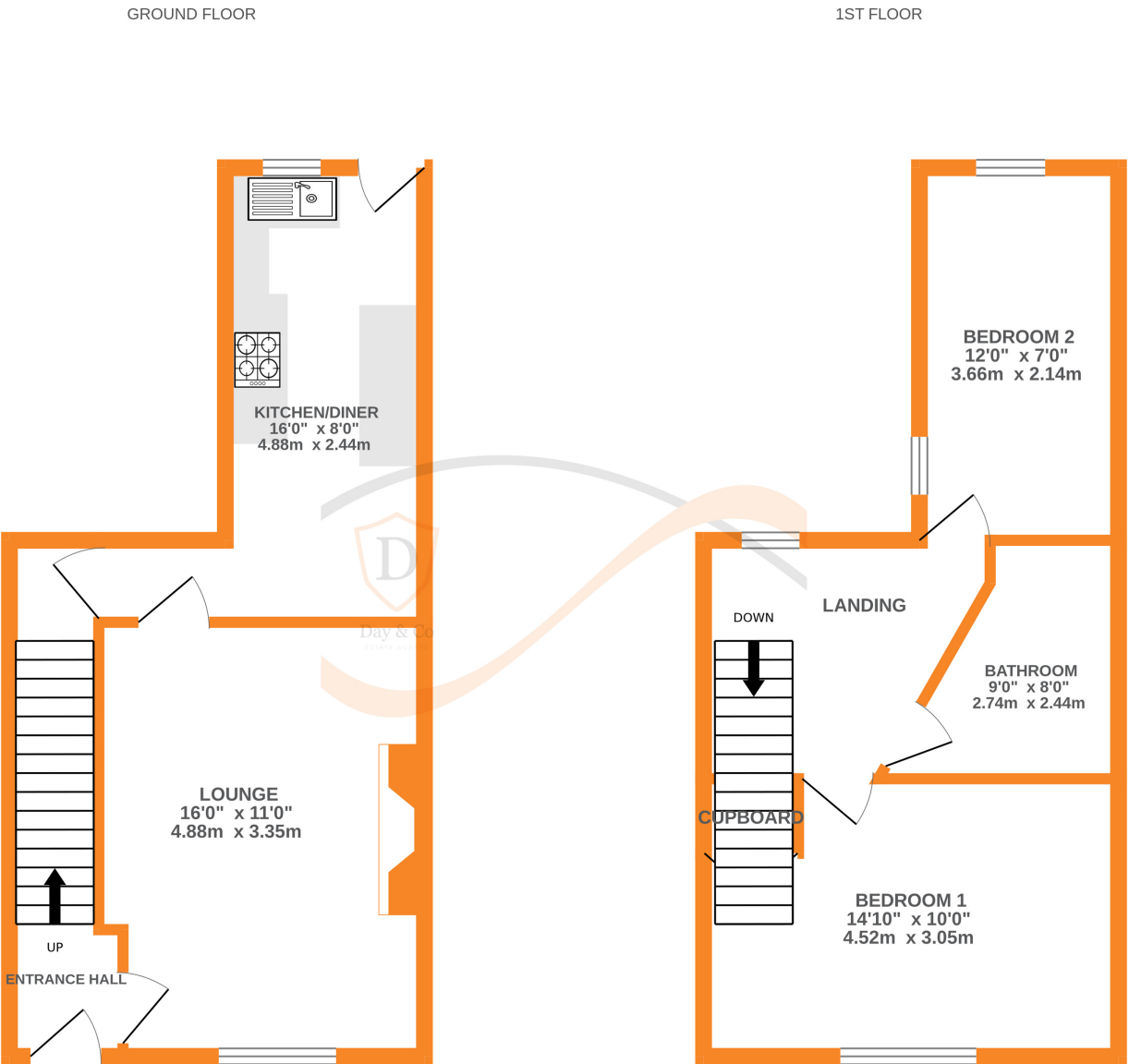

Whilst every attempt has been made to ensure the accuracy of the floorplan contained here, measurements of doors, windows, rooms and any other items are approximate and no responsibility is taken for any error, omission or mis-statement. This plan is for illustrative purposes only and should be used as such by any prospective purchaser. The services, systems and appliances shown have not been tested and no guarantee as to their operability or efficiency can be given.
Made with Metropix ©2023