



13 Broad Street, Clifton, Shefford, Bedfordshire, SG17 5RJ

£185,000

One bedroom mid terraced character cottage in need of updating. Situated in the heart of the village with easy access to local amenities. Offered with lounge, kitchen, an upstairs bathroom and a double bedroom. Outside is a small garden to the rear. Ideal for first time buyers/investors. NO CHAIN Call for a viewing.





# Broad Street Clifton Bedfordshire SG17 5RJ

Approximate Gross Internal Area  
452 sq ft - 42 sq m

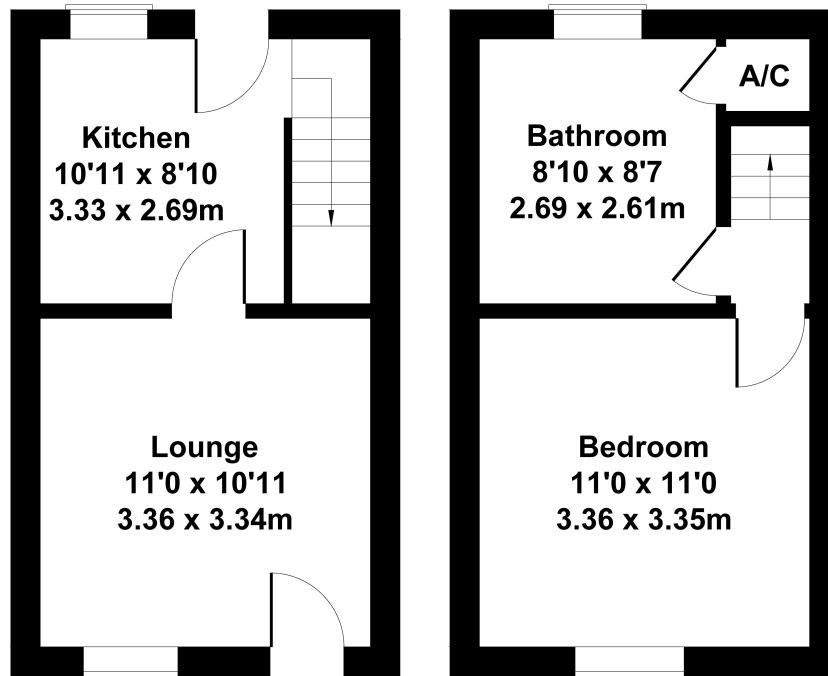

**GROUND FLOOR**

**FIRST FLOOR**

Not to Scale. Produced by The Plan Portal 2023  
For Illustrative Purposes Only.

- ONE BEDROOM COTTAGE
- NO CHAIN
- IN NEED OF MODERNISATION
- KITCHEN WITH DOOR TO GARDEN
- LOUNGE TO FRONT
- LARGE UPSTAIRS BATHROOM
- DOUBLE BEDROOM
- REAR GARDEN
- SITUATED IN THE HEART OF THE VILLAGE  
CLOSE TO THE DUCK POND
- EASY ACCESS TO A1 & ARLESEY TRAIN  
STATION

