



**1/7, Ocean Way, Edinburgh, EH6 7DG**

Beautifully Presented & Spacious Two-Bedroom, First-Floor Apartment with Two Balconies

Up to date price and viewing info at [mov8realestate.com/property](https://mov8realestate.com/property)

**espc** rightmove  **Zoopla**  
find your happy



# Property Description

Beautifully presented and spacious, two-bedroom, first-floor apartment with two balconies and vibrant Leith Docks views. Part of a modern, factored residential development, located in Leith's fashionable Shore district, lying to the north-east of Edinburgh city centre.

Comprises an entrance hall, open plan living/dining room and kitchen, two flexible bedrooms, and a bathroom.

Highlights include a luxury fitted kitchen with integrated appliances, extensive quality flooring, and a generous bathroom. In addition, there is double glazing, gas central heating, and balconies for both the lounge and main bedroom.

This factored development also provides a lift service, a secured entry system, two private parking permits, a shared fitness suite, and garden grounds.

The entrance welcomes you into the property, providing access to all rooms, with the living area set to the rear and designed as an open-plan lounge and kitchen space. Finished with wood-effect flooring and opening onto a balcony, this area is ideal for entertaining. The kitchen continues the stylish wood-effect flooring and is fitted with sleek modern countertops, matching upstands, a tiled-effect splashback, and a sink with drainer, as well as integrated appliances including an oven with electric hob and canopy above, induction hob, and fridge freezer.

Both bedrooms carry the wood-effect flooring throughout and include built-in cupboards for convenient storage, with the main bedroom offering ample space for additional furniture along with its own private balcony. The hallway further benefits from two built-in cupboards, and completing the home is the family bathroom, a well-presented three-piece suite with a shower over bath and a contemporary ladder-style radiator.



## 1/7 Ocean Way, Edinburgh, EH6 7DG

Approximate Gross Internal Area: (646 sq ft - 60 sq m.)

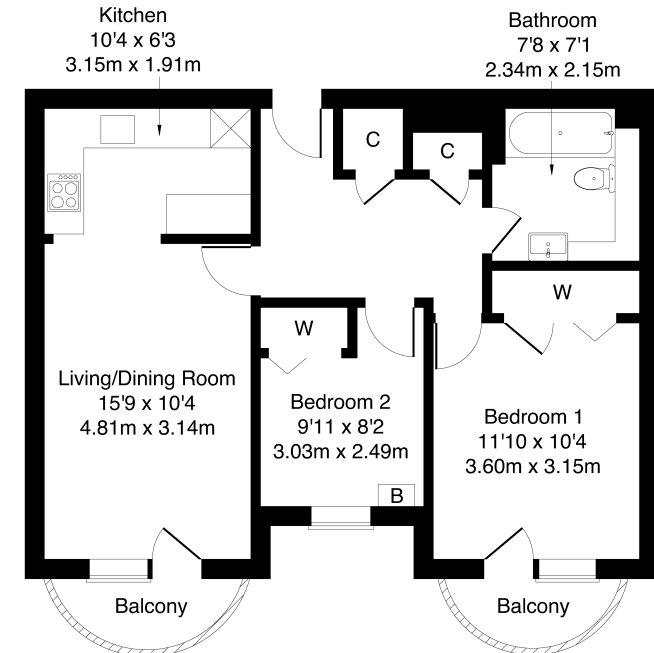

First Floor

Legal Disclaimer : Floor-plan and measurements are for illustrative guidance only, and not intended to form part of any contract.

# Area Description

The Shore is a fashionable and vibrant area located north of Edinburgh city centre, combining historic charm with modern developments. It is renowned for its exceptional selection of local artisan shops and eateries, including several Michelin-starred restaurants. Extensive shopping opportunities are found throughout Leith, with Great Junction Street and the foot of Leith Walk nearby, along with numerous supermarkets. The area hosts weekly markets that showcase local food stalls and independent retailers. For broader retail and leisure options, the Ocean Terminal complex offers

major high-street outlets, a multi-screen cinema, a gym, a spa, and a variety of restaurants. Scenic walks and cycle routes run along the Newhaven shore and the Water of Leith, while Leith Links park provides spacious green areas. Excellent transport connections include frequent services to the city centre and beyond, supported by the new tram extension reaching Newhaven.









## Our Services

-  Free pre-sale property valuations
-  Great value fixed estate agency fees
-  Extensive buyer matching database
-  Purchase and sale conveyancing

## Contact Us

0345 646 0208

[sales@mov8realestate.com](mailto:sales@mov8realestate.com)

[www.mov8.com](http://www.mov8.com)

## Head Office

6 Redheughs Rigg, Edinburgh, EH12 9DQ

## Glasgow Office

77 Renfrew Street, Glasgow, G2 3BZ



Estate Agents and Solicitors



These particulars do not form part of any contract and the statements or plans contained herein are not warranted nor are they to scale. All descriptions, dimensions, areas, reference to condition and necessary permissions for use and occupation and other details are given in good faith, and are believed to be correct, but any prospective purchaser should not rely on them as statements or representations of fact, and any prospective purchaser must satisfy themselves by inspection or otherwise as to the correctness of each of them. The Seller shall not be bound to accept the highest or any offer nor to accept a full offer of the Fixed Price where this is applicable. Approximate measurements have been taken by sonic device and measurements are most often taken to the widest point of any room or space. Services and appliances have not been tested for efficiency or safety and no warranty is given as to their compliance with any Regulations. Offers should be made using the Combined Standard Clauses.