

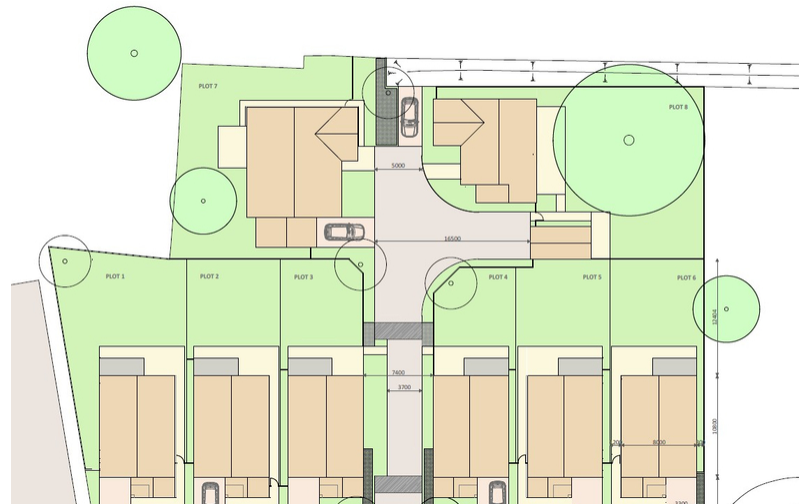

**Land At Brewin Oaks, City Road, March, Cambridgeshire PE15 9LT**

**P.O.A.**



\*\*\* RESIDENTIAL DEVELOPMENT SITE \*\*\* Full planning approved for 6 x 2 Storey 4 bedroom dwellings and 2 x 2 storey 3 bedroom dwellings. Located in the Heart of March. The site benefits from reserved matters approval F/YR22/0944/FDL via Fenland District Council. Full plans available.

## MARCH

March, one of the Fens largest and finest towns, still retains much of its Georgian charm. The bustling town centre has plenty of bars and restaurants and the wide main street (Broad Street) is lined with a mix of national and independent shops and eateries. A weekly market is held every Wednesday, just south of the river, in front of the town's superb brick and stone built town hall (1900).

March is blessed with a good number parks and green open spaces but it is best known for its pleasant riverside setting. The course of the Old River Nene (part of the Nene-Ouse Navigation), meanders through the centre. Narrow boats and other pleasure craft can often be seen cruising along this quiet stretch of the river, where there are good moorings. The course of the navigation affords many attractive riverside walks.

## PLANNING APPROVAL

F/YR22/0944/FDL | Reserved Matters application relating to detailed matters of access, appearance, landscaping, layout and scale pursuant to outline planning permission F/YR20/1022/FDL to erect 8 x dwellings (2 x 2-storey 3-bed and 6 x 2-storey 4-bed) | Land South Of Brewin Oaks City Road March Cambridgeshire

## AGENTS NOTE

All Plans are provided from the developer as part of the planning process. Buyer are advised to check all individual plans before committing to purchase.

