



King Street, London, W6 0SP

Cow & Co
LONDON



The apartment has been interior designed to a very high specification and comprises a modern fully fitted open plan kitchen/diner, reception room and modern separate bathroom. Further features include two bay sash windows, video entry phone and hardwood flooring.

Local amenities of Chiswick High Road are a stone's throw away. Transport links: Stamford Brook and Ravenscourt Park tube stations (District line) located a 2 minute walk away.



- Shops
- Recycling
- Parking
- Lifts
- Available furnished or unfurnished
- Digital TV
- CCTV

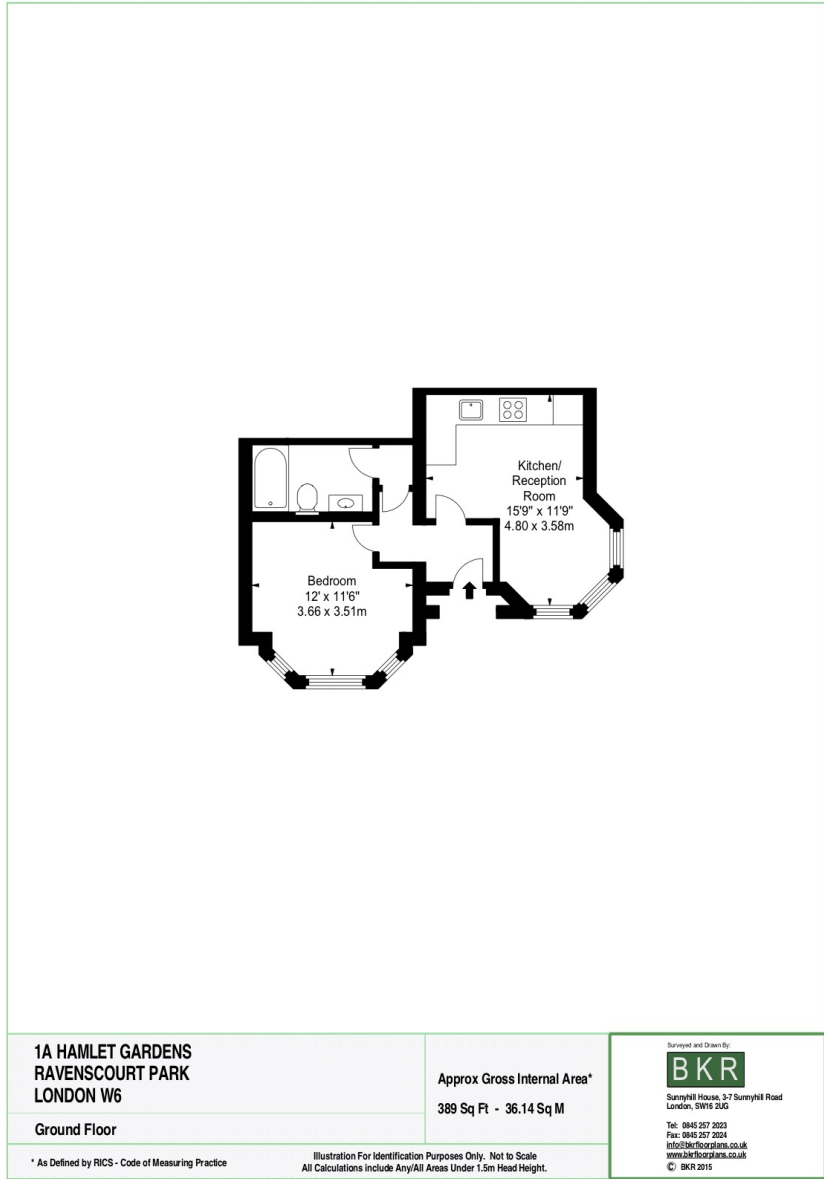

Tel: 0208 065 0010
 Email: thehub@cowandco-london.com
 Web: cowandco-london.com

Agents note: All measurements are approximate and whilst every attempt has been made to ensure accuracy they are for general guidance only and must not be relied on. The fixture and fittings referred to have not been tested and therefore no guarantee can be given that they are in working order. Internal photographs are reproduced for general information and it must not be inferred that any item shown is included with the property.

Cow & Co
 LONDON