



Rysley, Little Baddow, CM3 4DD

Council Tax Band E (Chelmsford City Council)



Guide Price £900,000 - £950,000 Freehold

Guide Price £900,000 - £950,000

This impressive property which has been transformed from original stables, designed by the current owners, to create a property offering modern convenience with charm and character on a plot circa 1/3 acre with lovely views over open country side.

ACCOMMODATION

The property offers modern open plan living with a generous reception hall with built in storage, leading to a spacious living and dining area, open to the well equipped kitchen boasting a large central island, integrated appliances, granite worktops, and a sonos sound system, ideal for relaxing and entertaining. Adjacent to the kitchen area is a useful utility room.

There are three bedrooms, the main bedroom enjoys a dressing room, as well as an ensuite shower room, there is another bedroom with ensuite cloakroom wc, which could also be utilised as an office situated at one end of the property. The remaining bedroom is situated adjacent to the bathroom wc.

The property benefits from underfloor heating and the principle rooms enjoy air conditioning to add to the comfort and enjoyment.

Mains gas, electricity, water and drainage are available.

OUTSIDE

The property is accessed via an electric gated entrance, leading to a spacious shingle parking area with ample room for numerous vehicles. There is a paved terrace in front of the property with a covered built in external kitchen, with integrated gas bbq, electric connected and space for fridge and a plumbed in sink unit creating a wonderful space for entertaining and al fresco dining, with rolling countryside beyond.

Towards the rear of the garden is an impressive oak framed annex barn with a two bay garage and a separate workshop area, with services connected as well as plumbing for a wc. The rest of the garden is neatly laid to lawn, with a hot tub area adjacent to the annex barn, with wonderful views over adjoining countryside.

This property is unique, presented in excellent order, built using quality materials in sympathy with the surroundings, situated in a wonderful tranquil location with views over the adjoining countryside.

AGENTS NOTE:

There is an overage on the land where the double garage is built. This overage is for a period of 30 years from October 2020 and is only triggered if a residential property was built on this part of the garden. Call for more details.

- Occupying a plot circa 1/3 acre
- Open plan living converted stables
- Sonos sound system in kitchen and garden area
- Outdoor kitchen with electric and water connected and fitted gas BBQ
- No Onward Chain
- Main bedroom with dressing room and ensuite
- Oak frame barn with two bay garage plus workshop
- Tranquil location overlooking countryside
- Electric gated driveway with parking for numerous vehicles









Approx. Gross Internal Area 1346 Sq Ft - 125.05 Sq M
(Excluding Outbuilding)
Approx. Gross Internal Area Of Outbuilding 678 Sq Ft - 62.99 Sq M

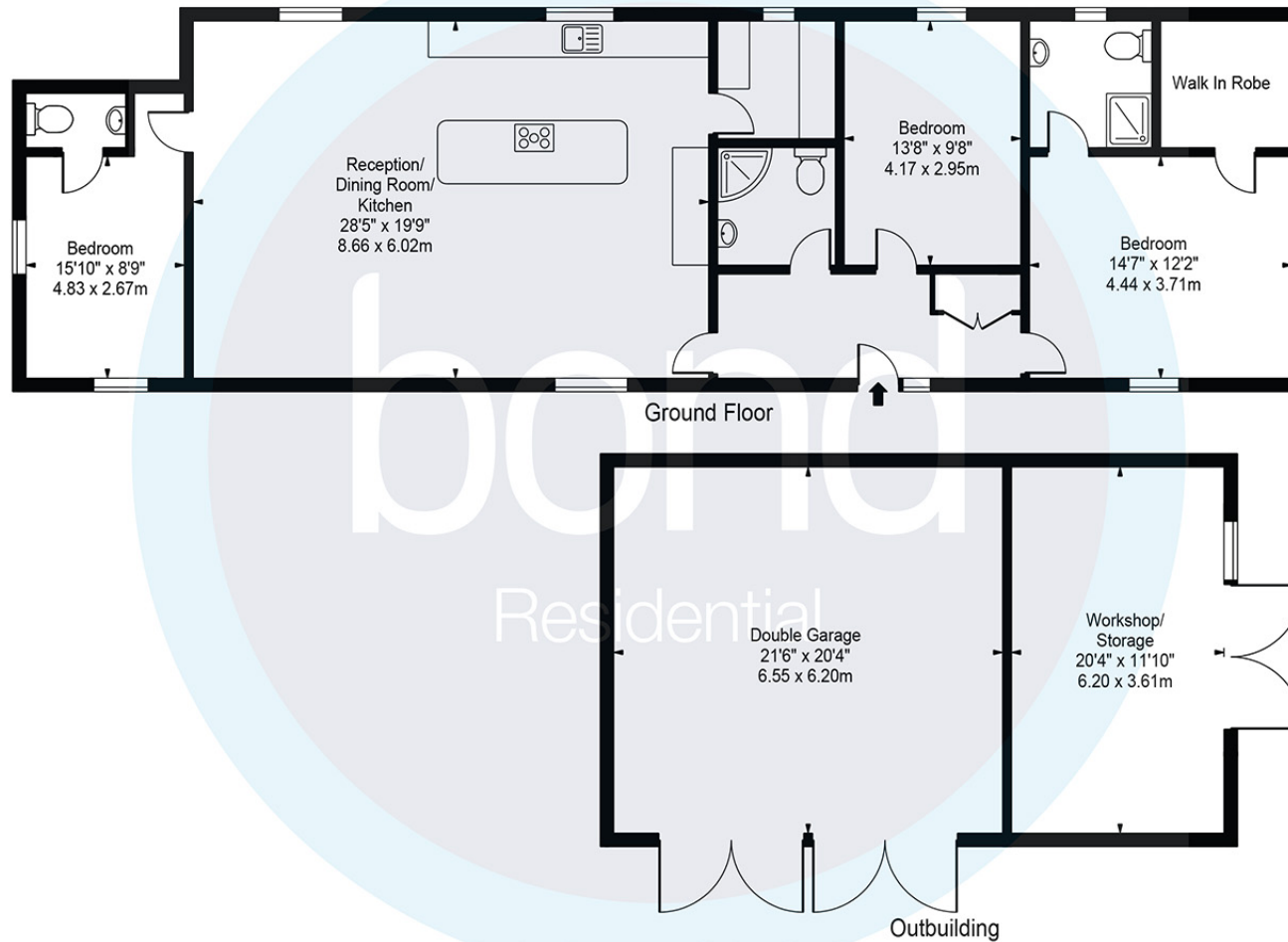

For Illustration Purposes Only - Not To Scale

This floor plan should be used as a general outline for guidance only and does not constitute in whole or in part an offer or contract. Any intending purchaser or lessee should satisfy themselves by inspection, searches, enquiries and full survey as to the correctness of each statement. Any areas, measurements or distances quoted are approximate and should not be used to value a property or be the basis of any sale or let.

10, Maldon Road,
Danbury, Essex, CM3 4QQ
Telephone: 01245 222856
Website: www.bondresidential.co.uk

Consumer Protection from Unfair Trading Regulations 2008 and the Business Protection from Misleading Marketing Regulations 2008. Bond Residential have made every effort to ensure that consumers and/or businesses are treated fairly and provided with accurate material information as required by law. We have not tested any apparatus, equipment, fixture, fitting or any services and as such are unable to verify they are in working order, fit for their purpose, or within the ownership of the seller or landlord. Neither have we been able to check the legal documentation to verify the legal status of the property. We therefore advise potential buyers or tenants to verify these matters with their own solicitors or other advisers.

