



Three Bedroom Detached House
Wigmore Road, Wigmore, Gillingham, Kent, ME8 0SP

Guide Price £425,000
Freehold

Wigmore Road, Wigmore, Gillingham, Kent, ME8 0SP

Guide Price £425,000

Freehold

Description

Guide Price £425,000 - £450,000. Spacious Three Bedroom Detached Home in Highly Sought-After Wigmore, Gillingham!

This fantastic property is packed with potential! Nestled in the desirable Wigmore area, this detached three bedroom home offers space, charm, and an exciting opportunity to make it your own.

Step inside through the welcoming porch with access to the garage, handy W/C and opening into a bright and airy through lounge-dining room, perfect for entertaining. The well-appointed kitchen provides easy access to the garden, while the sunny conservatory is an ideal spot to relax. Upstairs, you'll find three generously sized bedrooms, with ample space for furniture, one even boasts its own private balcony overlooking the front of the home! The spacious family shower room completes the upper level.

Outside, the impressive west-facing mature rear garden is a paradise for garden lovers, featuring a pergola, patio space, a handy shed, and lush trees and plants! The large driveway easily accommodates multiple vehicles, with plant borders and a stunning Palm Tree adding a touch of greenery.

This is the perfect project to add your own creative touch. Don't miss out, call the Greyfox Sales Team in Rainham today to book your viewing!

Key Features

- Chain Free In Sought After Wigmore
- Detached Family Home
- Scope For Further Development (STRPP)
- Perfect Property To Add Your Own Creative Touch
- Three Generously Sized Bedrooms
- Integral Garage & Driveway For Multiple Vehicles
- Mature Rear Garden Measuring Approx 70ft x 28ft
- Great Access To Motorway Links, Public Transport, Schools & Amenities

Local Area

Wigmore is a popular residential area to the south of Gillingham and east of Hempstead, Initially a small holding area the location has grown and offers a variety of amenities, good connections to the A2/M2, M25 and Bluewater. The local rail station is located at Rainham with good access to London.

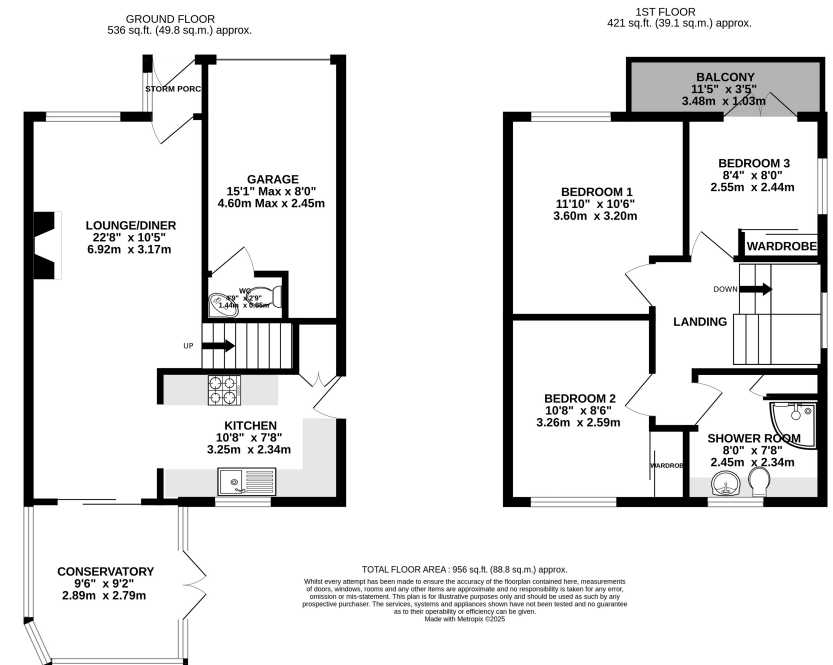



Property Location

Wigmore Road, Wigmore, Gillingham, Kent, ME8 0SP

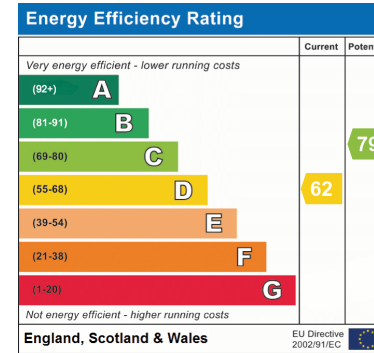
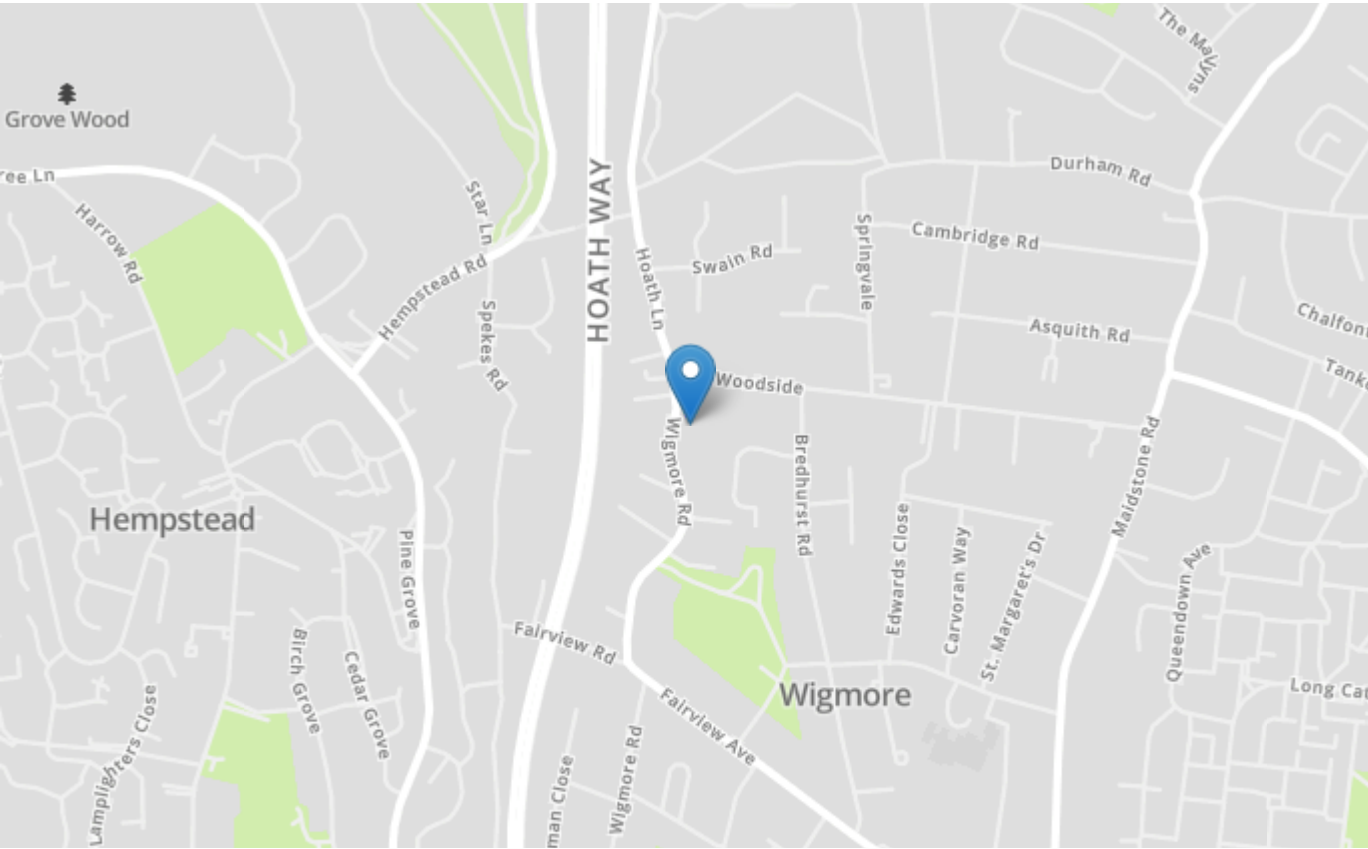

Tenure	Freehold
Lease Term	N/A
Ground Rent	N/A
Service Charge	N/A
Local Authority	Medway
Council Tax	Band E

Greyfox Walderslade

Unit 2, Thetford House
Walderslade Village Centre
Walderslade Road
Chatham
Kent
ME5 9LR
Tel: 01634 672227 Email:
walderslade@greyfox.co.uk

Greyfox Rainham

67C High Street
Rainham
Kent
ME8 7HS
Tel: 01634 377737 Email:
rainham@greyfox.co.uk

Agent Notes

These particulars are prepared as a general guide to a broad description of the property and should not be relied upon as a statement or representation of fact and do not constitute part of an offer or contract. The seller does not make or give nor do our employees or Greyfox have authority to make or give any representation or warranty to the property. We have not carried out a structural survey and the services, appliances and specific fittings have not been tested. All photographs, measurements, floorplans and distances referred to are given as a guide only and should not be relied upon for the purchase of carpets or any other fixtures or fittings. Lease details, service charges and ground rent (where applicable) and council tax are given as a guide only and should be checked and confirmed by you on inspection and your solicitor prior to exchange of contracts. If there are any points of particular importance to you we will be pleased to check the information for you and to confirm that the property remains available. This is particularly important should you be travelling some distance to view and where statements have been made by us to the effect that the information has not been verified. The copyright of all details, photographs and floorplans remain exclusive to Greyfox. For details of our privacy policy and referral fee arrangements with any of our selected partner companies please visit <https://www.greyfox.co.uk/legal/privacy> and <https://www.greyfox.co.uk/referral-fees>.