

Flat 2, 19 Eversley Park

Folkestone
CT20 3FE

£320,000 LEASEHOLD

FOR SALE WITH BURNAP + ABEL... Welcome to your new home in the exclusive gated community of Eversley Park. This two bedroom first floor flat is in excellent condition throughout, offering a modern and stylish living space for you and your family. The master bedroom features an en-suite bathroom for added convenience, while a second family bathroom ensures there's plenty of room for all. With close proximity to the station, commuting has never been easier. Don't miss out on this opportunity to live in luxury in Eversley Park - schedule a viewing today and make this house your own! For your chance to view call SOLE agent Burnap and Abel now on 01303 258590. This property is being sold with no onward chain.



Entrance Hall

Lounge/Dining Room

18' 8" x 13' 1" (5.69m x 3.99m)

Kitchen

16' 6" x 9' 0" (5.03m x 2.74m)

Bedroom

16' 5" x 11' 10" (5.00m x 3.61m)

En-suite

Bedroom

13' 7" x 11' 3" (4.14m x 3.43m)

Bathroom

9' 1" x 5' 11" (2.77m x 1.80m)

First Floor
Approx. 96.7 sq. metres (1040.9 sq. feet)

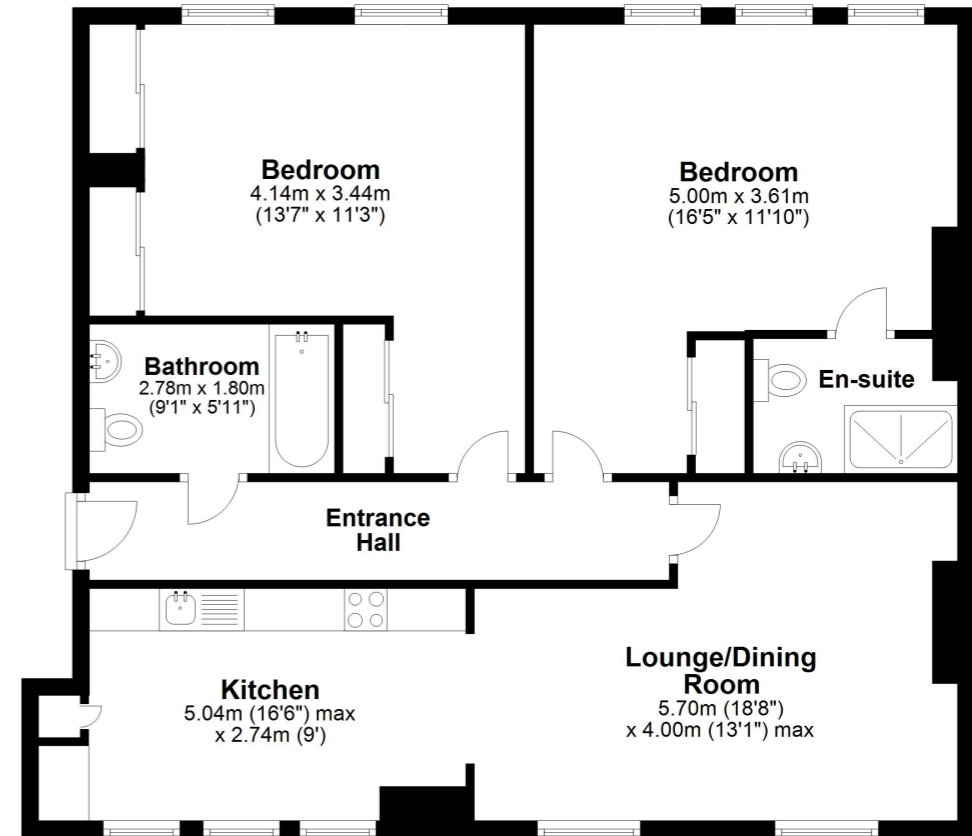

Total area: approx. 96.7 sq. metres (1040.9 sq. feet)

Whilst every attempt has been made to ensure the accuracy of the floor plan contained here, measurements of doors, windows, rooms and any other items are approximate and no responsibility is taken for any error, omission or mis-statement. This plan is for illustrative purposes only and should be used as such by any prospective purchaser.
Plan produced using PlanUp.

