



Amesbury Road,

Bickley, Kent. BR1 2QJ

Tenure: Freehold

4 Bedrooms | 2 Reception Rooms | 2 Bathrooms

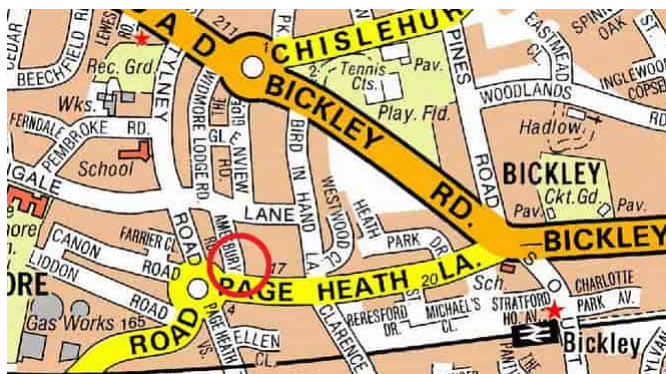

EXCLUSIVE TO GEORGE PROCTOR & PARTNERS. Located on a sought-after residential road, within close proximity of Bickley Station is this charming Edwardian semi-detached home which offers a wonderful blend of period elegance and modern family living. Having been extended by the current owners, the property now features four generously sized bedrooms, two well-appointed bathrooms, a convenient ground floor cloakroom, separate living and dining rooms, whilst externally there is a secluded easterly-facing rear garden which provides a tranquil retreat. EPC Rating: D

Enquiries To:

T: 020 8467 2252

E: beosales@georgeproctor.com



The Bickley Estate Office

Southborough Road, Bickley, Kent, BR1 2EB

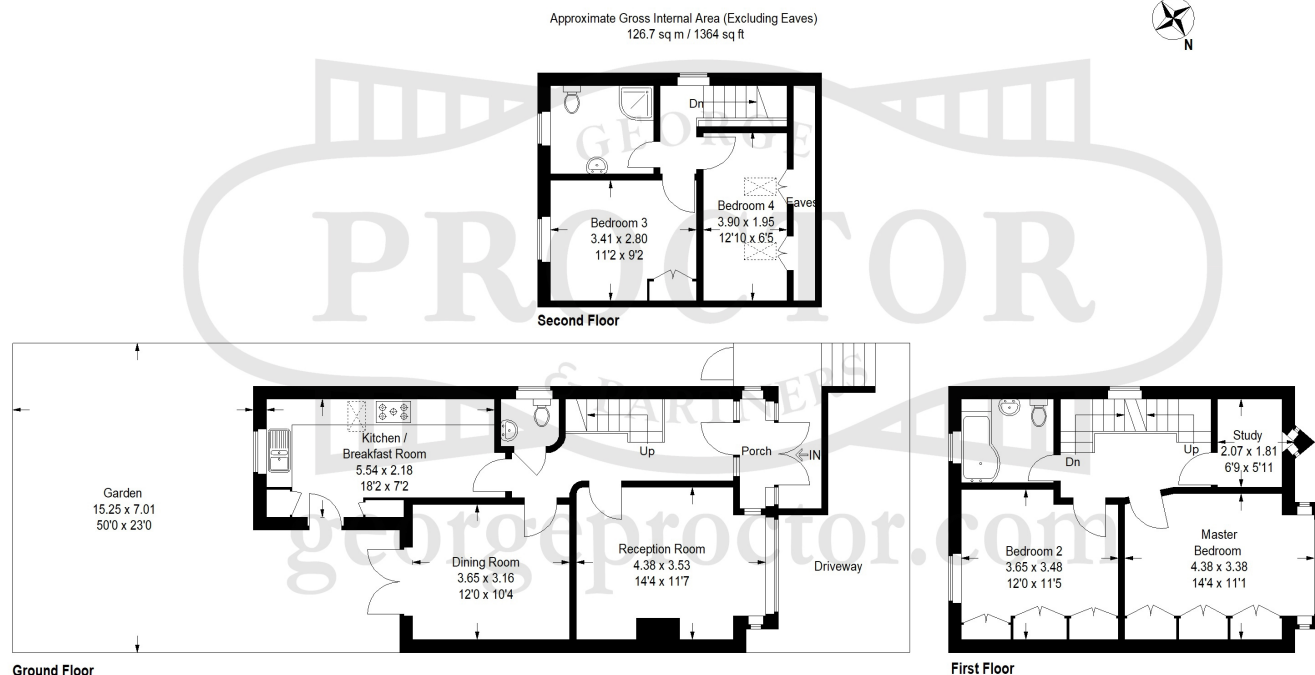

These particulars whilst believed to be accurate are made without responsibility on the part of the vendor or agents, their accuracy is not guaranteed nor do they form part of any contract and no warranty is given. Services or appliances have not been tested and no guarantee can be given as to their operation, buyers should seek professional advice where necessary. All measurements are approximate and may be rounded to the nearest three inches (10 cm). Floor plans, where shown, are indicative only. Any photographs included may be taken with the use of a wide angle lens. If there is a matter of particular interest please contact us for further information, especially before travelling any distance to view. Map reproduced by permission of Geographers A-Z Map Co Ltd. Licence No. A0514. This map is based upon Ordnance Survey maps with the permission of the controller of Her Majesty's Stationary Office.