



- One Bedroom Retirement Bungalow
- French Doors To A Private Courtyard Style Garden
- Generous Living Room/Diner With Integrated Appliances
- 24 Hour Emergency Call System
- Complete Onward Chan
- Residents' Pavillion including Lounge, Library, Conference Room and Guest Suite
- Over 55's Only
- Service Charge - £236 Per Month & Ground Rent - £350 Per Annum

### 30 Meadow Park, Braintree, Essex. CM7 1TD.

Michaels Property Consultants are delighted to present to the market this deceptively spacious and well proportioned one bedroom bungalow occupying an excellent position within the sought after Meadow Park Village, an over 55s development consisting of just 55 properties. New to the market and offered for sale with a complete onward chain, this well presented home is conveniently positioned South of the Braintree town centre, with the development itself offering an excellent range of amenities including a residents lounge, a library, and a guest suite for visiting friends & family.



Call to view 01376 337400



# Property Details.

## Accommodation

### Entrance Hall

### Kitchen/Living/Diner

25' 10" x 11' 5" (7.87m x 3.48m)

### Shower Room

### Bedroom

11' 7" x 11' 5" (3.53m x 3.48m)

## Outside

### Courtyard Style Garden





# Property Details.

## Floorplans

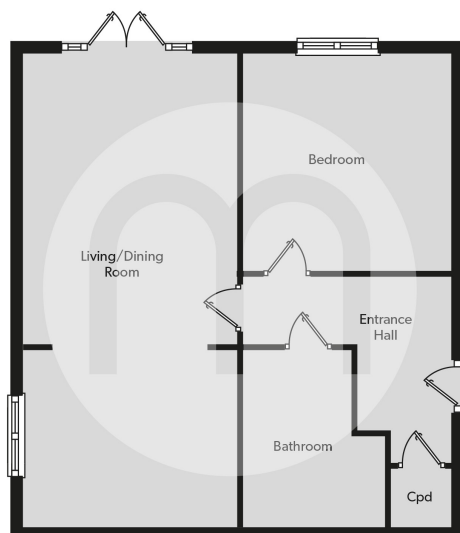

## Location

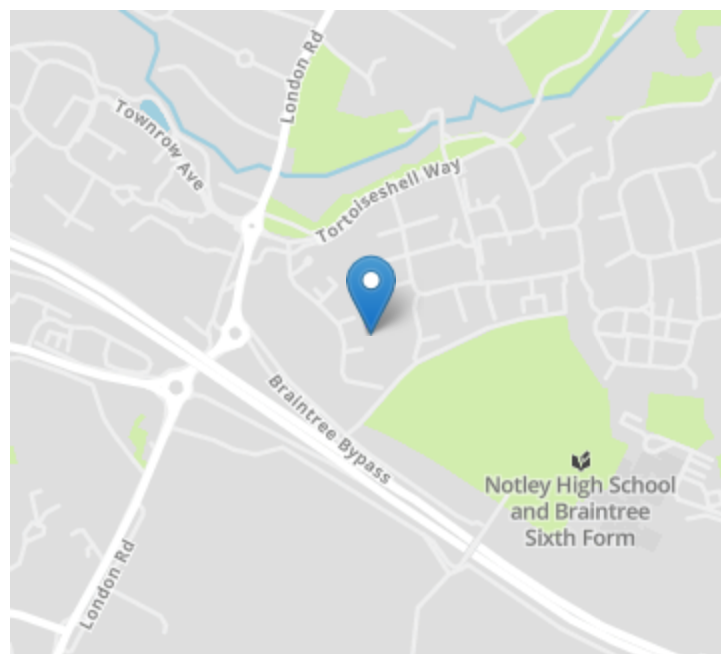

## Energy Ratings

We have not carried out a structural survey and the services, appliances and specific fittings have not been tested. All photographs, measurements, floor plans and distances referred to are given as a guide only and should not be relied upon for the purchase of carpets or any other fixtures or fittings. Gardens, roof terraces, balconies and communal gardens as well as tenure and lease details cannot have their accuracy guaranteed for intending purchasers. Lease details, service ground rent (where applicable) are given as a guide only and should be checked and confirmed by your solicitor prior to exchange of contracts.