



WINKLEY COURT, EASTCOTE LANE, HARROW

£1,850 pcm

**** AVAILABLE 05/08/2024 **** A well maintained two double bedroom mid terrace house conveniently located for shops, schools and transport links. The property briefly comprises welcoming entrance hall, large lounge with sliding doors to private rear garden, modern fitted kitchen with appliances, two double bedrooms and family bathroom. Other benefits include gas central heating, double glazing, porch and garage to the rear of the property.

- TWO DOUBLE BEDROOMS
- MIDDLE TERRACE HOUSE
- SPACIOUS LOUNGE
- FITTED KITCHEN
- PRIVATE REAR GARDEN
- GARAGE
- GAS CENTRAL HEATING AND DOUBLE GLAZING
- CONVENIENTLY LOCATED FOR SHOPS, SCHOOLS AND TRANSPORT LINKS
- AVAILABLE 05/08/2024

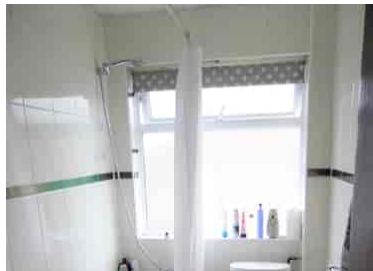

DISCLAIMER: These particulars, whilst believed to be accurate are set out as a general outline only for guidance and do not constitute any part of an offer or contract. Intending purchasers should not rely on them as statements or representation of fact, but must satisfy themselves by inspection or otherwise as to their accuracy. We have not carried out a detailed survey nor tested the services, appliances and specific fittings. Room sizes should not be relied upon for carpets and furnishings. The measurements given are approximate. No person in this firms employment has the authority to make or give any representation or warranty in respect of the property.

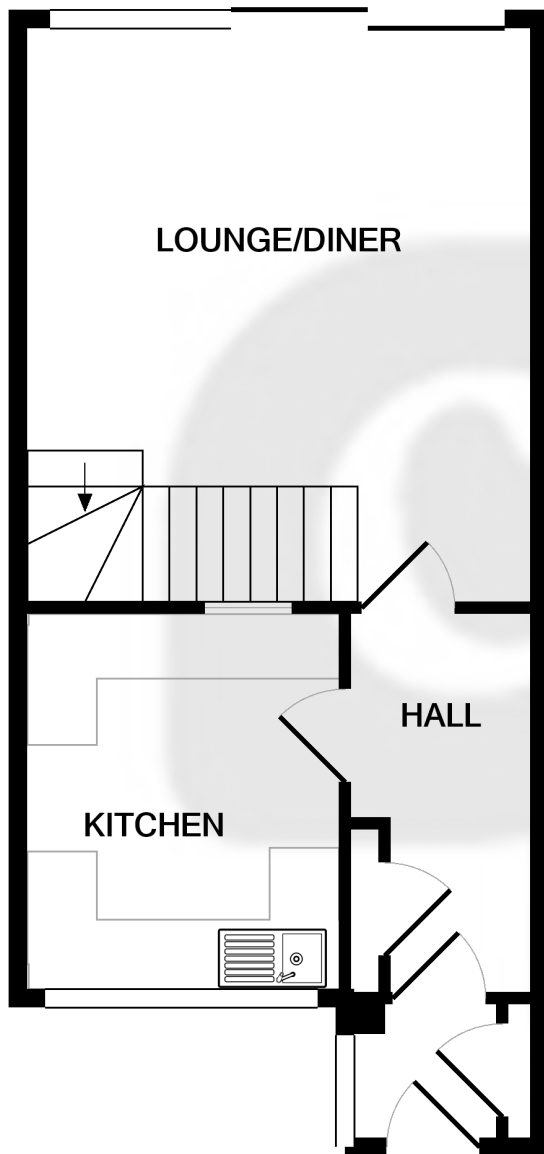

GROUND FLOOR

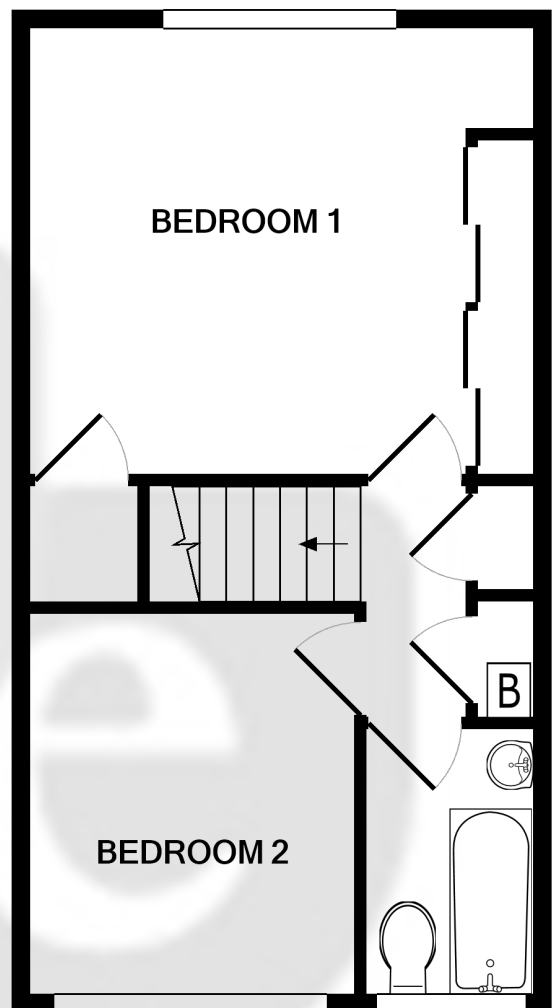

1ST FLOOR

Whilst every attempt has been made to ensure the accuracy of the floor plan contained here, measurements of doors, windows, rooms and any other items are approximate and no responsibility is taken for any error, omission, or mis-statement. This plan is for illustrative purposes only and should be used as such by any prospective purchaser. The services, systems and appliances shown have not been tested and no guarantee as to their operability or efficiency can be given
 Made with Metropix ©2019