



14 High View Road, Farnborough, Hampshire GU14 7PU

£525,000 Freehold

Jigsaw Estates Hampshire are delighted to offer to the market this wonderful, four bedroom, Victorian semi-detached house situated on a quiet road within walking distance of Farnborough town centre and Farnborough Main station which offers a number of fast services to London. The ground floor comprises; an entrance hall with exposed wooden floorboards, living room with feature bay window and fireplace, a spacious refitted family bathroom room and a beautiful refitted open-plan kitchen/family room with kitchen island and french doors leading to the rear garden. On the first floor there are two double bedrooms and a generously sized refitted family shower room. On the second floor there are two further bedrooms. Outside is a large, secluded rear garden with designated patio, decked and astro-turfed areas, and an outbuilding which could potentially be used as a garden office. To the front is a driveway and side access to the rear garden. Also within walking distance are a number of schools and the Farnborough town centre which has had many improvements in recent years. Mis-descriptions Act: We wish to inform prospective purchasers that we have not carried out a detailed survey or tested the services, appliances and specific fittings including any heating system for this property. Floorplans shown are for illustrative purposes only and are not drawn to scale.



- VIDEO TOUR AVAILABLE!
- CLOSE TO FARNBOROUGH TOWN CENTRE
- VICTORIAN SEMI DETACHED
- REFITTED OPEN PLAN KITCHEN/FAMILY ROOM
- CLOSE TO FARNBOROUGH STATION
- LARGE SECLUDED REAR GARDEN
- FOUR BEDROOMS
- REFITTED BATHROOMS

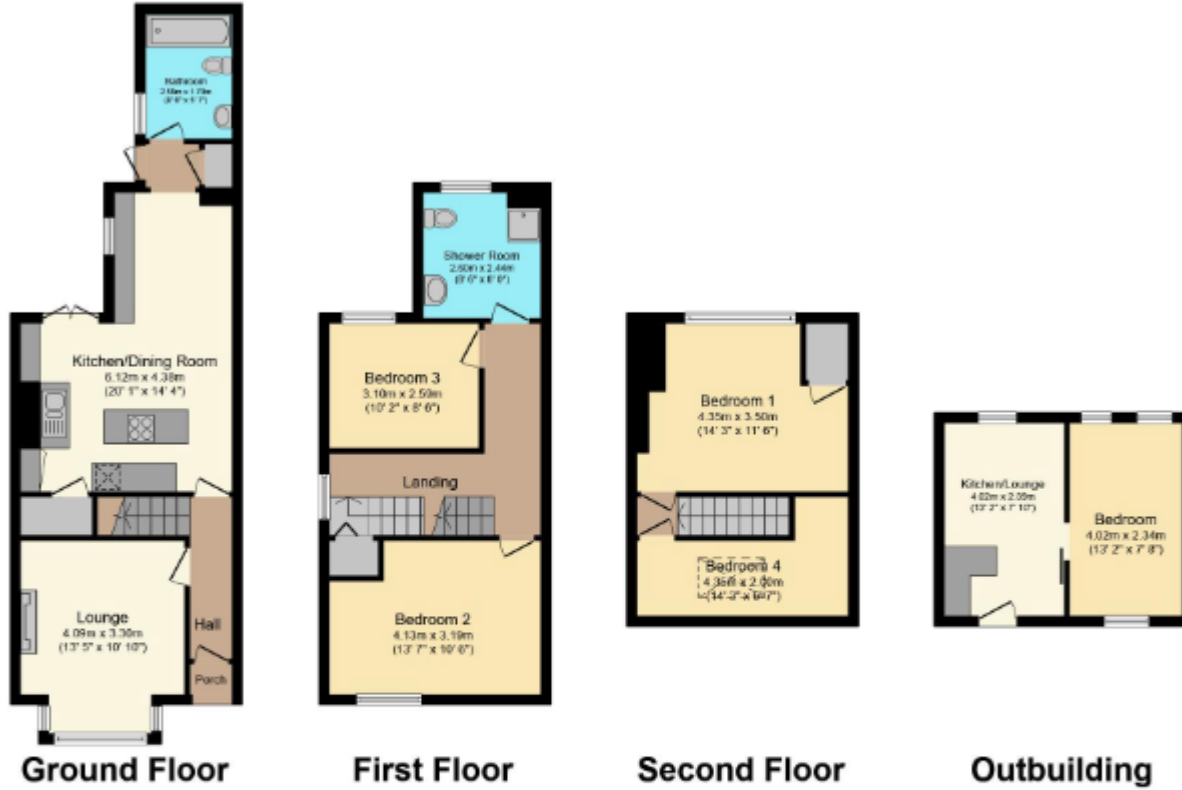

Energy Efficiency Rating		Current	Potential
<i>Very energy efficient - lower running costs</i>			
(92 to 100)	A		
(81 to 91)	B		
(69 to 80)	C		79
(55 to 68)	D	62	
(39 to 54)	E		
(21 to 38)	F		
(1 to 20)	G		
<i>Not energy efficient - higher running costs</i>			
England, Wales & N.Ireland		EU Directive 2002/91/EC	



Total floor area 135.1 sq.m. (1,454 sq.ft.) approx

This floor plan is for illustrative purposes only. It is not drawn to scale. Any measurements, floor areas (including any total floor area), openings and orientation are approximate. No details are guaranteed, they cannot be relied upon for any purpose and they do not form part of any agreement. No liability is taken for any error, omission or misstatement. A party must rely upon its own inspection(s). Plan produced for Purple Bricks. Powered by www.focalagent.com

