



## 6/28, Portland Gardens, Edinburgh, EH6 6NJ

Tastefully Presented Two-Bedroom, Sixth-Floor Quayside Apartment with Private Balcony

Up to date price and viewing info at [mov8realestate.com/property](https://mov8realestate.com/property)

espc rightmove<sup>®</sup> find your happy Zoopla

# Property Description

Tastefully presented and spacious, a two-bedroom, sixth-floor quayside apartment with a private balcony and open skyline views. Set in a modern, factored residential development, located in the popular Leith area, north of Edinburgh city centre.

Comprises an entrance hallway, open-plan living/dining room and kitchen, master bedroom with en-suite bathroom, a double bedroom, and a shower room.

Highlights include a fully integrated kitchen, fitted bathroom suites, extensive quality hardwood flooring, and contemporary lighting. In addition, there is double glazing, gas central heating, a bespoke 'Murphy bed' for bedroom two and superb storage provision.

The development also offers a lift service, communal grounds, a secure entry system, visitor spaces, and a shared bike storage facility.

An inviting entrance hall leads you seamlessly into the home, offering access to every room with ease. The open-plan living and kitchen area provides a comfortable, versatile layout, enhanced by wood-effect flooring and a generous box window that creates an ideal space for a dining nook. The kitchen features a contemporary worktop and coordinating splashback, a stainless-steel sink with drainer, and a full range of integrated appliances, including a range cooker with hob and canopy, washing machine, dishwasher, and fridge/freezer, while also granting direct access to the balcony—perfect for extending the entertaining space.

Both the main and master bedrooms are carpeted and enjoy built-in cupboards for convenient storage, with the second bedroom further benefiting from a practical Murphy bed that adds flexibility to the room. The master bedroom also includes an ensuite bathroom fitted with an electric shower over the bath, and completing the property is a well-presented family shower room arranged as a modern three-piece suite with a shower cubicle.



**6/28, Portland Gardens, Edinburgh, EH6 6NJ**

Approximate Gross Internal Area: (829 sq ft - 77 sq m.)

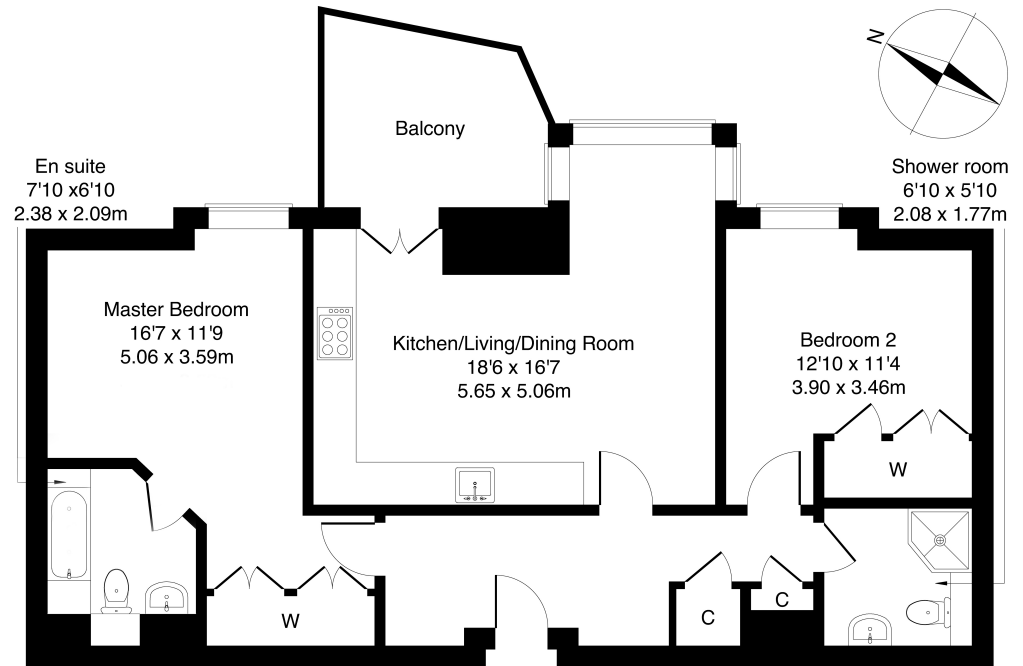

**Legal Disclaimer :** Floor-plan and measurements are for illustrative guidance only, and not intended to form part of any contract.

## Area Description





Leith is a vibrant and historic port district of Edinburgh, known for its maritime heritage and dynamic city atmosphere, offering a diverse range of boutique shops, artisan cafés, lively bars, restaurants, and supermarkets throughout. The nearby Shore boasts a cosmopolitan selection of bars, bistros, and Michelin-starred dining, while Ocean Terminal, the Omni Centre, and the recently redeveloped St James Quarter provide an array of high-street stores, eateries, gyms, and multi-

cinemas. Green spaces are abundant, with Leith Links, Pilrig Park, and the scenic Water of Leith Walkway all within easy reach. The area is popular with families, benefiting from several primary schools and secondary education at Leith Academy. Well connected by road via the A199 and A900, Leith also enjoys excellent public transport links, including regular bus services along Leith Walk and the new tram extension linking Edinburgh Airport to Newhaven.





## Our Services

-  Free pre-sale property valuations
-  Great value fixed estate agency fees
-  Extensive buyer matching database
-  Purchase and sale conveyancing

## Contact Us

0345 646 0208

[sales@mov8realestate.com](mailto:sales@mov8realestate.com)

[www.mov8.com](http://www.mov8.com)

## Head Office

6 Redheughs Rigg, Edinburgh, EH12 9DQ

## Glasgow Office

77 Renfrew Street, Glasgow, G2 3BZ



Estate Agents and Solicitors

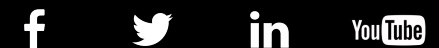

These particulars do not form part of any contract and the statements or plans contained herein are not warranted nor are they to scale. All descriptions, dimensions, areas, reference to condition and necessary permissions for use and occupation and other details are given in good faith, and are believed to be correct, but any prospective purchaser should not rely on them as statements or representations of fact, and any prospective purchaser must satisfy themselves by inspection or otherwise as to the correctness of each of them. The Seller shall not be bound to accept the highest or any offer nor to accept a full offer of the Fixed Price where this is applicable. Approximate measurements have been taken by sonic device and measurements are most often taken to the widest point of any room or space. Services and appliances have not been tested for efficiency or safety and no warranty is given as to their compliance with any Regulations. Offers should be made using the Combined Standard Clauses.