



## Henley Drive, FRIMLEY GREEN, Surrey GU16 6JT

PRICE £235,000 Leasehold

\* NO ONWARD CHAIN\* Jigsaw Estates are pleased to present to the market this beautifully presented first floor apartment situated in a cul-de-sac position on the popular Henley Drive development in Frimley Green.

The property is situated within walking distance of local shops and amenities as well as being a short distance from Frimley Park Hospital. The property also offers excellent transport links with Junction 4 of the M3 and local train stations all located within a short distance.

Accommodation comprises two bedrooms, large lounge/dining room and re-fitted kitchen. Further benefits include bathroom with a white suite, Upvc double glazing and gas central heating with a recently installed Glow Worm boiler. The property has also been re-decorated throughout and had new carpets. Outside to the rear there are communal gardens and to the front and side of the building there are parking areas. There is also a garage situated in a block.



- NO ONWARD CHAIN
- RE-FURBISHED THROUGHOUT
- GARAGE
- CLOSE TO LOCAL TRAIN STATIONS
- FIRST FLOOR
- NEW GAS BOILER
- COMMUNAL GARDENS
- CLOSE TO FRIMLEY PARK HOSPITAL

**FIRST FLOOR**  
946 sq.ft. (87.9 sq.m.) approx.

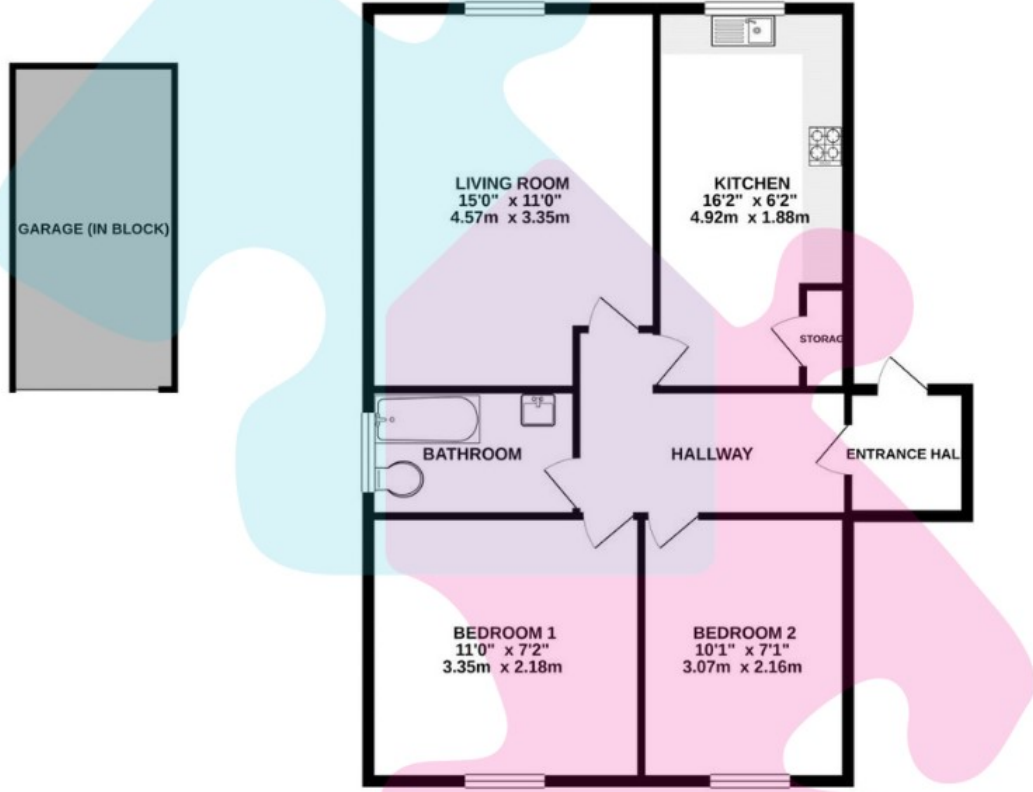

TOTAL FLOOR AREA: 946 sq ft. (87.9 sq m.) approx.  
While every attempt has been made to ensure the accuracy of the floorplan contained here, measurements of doors, windows, rooms and any other items are approximate and no responsibility is taken for any error, omission or mis-statement. This plan is for illustrative purposes only and should be used as such by any prospective purchaser. The services, systems and appliances shown have not been tested and no guarantee as to their operability or efficiency can be given.  
Made with Netplan ©2020

Energy Efficiency Rating		
	Current	Potential
Very energy efficient - lower running costs		
(92+) <b>A</b>		
(81-91) <b>B</b>		
(69-80) <b>C</b>	79	81
(55-68) <b>D</b>		
(39-54) <b>E</b>		
(21-38) <b>F</b>		
(1-20) <b>G</b>		
Not energy efficient - higher running costs		
England, Scotland & Wales		EU Directive 2002/91/EC

