





Wheeldon Avenue, Belper, Derbyshire DE56 1GX
£260,000 - Freehold



PROPERTY DESCRIPTION

Derbyshire properties are pleased to offer for sale this beautifully presented and designed detached chalet bungalow located on a small, low maintenance and easy to manage plot. We believe the property will make an ideal downsize for the potential purchaser and also would appeal to those with disabilities. Internally the property is presented to an extremely high standard With accommodation to the first and ground floor floors. The property briefly comprises of:- entrance hall, bedroom, lounge, bedroom, shower room and well appointed kitchen. To the first floor is a further double bedroom or potential use as a further living room with its own shower facility. Externally, the property offers a small low maintenance garden and parking for two vehicles. An internal viewing is essential to appreciate the accommodation in full.

POINTS OF INTEREST

- New Build Detached Chalet Bungalow
- 2/3 Bedrooms
- Versatile And Flexible Accommodation
- Ideal Down Size
- Ideal For Buyers With Disabilities
- No Chain
- Driveway & Low Maintenance Garden
- Two Shower Rooms
- View Absolutely Essential!

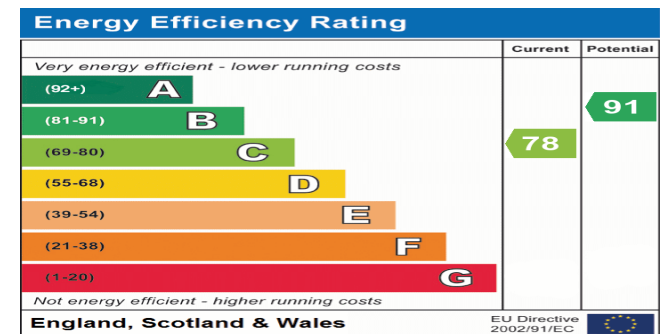

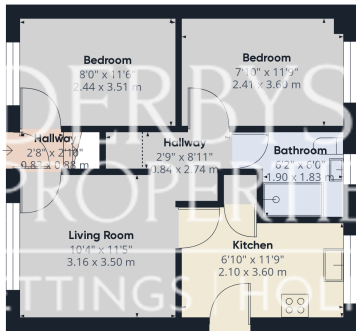

Ground Floor

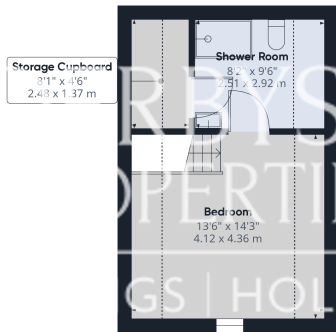

Floor 1

Approximate total area⁽¹⁾
782.33 ft²
72.68 m²

Reduced headroom
94.8 ft²
8.81 m²

(1) Excluding balconies and terraces

Reduced headroom
..... Below 5 ft/1.5 m

While every attempt has been made to ensure accuracy, all measurements are approximate, not to scale. This floor plan is for illustrative purposes only.

Calculations are based on RICS IPMS 3C standard.

GIRAFFE360

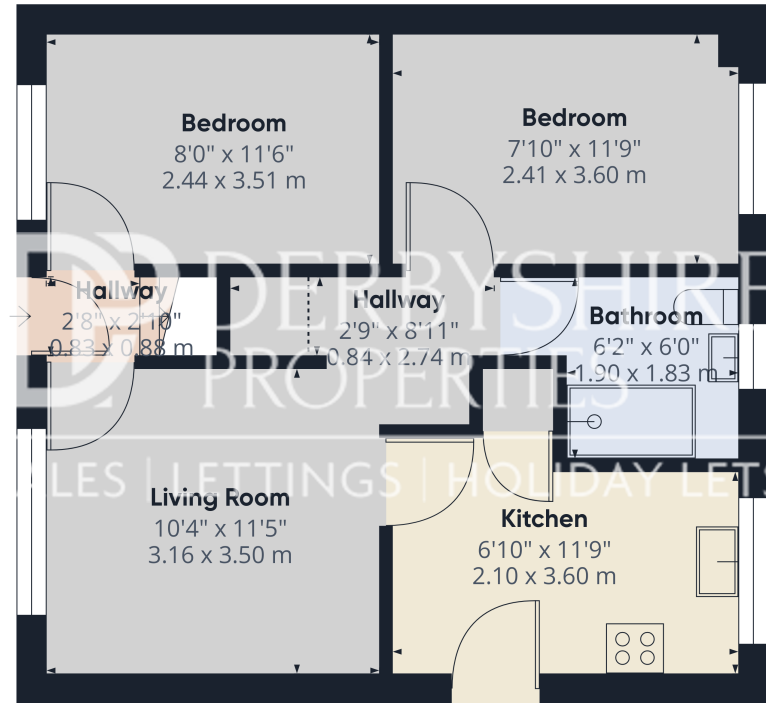

Ground Floor

Approximate total area⁽¹⁾
491.16 ft²
45.63 m²

Reduced headroom
6.9 ft²
0.64 m²

(1) Excluding balconies and terraces

Reduced headroom
..... Below 5 ft/1.5 m

While every attempt has been made to ensure accuracy, all measurements are approximate, not to scale. This floor plan is for illustrative purposes only.

Calculations are based on RICS IPMS 3C standard.

GIRAFFE360