



Day & Co
ESTATE AGENTS

28 Cavendish Street
Keighley
BD21 3RG



4 North View Terrace, Haworth,
Keighley, West Yorkshire, BD22
8HJ

£925 pcm

T: 01535 628989

W: www.dayandcoestateagents.co.uk

E: keighley@dayandcoestateagents.co.uk

- Four Double Bedrooms
- Accommodation Over 3 Floors
- Front Garden & Rear Yard
- Council Tax band A

- Spacious Through Terrace
- EPC Rating Is D
- Sought After Village Location Of Haworth
- Deposit £1065

SUMMARY

**** SPACIOUS 4 BEDROOM THROUGH TERRACE, SOUGHT AFTER HISTORIC VILLAGE LOCATION OF HAWORTH WITH EXCELLENT ACCESS TO VILLAGE AMENITIES & LOCAL SCHOOLS ****

FULL DESCRIPTION

Spacious four bedroom through terrace situated in the sought after historic village location of Haworth with excellent access to village amenities and local schools.

The three storey accommodation comprises of an entrance hall, the lounge with living flame gas coal effect fire, spacious dining kitchen with a range of base and wall mounted units, integrated oven and hob, and access to a useful storage cellar. To the first floor there are two double bedrooms, bathroom with three piece suite comprising of a bath with shower over, WC, wash hand basin and heated towel rail. To the second floor there are two further double bedrooms.

Externally there is a front garden and rear yard.

EPC rating is D.

Council Tax Banding is A.

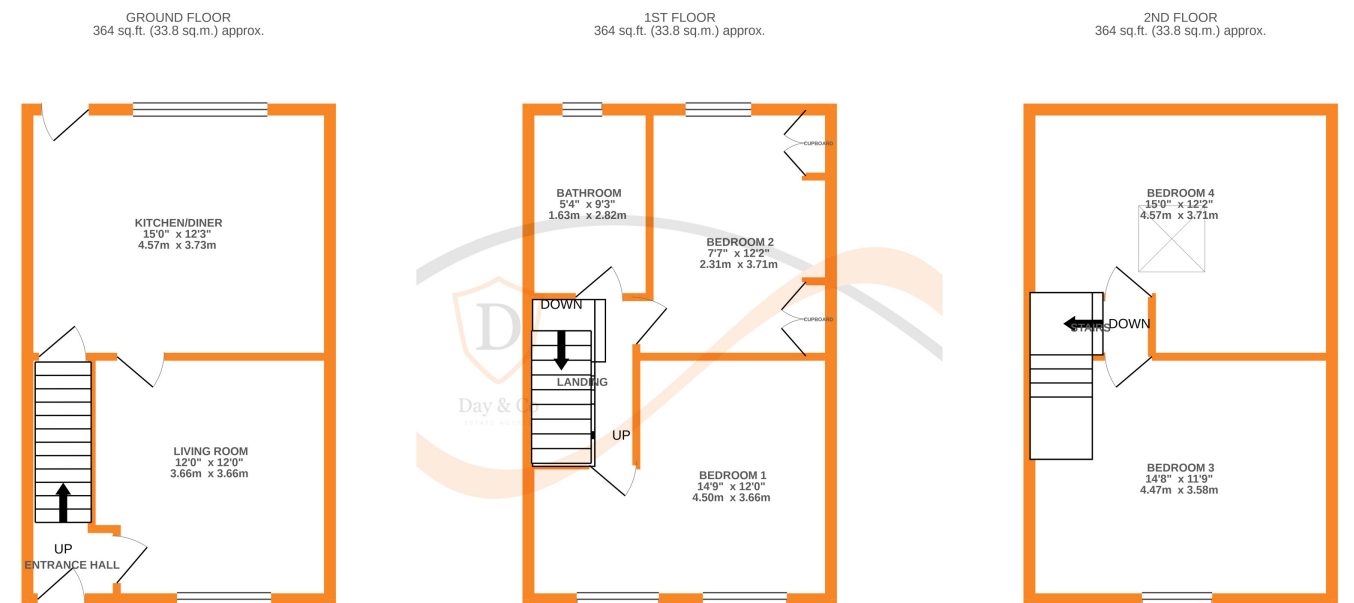

TOTAL FLOOR AREA: 1091 sq.ft. (101.3 sq.m.) approx.
 Whilst every attempt has been made to ensure the accuracy of the floorplan contained here, measurements of doors, windows, rooms and any other items are approximate and no responsibility is taken for any error, omission or mis-statement. This plan is for illustrative purposes only and should be used as such by any prospective purchaser. The services, systems and appliances shown have not been tested and no guarantee as to their operability or efficiency can be given.
 Made with Metropix ©2021