



9 Magherdonnagh, Port Erin, Isle of Man. IM9 6BY

Modern semi detached home with lovely open aspect to rear offered with no onward chain, ideal for first time buyers and investors.

Open House Saturday 26th July 12-2PM



£299,950 Freehold

PROPERTY DESCRIPTION

Manxmove Estate Agents are delighted to present 9 Magherdonnagh, Port Erin – a charming three-bedroom semi-detached home perfect for first-time buyers and investors alike. Nestled in a quiet residential location, this property offers superb countryside views to the rear, providing a tranquil backdrop to everyday living.

The spacious accommodation comprises a welcoming lounge, a separate dining room with French doors that open onto the garden, and a modern white kitchen ideal for family meals and entertaining. Upstairs, you'll find three bedrooms—two doubles and one single—along with a modern bathroom, making this home both functional and comfortable.

Additional features include a PIV (Positive Input Ventilation) system to ensure excellent air quality and large driveway for 3/4 vehicles.

Offered with no onward chain, 9 Magherdonnagh presents a fantastic opportunity to acquire a lovely home in a peaceful location.

FEATURES

- Open House Saturday 26th July 12-2PM
- Modern Semi Detached Home
- Quiet Residential Location
- Open Aspect to Rear
- Lounge plus Dining Room and Kitchen
- 3 Bedrooms plus Bathroom
- Large Driveway for Multiple Vehicles
- West Facing Rear Garden
- No Onward Chain



Property Images



FLOORPLAN



GROUND FLOOR
351 sq.ft. (32.6 sq.m.) approx.

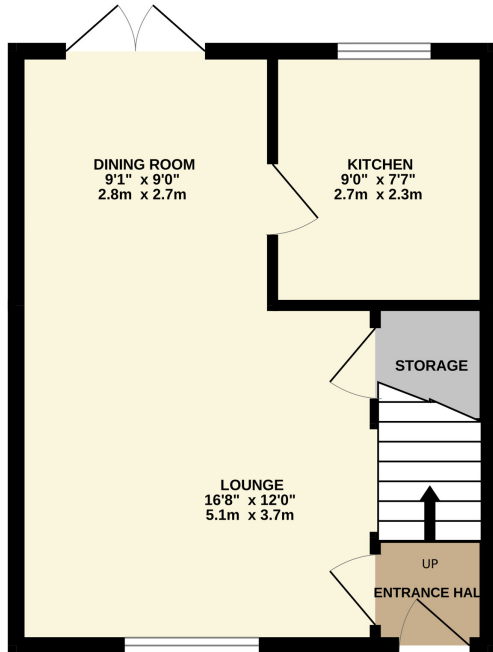

1ST FLOOR
358 sq.ft. (33.3 sq.m.) approx.

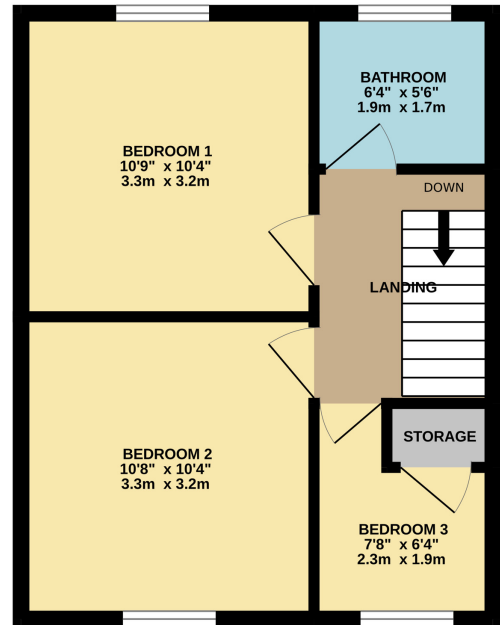

TOTAL FLOOR AREA : 709 sq.ft. (65.9 sq.m.) approx.

Whilst every attempt has been made to ensure the accuracy of the floorplan contained here, measurements of doors, windows, rooms and any other items are approximate and no responsibility is taken for any error, omission or mis-statement. This plan is for illustrative purposes only and should be used as such by any prospective purchaser. The services, systems and appliances shown have not been tested and no guarantee as to their operability or efficiency can be given.
Made with Metropix ©2025

DISCLAIMER: Whilst Manxmove Ltd believe that these details are correct, neither Manxmove Ltd or their clients guarantee their accuracy in any way. Consequently, these details are not to be used to form part of any legally binding contract. Prospective purchasers or tenants are advised to visit this property to satisfy themselves as to the correctness of these details. Please note, we use wide angle camera lenses in order to show as much of each room as possible. This is not intended to mislead any prospective purchasers or tenants in any way and an honest verbal description is always available prior to viewing if required.